



Land

808 m², Mělník, Býkev

€ 131 228 | CZK 3 200 000



SITUACE

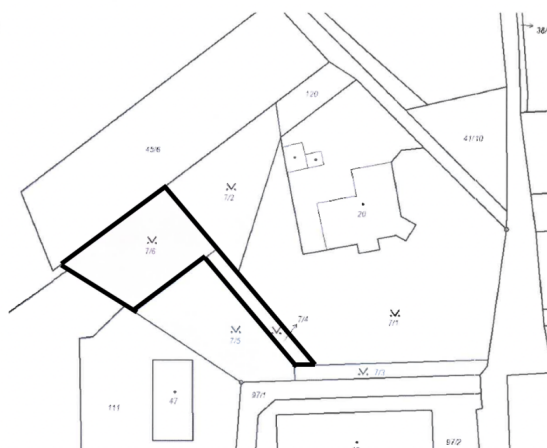



Land

808 m², Mělník, Býkev

€ 131 228 | CZK 3 200 000

| | |
|------------------|--------------------|
| Price per sq. m. | 3 960 CZK |
| Total area | 808 m ² |
| Land type | Housing |
| Reference number | 101153 |

This flat plot of land ideal for building a family house is located in a nice green area, a few minutes' drive from Mělník and less than half an hour from Prague.

Utility networks (pressure sewerage, water supply, electricity) are near the property on the main street. According to the zoning plan, it is possible to build a family house, the maximum buildability is 40%, and the maximum building level is 2 above-ground floors + attic.

The sunny plot is located on the site of a **former castle park**. A full range of services are in the nearby wine-growing town of Mělník, which can be reached from the village in a short time by bus or car. Driving to Prague is facilitated by the nearby D8 highway. The village is located near **Říp mountain** or the romantic **Kokořínsko area** with forests and rock formations; there is also a **swimming and fishing lake** not far from the property. There are routes for pedestrians, cyclists, and inline skaters.

Total area 808 m².

