

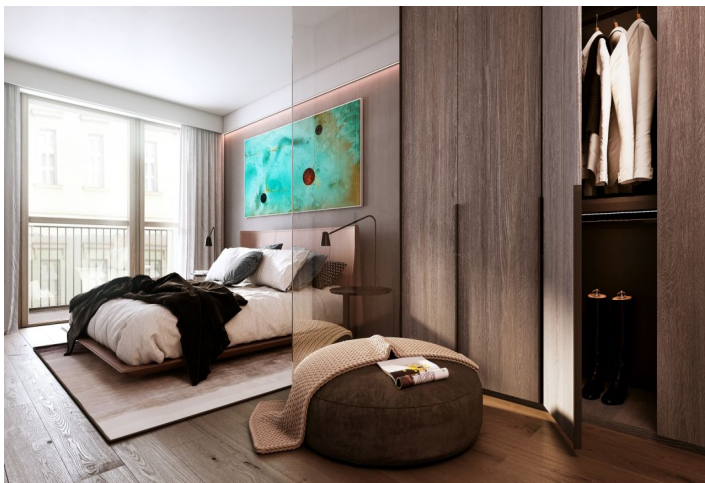

## Apartment Studio (1+kk)

30 m<sup>2</sup>, Ostrava-město

Sold





## Apartment Studio (1+kk)

**Sold**30 m<sup>2</sup>, Ostrava-město

Total area	30 m <sup>2</sup>
Parking	-
Cellar	Yes
PENB	B
Reference number	101863

This bright apartment is part of the unique Nové Lauby residential complex, a new project is being created right in the center of Ostrava near Masaryk Square with a fountain, within walking distance of a full range of services and a park. The estimated completion date is Q4 2023.

The layout consists of a living room with a preparation for a kitchen, a bathroom with a toilet, and a foyer. The apartment has a cellar.

The project was designed by the renowned **Znamení čtyř - architekti studio**. The new five-story building will be covered with **greenery**, and a **landscaped atrium** will be created in the complex's center. The interior is illuminated by large-format windows with aluminum or wooden frames and the standard of equipment is offered in two options. There is a possibility to buy a **parking space**.

Floor area 30.13 m<sup>2</sup>, cellar 1.98 m<sup>2</sup>.

The visualizations are of an illustrative nature only.

For more information about the project, visit the website [www.novelauby.cz](http://www.novelauby.cz)

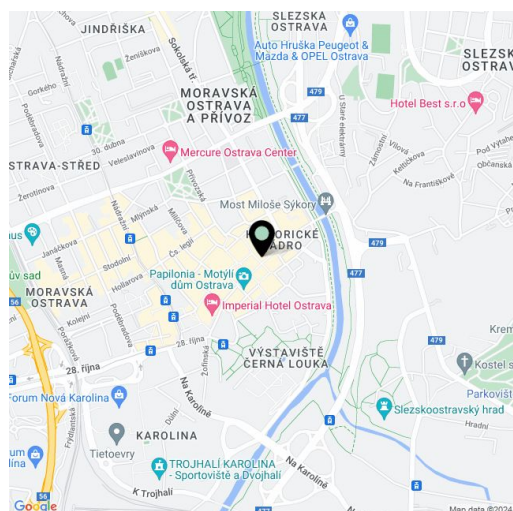

\* Area of the unit according to the Civil Code. The area consists of the sum total area of the entire unit bounded by perimeter walls.



# Apartment Studio (1+kk)

30 m<sup>2</sup>, Ostrava-město

Sold

## Nové Lauby

Byt 2.E.04

Dispozice	1+kk
Podlaží	2.NP
Vstup z ulice	Dlouhá
1 Zádveří	4,10 m <sup>2</sup>
2 Obýv. pokoj s kuch. koutkem	19,78 m <sup>2</sup>
3 Koupelna s WC	3,28 m <sup>2</sup>
Užitná plocha	27,13 m <sup>2</sup>
Podlahová plocha	30,13 m <sup>2</sup>

Exkluzivní zastoupení  
svoboda&williams | CHRISTIE'S  
INTERNATIONAL REAL ESTATE

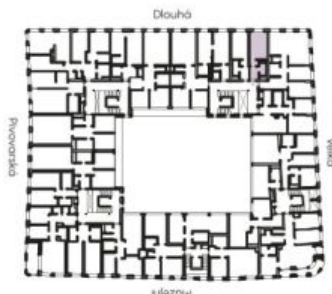

\*Přípatk Nové Lauby se vyznačuje prvky pro zprávy, včetně rozvaděče a referenční jazykové komunikace. Součástí každé místnosti jsou i velmi rodinné. Celková plocha bytu je včetně přední plochy a vnitřních nomeny 30,13 m<sup>2</sup>. (2013) 30.

[www.novelaubby.cz](http://www.novelaubby.cz)

info@novelaubby.cz  
+420 724 551 238

