

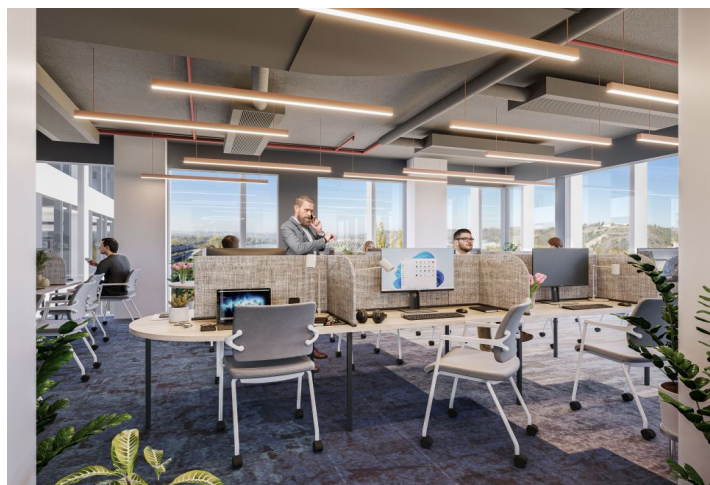

# Office building

€ 30.00 - 35.00 / m<sup>2</sup> | CZK 754 - 879 / m<sup>2</sup>

4 803 m<sup>2</sup>, Prague 7, Holešovice, Partyzánská





## Office building

€ 30.00 - 35.00 / m<sup>2</sup> | CZK 754 - 879 / m<sup>2</sup>

4 803 m<sup>2</sup>, Prague 7, Holešovice, Partyzánská

Total building area	4 803 m <sup>2</sup>
Tenant consumption	—
Parking	—
Parking service charges	—
Parking ratio	—
Certification	—
PENB	B
Reference number	102777

The inspirational working environment at the Holešovice riverbank harbor will provide you with facilities within shared offices for both individuals and entire teams.

Private offices, hot desks in a **coworking space**, or even your own Office Suite. The **conference center**, accommodating up to 350 people, will provide excellent facilities for your events. All of these options can be offered to you within shared offices in a modern office building.

The campus-style office complex was constructed with consideration for the environment, creating a unique setting for a healthy balance between work and personal life. In the immediate vicinity, a vibrant new riverbank is emerging, offering a variety of leisure activities.

### Location:

Excellent transportation accessibility by both car and public transport - in the immediate proximity of the building, there are bus and tram stops. The Holešovice train station and **Nádraží Holešovice metro station (Line C)** are in close vicinity, thanks to a newly built underpass directly from the Nádraží Holešovice metro station.

### Shared offices facilities and services:

- Daily reception
- Mail and packages reception
- Accepting phone calls
- Business manager services
- Services of a head chef
- Private café
- Equipped private offices
- Company headquarters registration and virtual office
- Shared meeting and conference rooms
- Event space for up to 250 persons
- Call boxes
- Lounge and shared areas
- Fully equipped kitchenettes
- Printers and copy center
- High-speed Internet
- IT help

### Equipment and building standards:

- LEED Platinum and WELL Gold certifications
- 24/7 security service
- Magnetic cards access
- Terrace on the roof of the building
- Air conditioning

**Office building****€ 30.00 - 35.00 / m<sup>2</sup> | CZK 754 - 879 / m<sup>2</sup>**4 803 m<sup>2</sup>, Prague 7, Holešovice, Partyzánská

---

**Total building area** 4 803 m<sup>2</sup>

---

**Tenant consumption** —

---

**Parking** -

---

**Parking service charges** —

---

**Parking ratio** —

---

**Certification** —

---

**PENB** B

---

**Reference number** 102777

---

Sufficient daylight

Suspended ceilings

Raised floors

Storage areas, showers and dressing rooms

Restaurant right in the building

Parking in underground garages

Rental and service charges listed without VAT. Lessee pays no commission.