



## Warehouse space

16 173 m<sup>2</sup>, Praha-východ, Dobřejšovice

Ask for price





## Warehouse space

16 173 m<sup>2</sup>, Praha-východ, Dobřejovice

**Ask for price**

<b>Total area</b>	16 173 m <sup>2</sup>
<b>Available area for rent</b>	16 173 m <sup>2</sup>
<b>Ceiling height</b>	10 m
<b>Floor loading capacity</b>	5 t/m <sup>2</sup>
<b>Column grid structure</b>	—
<b>Structure</b>	Reinforced concrete structure
<b>PENB</b>	C
<b>Reference number</b>	103185

**14,466 sq.m.** of warehouse (**1,351 sq.m.** mezzanin) and **356 sq.m.** of office space for lease in the immediate vicinity of the D1 motorway. The premises are suitable for logistics, distribution, warehousing and light production.

### Location:

The complex is located at the intersection of the D1 motorway and the Prague ring road.

### Features and Services:

- Flexible units (storage / office / light production / showroom)
- Dedicated property management team
- Technical support on site
- Ample parking spaces
- CCTV

### Industrial/Warehouse space:

- Floor loading capacity 5 T/sq.m
- Clear height 10 m
- Wide manoeuvring truck court
- 15 x Loading docks
- Drive-in doors
- External LED lighting
- Column grid structure 12 x 23 m
- ESFR sprinkler system

### Office:

- Office space according to client requirements

**Available from 5/2026.**

Lessee pays no commission.

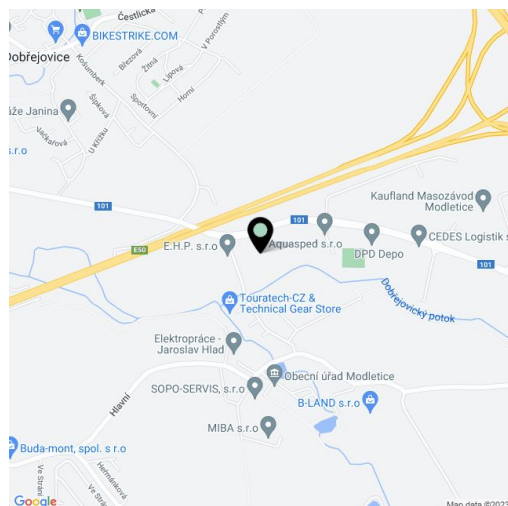





# Warehouse space

16 173 m<sup>2</sup>, Praha-východ, Dobřejšovice

Ask for price

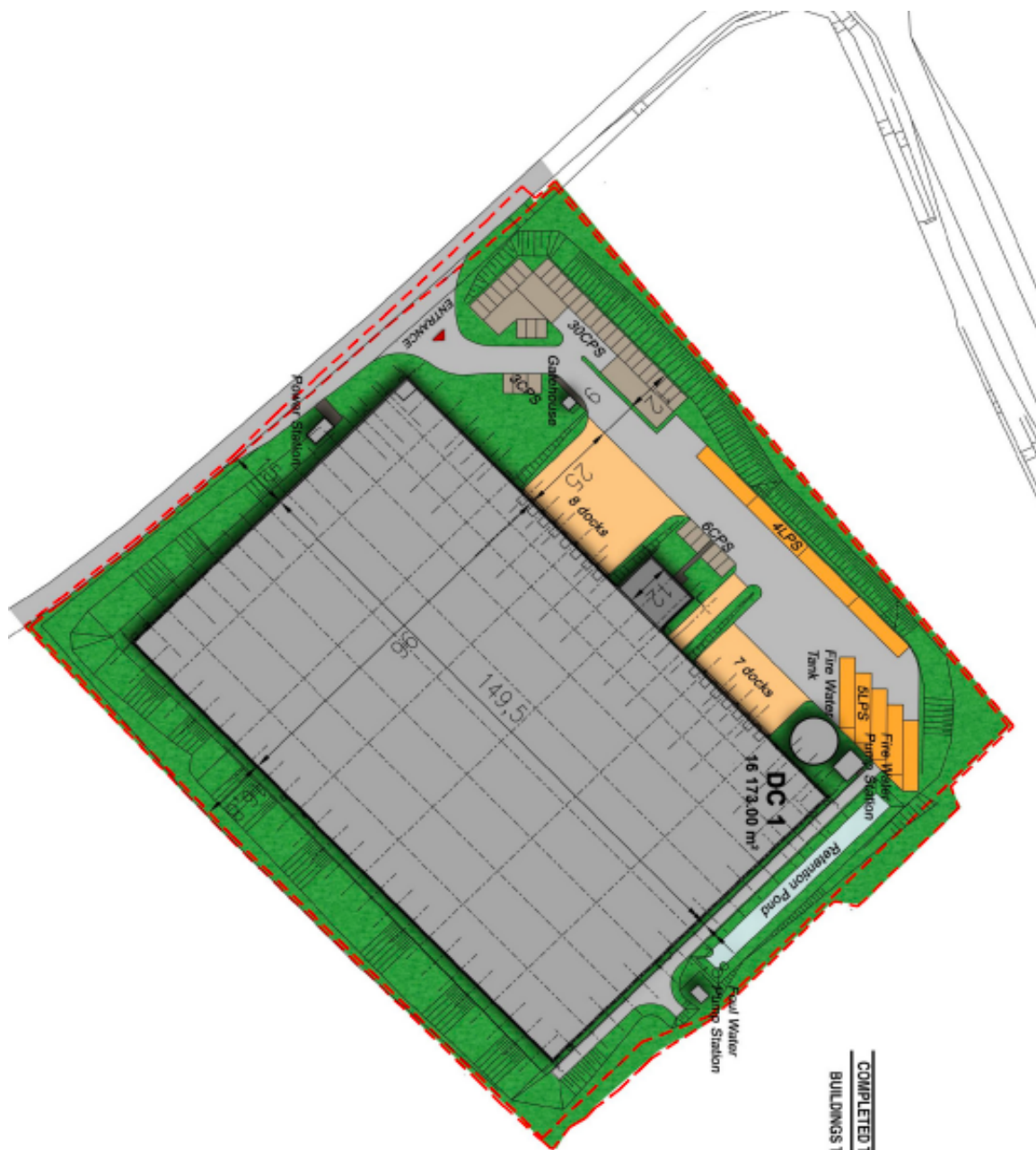

Completed Buildings		
	DC 1	
Leasable Floor Area	16 173,00 m <sup>2</sup>	
Docks	15	
Drive-in Gates	1	
<b>COMPLETED TOTAL</b>	<b>16 173,00 m<sup>2</sup></b>	
<b>BUILDINGS TOTAL</b>	<b>16 173,00 m<sup>2</sup></b>	