



Industrial park

16 173 m², Praha-východ, Dobřejšovice

Ask for price





Industrial park

16 173 m², Praha-východ, Dobřejovice

Ask for price

Total area	16 173 m ²
Available area for rent	16 173 m ²
Ceiling height	10 m
Floor loading capacity	5 t/m ²
Column grid structure	—
Structure	Reinforced concrete structure
PENB	C
Reference number	103186

The industrial area offers warehouse, production and office space for lease in the immediate vicinity of the D1 motorway. The premises are suitable for logistics, distribution, warehousing and light production.

Location:

The complex is located at the intersection of the D1 motorway and the Prague ring road.

Features and Services:

- Flexible units (storage / office / light production / showroom)
- Dedicated property management team
- Technical support on site
- Ample parking spaces
- CCTV

Industrial/Warehouse space:

- Floor loading capacity 5 T/sq.m
- Clear height 10 m
- Wide manoeuvring truck court
- 15 x Loading docks
- Drive-in doors
- External LED lighting
- Column grid structure 12 x 23 m
- ESFR sprinkler system

Office:

- Office space according to client requirements

Lessee pays no commission.

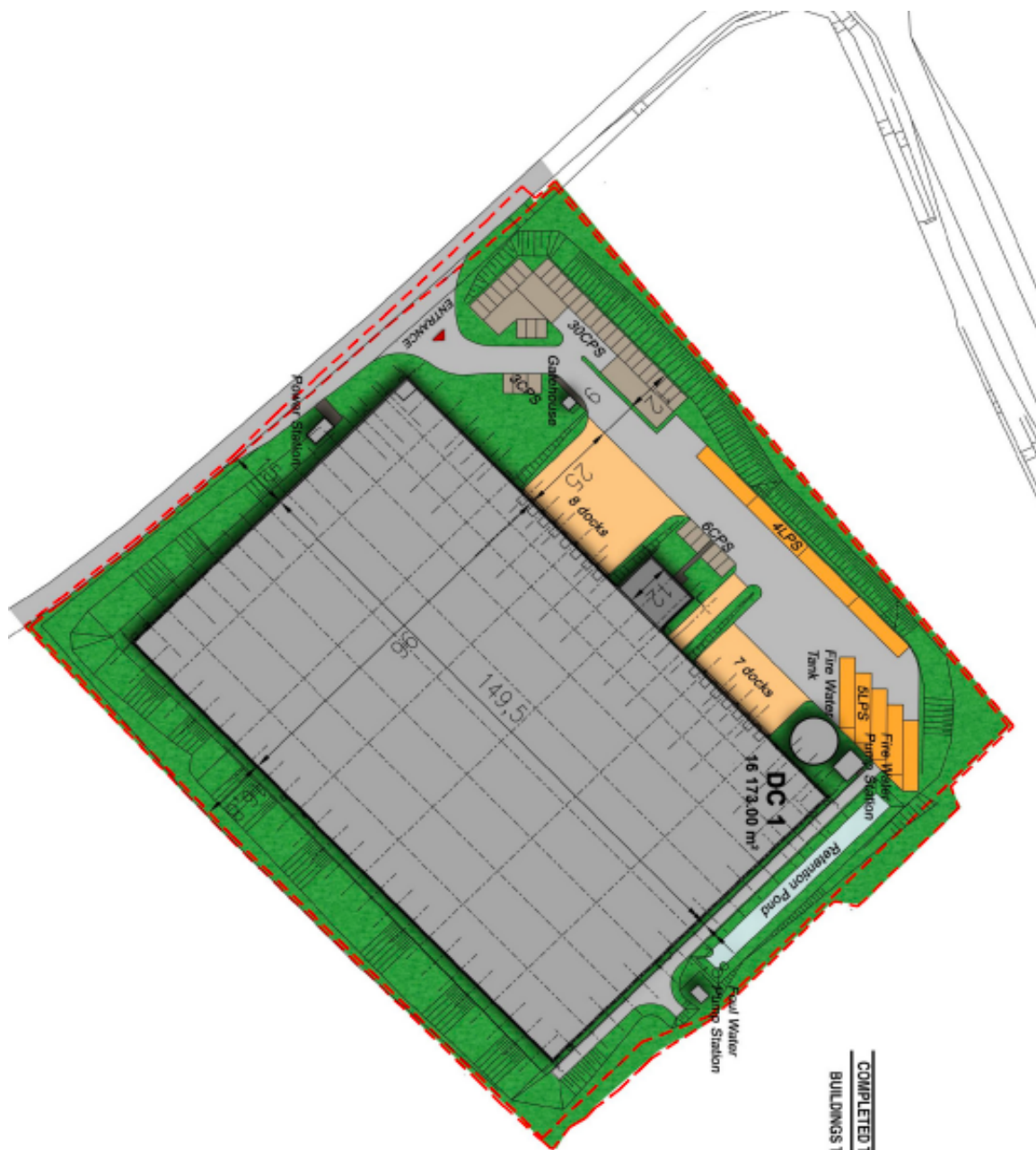

Completed Buildings		
	DC 1	
Leasable Floor Area	16 173.00 m ²	
Docks	15	
Drive-in Gates	1	
COMPLETED TOTAL	16 173.00 m²	
BUILDINGS TOTAL	16 173.00 m²	