



Apartment Two-bedroom (3+kk)

€ 4 346 | CZK 109 900

166 m², Praha 5, Smíchov, Janáčkovo nábřeží





Apartment Two-bedroom (3+kk)

€ 4 346 | CZK 109 900

166 m², Praha 5, Smíchov, Janáčkovo nábřeží

Total area	174 m ²
Floor area*	166 m ²
Balcony	8 m ²
Parking	Garage parking.
Garage	Yes
Cellar	Yes
Service price	Monthly deposit for services, water, and heating: CZK 15,660. Electricity is billed separately.
PENB	G
Reference number	103241
Available from	Immediately

High-standard riverfront apartment with parking. This completely refurbished unfurnished apartment with a balcony and 2 bathrooms is situated on the 4th floor of a historic apartment building that has been meticulously renovated, and offers a sauna, 24/7 security, camera system, and an elevator. Centrally located on a tree-lined street right on the Vltava riverbank, within walking distance of Kampa Island, Petřín Hill Park, Malá Strana (Lesser Town), and Old Town. The neighborhood has easy access to the Prague Castle, the Anděl commercial center and metro station, and the French School.

The interior features a living room with a fully fitted open plan kitchen and dining area, a master bedroom with an en-suite bathroom (walk-in shower, bidet, toilet) and a **balcony** facing the quiet courtyard, a bedroom with an en-suite bathroom (walk-in shower, toilet), a utility room, a guest toilet, and an open entrance area with built-in storage.

Air-conditioning, oak parquet floors, large-format tiles, security entry door, roller blinds, washer, dryer, dishwasher, induction cooktop, microwave oven, video entry phone, cellar, charger for electric cars. A garage parking space is available at CZK 10,000/month + VAT.

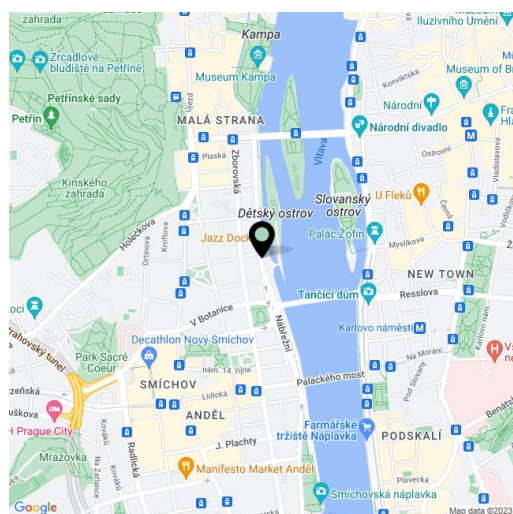

* Size of the unit according to the Housing Act.

The area consists of the sum total of the internal area of every room.



Apartment Two-bedroom (3+kk)

€ 4 346 | CZK 109 900

166 m², Praha 5, Smíchov, Janáčkovo nábřeží

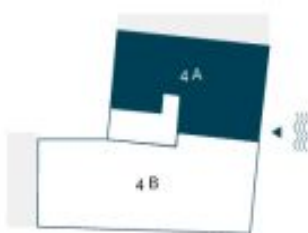

Celková výměra bytu	173 m ²
Předsíň	27 m ²
Obývací pokoj	50 m ²
Kuchyň + jídelna	26 m ²
Pokoj	23 m ²
Koupelna + WC	6 m ²
Pokoj	22 m ²
Koupelna + WC	5 m ²
WC	2 m ²
Technická místnost	4 m ²
Lodžie	8 m ²