

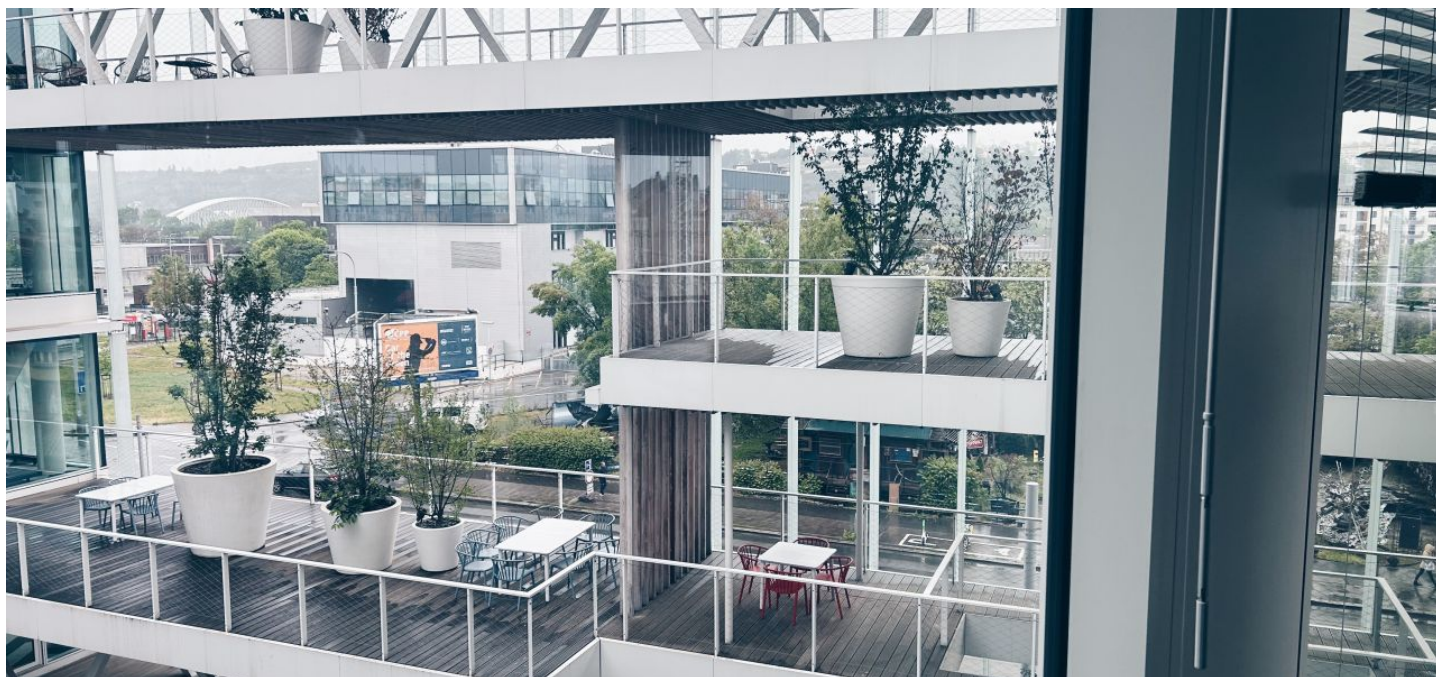

Office space

Praha 7, Holešovice, Plynární

Rented



**Office space****Rented**

Praha 7, Holešovice, Plynární

Service price	134 CZK monthly per m ²
Available area	1 848 m ²
Cellar	-
Parking	EUR 130 / ps / month
PENB	B
Reference number	103474

Office space or lease on the 3rd floor in a new complex of two connected buildings situated in an attractive location of Prague 7; designed by the renowned czech architect Jakub Cígler. The complex has a large garden with possibility of sport activities and open-air cinema, relaxation zone, terraces with beautiful view and running track on the roof. Possible to split up to 4 units.

Location:

Excellent transport accessibility – in the immediate vicinity of bus and tram stops; train station and metro station Nádraží Holešovice (line C) is only a 2-minute walk away. Easy access to the city circle, connected to the south and western part of Prague via the Blanka Tunnel. The popular Stromovka Park is near the building (10 minutes on foot).

Features and services:

- LEED Platinum certification
- Large and bright floorplans suitable for SSC (share service center) operations
- Raised floors
- Sprinklers
- Air conditioning and ventilation through cooling beams
- Heating through radiators
- Central reception desk
- 24 hours security and monitoring
- 6 high-speed elevators
- Card access system
- Modern building management system
- Restaurant and kindergarten in the building
- Beautiful garden and outside sport facilities
- Underground parking

Images might not accurately reflect the current state of the premises.

Rental and service charges listed without VAT. Lessee pays no commission.

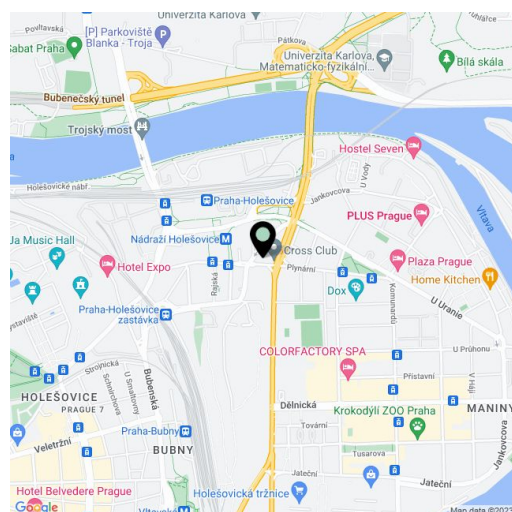



Office space

Praha 7, Holešovice, Plynární

Rented

