

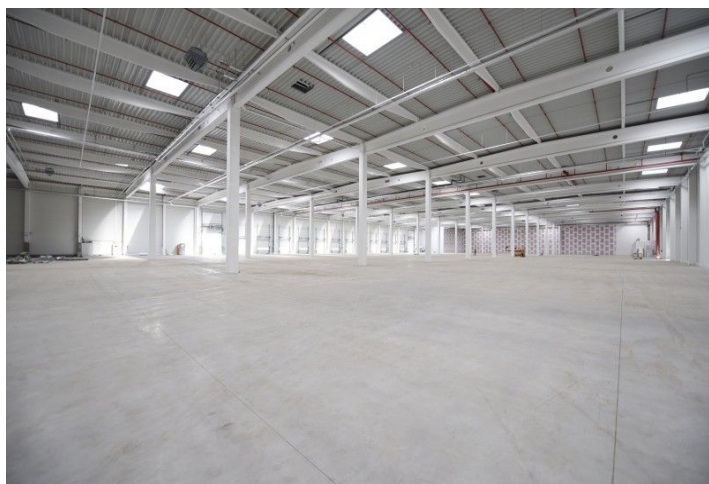

## Warehouse space

2 619 m<sup>2</sup>, Ostrava-město, Ostrava, Halasova

Ask for price





## Warehouse space

2 619 m<sup>2</sup>, Ostrava-město, Ostrava, Halasova

[Ask for price](#)

<b>Total area</b>	2 619 m <sup>2</sup>
<b>Available area for rent</b>	2 619 m <sup>2</sup>
<b>Ceiling height</b>	10 m
<b>Floor loading capacity</b>	5 t/m <sup>2</sup>
<b>Column grid structure</b>	—
<b>Structure</b>	Reinforced concrete structure
<b>PENB</b>	B
<b>Reference number</b>	104235

**2,619 sq.m.** of warehouse and office space including background for lease in an area located in Ostrava - Vítkovice. After a demanding rehabilitation, the 44ha brownfield is ready for the construction of a modern commercial-industrial park. The tenants of the park have at their disposal premises of various sizes suitable for companies operating in a wide range of commercial and production act.

### Location:

The park is located in the wider center of Ostrava in the area of Ostrava Vítkovice with excellent transport accessibility. Direct connection to the highway leading to Brno and Poland. There are 3 entrances to the park. There is a tram stop near the complex.

### Features and Services:

- All infrastructure available on site
- High standards of buildings
- A functional railway along the eastern perimeter of the compound
- A large number of parking spaces for cars and trucks

### Industrial/Warehouse space:

- Flexible unit layouts
- Variable units from 1,500 sq.m.
- 1 drive-in
- 9 docks with loading bridge
- Floor load: 5t/sq.m.
- Clear height of storage areas: 10-12 m
- Column module: 24 × 12 m
- Loading yard: 35 m
- Sprinklersystem
- Infrared emitters /ceiling heating units
- BREEAM Very Good

### Office:

- Flexible office layout
- Air-conditioning

Rental and service charges listed without VAT. Lessee pays no commission.

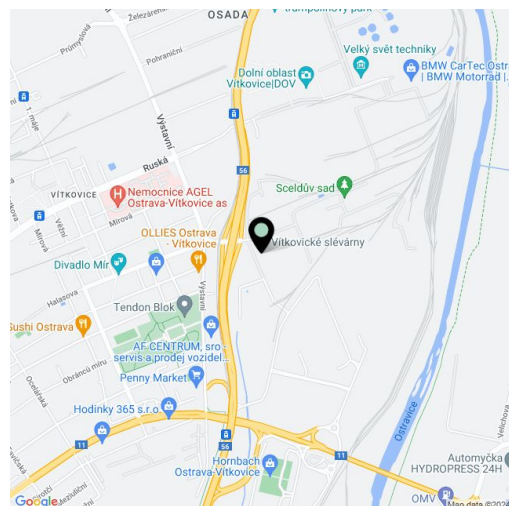



# Warehouse space

2 619 m<sup>2</sup>, Ostrava-město, Ostrava, Halasova

Ask for price

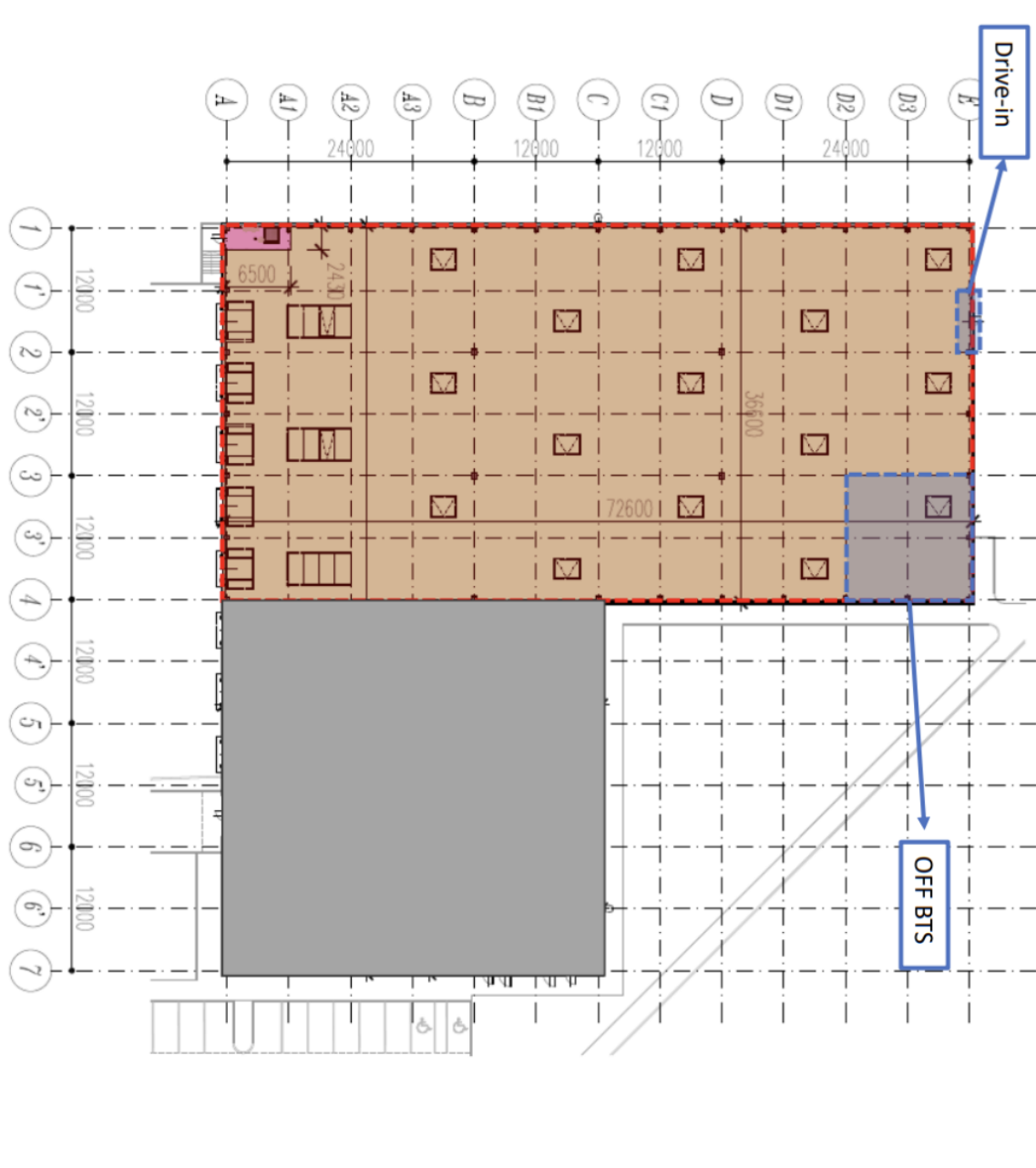



## Warehouse space

2 619 m<sup>2</sup>, Ostrava-město, Ostrava, Halasova

Ask for price

**WH**  
**2 619 m<sup>2</sup>**  
**OFF**  
**can be built to suit**

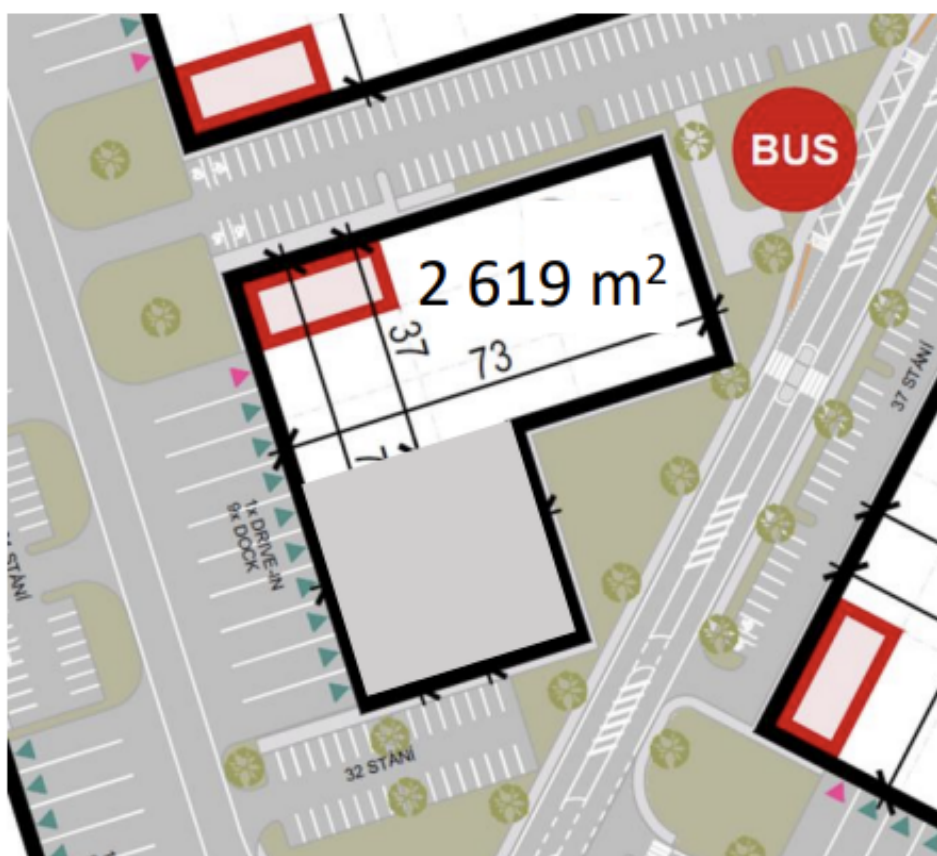

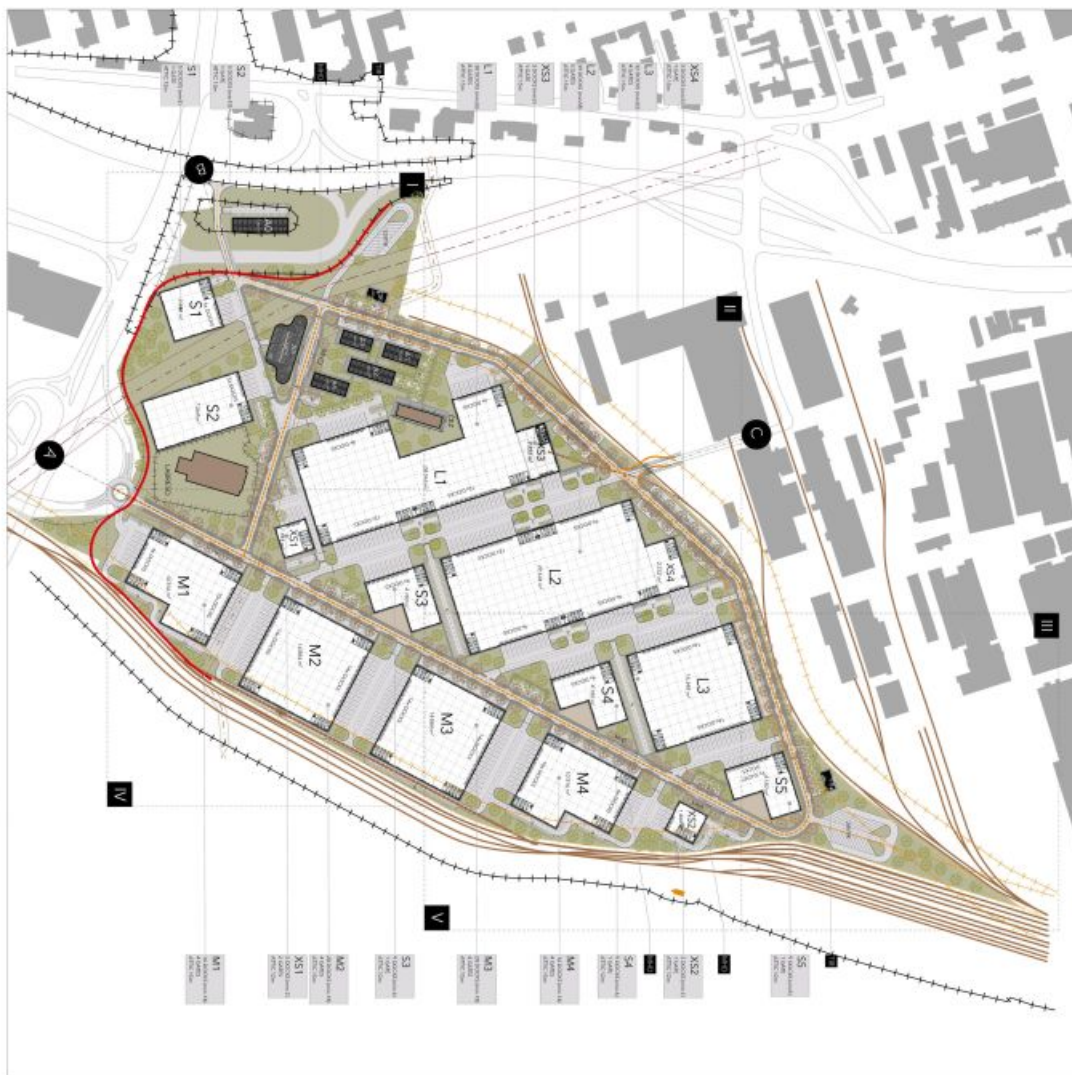

**LEGENDA**

- OR - KOMUNIKACE - HLAVNÍ TRASY
- OR - KOMUNIKACE - HLAVNÍ TRASY
- OR - KOMUNIKACE - POKROKOVÉ PŘECHODY
- OR - PLYNOVODNÁ ČISTOTA
- OR - TRÁVA/ODVÁLNÁ
- KOLEJE
- OR VERTIKÁLNÍ
- OR SÍŇNICE
- OR - SÍŇNICE 30M
- OR - SÍŇNICE 30M
- OR - VÝHLED
- OR KANALIZACE 2M
- ZALIVOVÉ ÚZEMÍ
- NAVÝŠENÁ TERÉNNÍ ČISTOTA
- NAVÝŠENÁ TERÉNNÍ ČISTOTA
- STŘEŠNÍ FLODY
- 20000
- ZÁMĚROVÁNÍ ÚZEMÍ - PŘÍRODNÍ VÝSTĚH
- STŘEŠNÍ PLOCHY (KAPKOVÉ, FAKTICKÉ KAMENKACE)
- STŘEŠNÍ - BEZDÍ SKL, JINAK GÁL. ÚVA. NAPOJENÉ KANALIZ. ÚP.

Stavba	Objem	Podlahová plocha	Podlahová plocha	Podlahová plocha	Podlahová plocha	Podlahová plocha	Podlahová plocha	Podlahová plocha	Podlahová plocha	Podlahová plocha
LI	28 510	24 464	4 032	7	1 462	2 280	30	8	161	242
L2	29 531	25 497	4 034	7	1 462	2 280	30	8	161	242
L3	14 436	14 136	3 204	4	829	1 425	32	4	128	196
L4	18 511	18 212	3 294	4	829	1 425	32	4	128	196
M1	14 484	13 180	2 304	4	829	1 425	32	4	128	196
M2	14 484	13 180	2 304	4	829	1 425	32	4	128	196
M3	18 511	18 212	3 294	4	829	1 425	32	4	128	196
M4	18 511	18 212	3 294	4	829	1 425	32	4	128	196
S1	7 504	6 081	1 511	3	207	349	5	1	43	32
S2	4 480	3 058	1 511	3	207	349	5	1	43	32
S3	4 480	3 058	1 511	3	207	349	5	1	43	32
S4	4 480	3 058	1 511	3	207	349	5	1	43	32
S5	4 480	3 058	1 511	3	207	349	5	1	43	32
CS1	1 444	649	519	1	207	349	5	1	43	32
CS2	1 444	649	519	1	207	349	5	1	43	32
CS3	2 202	1 044	818	1	207	349	5	1	43	32
CS4	2 202	1 044	818	1	207	349	5	1	43	32
<b>CELKEM</b>	<b>138 510</b>	<b>125 810</b>	<b>28 218</b>	<b>43</b>	<b>9 718</b>	<b>17 680</b>	<b>306</b>	<b>43</b>	<b>1 718</b>	<b>1 588</b>

**Summary:**  
 Objem: 4 434 m³  
 Podlahová plocha: 2 619 m²  
 Výška: 4 170 m  
 Podlaží: 388



## Warehouse space

2 619 m<sup>2</sup>, Ostrava-město, Ostrava, Halasova

Ask for price



Budova	Zastavěná plocha m <sup>2</sup>
L1	28 516
L2	29 524
L3	16 438
M1	10 516
M2	14 884
M3	14 884
M4	10 516
S1	3844
S2	7564
S3	4180
S4	4180
S5	4180
XSI	1444
XSI	1444
XSI	1444
<b>Celkem</b>	<b>152 114</b>