



## Apartment One-bedroom (2+kk)

Rented

55.66 m<sup>2</sup>, Praha 10, Uhřetěves, Karla Guta





## Apartment One-bedroom (2+kk)

**Rented**55.66 m<sup>2</sup>, Praha 10, Uhříněves, Karla Guta

Total area	58 m <sup>2</sup>
Floor area*	56 m <sup>2</sup>
Terrace	3 m <sup>2</sup>
Parking	Garage parking.
Garage	Yes
Cellar	Yes
Service price	Monthly deposit for services, water, and heating: CZK 4,000 for one person, CZK 5,000 for 2 persons. Electricity is billed separately.
PENB	B
Reference number	104486
Available from	Immediately

This brand new unfurnished apartment with a terrace is situated on the 4th topmost floor of a newly built residential building with an elevator and parking, in the quiet and green residential neighborhood of Uhříněves, Prague 10. A location with very good amenities and plenty of sports and cultural opportunities, with several ponds nearby. An area with great transportation connections - 20 min. by train to the Prague Main Railway Station, 15 minutes by bus to the Háje metro station (line C), and a short drive to the D1 highway.

The apartment includes a living room with a fully fitted open plan kitchen, dining area, and terrace, a bedroom also with access to the terrace, a bathroom with a bathtub and toilet, a storage closet, and an entrance hall.

Vinyl floors, tiles central heating, dishwasher, cellar. A garage parking space is included. Available from June 1st, 2024.

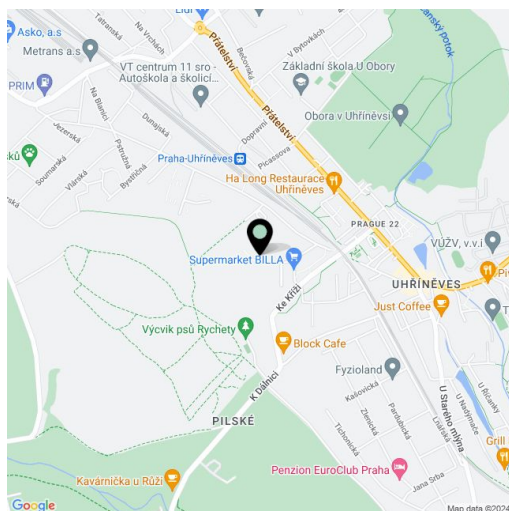

\* Area of the unit according to the Civil Code. The area consists of the sum total area of the entire unit bounded by perimeter walls.



# Apartment One-bedroom (2+kk)

Rented

55.66 m<sup>2</sup>, Praha 10, Uhříněves, Karla Guta

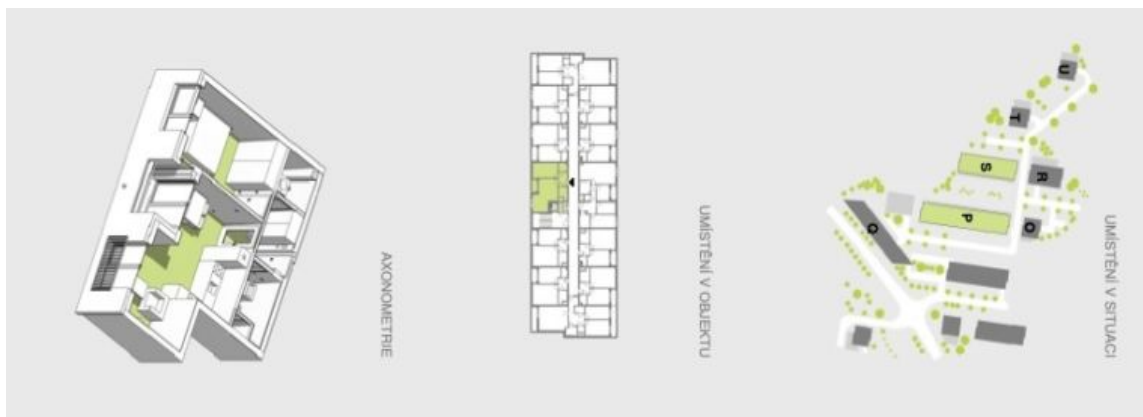

## UHŘÍNĚVES V



1	Předstř.	4,95 m <sup>2</sup>
2	Koupelna + WC	4,33 m <sup>2</sup>
3	Obývací pokoj + kk	25,08 m <sup>2</sup>
4	Ložnice	15,55 m <sup>2</sup>
5	Komora	3,08 m <sup>2</sup>
Plocha místnosti celkem:		52,99 m <sup>2</sup>
Ostatní plochy		2,67 m <sup>2</sup>
<b>Plocha bytu celkem</b>		<b>55,66 m<sup>2</sup></b>
6	Terasa	2,67 m <sup>2</sup>
25	Uložná komora	1,84 m <sup>2</sup>