



Warehouse space

1 467 m², Praha 5, Zličín, Na Radosti

Ask for price





Warehouse space

1 467 m², Praha 5, Zličín, Na Radosti

Ask for price

Total area	1 467 m ²
Available area for rent	354 m ²
Ceiling height	8 m
Floor loading capacity	—
Column grid structure	—
Structure	Reinforced concrete structure
PENB	C
Reference number	105279

1,113 sq.m. of warehouse and **354 sq.m.** of office premises in a Business Park situated in Prague 5. The project consists of 5 industrial, warehouse and office buildings; there are 2 entrances with the gatehouse.

Location:

Project is located 450m from Exit "na Radosti" – direct connection to Prague Ring Road (R1) and D5 highway to Germany. Excellent access to the airport Prague Václav Havel Airport – cca 5km (10 minutes by car). Zličín Business Centre (line B) and Metropole Zličín shopping mall is 550 m from areal.

Features and Services:

- Flexible units (Storage / Office / Light Production / Showroom)
- On-site property management
- 24/7 manned security and CCTV
- Park maintenance

Industrial premises/ Warehouse:

- 2 loading docks per 600 sq.m
- Building depth 55 m
- Lighting 200 Lux
- Clear height 8 m

Office:

- Turn key office
- Lighting 500 Lux
- Air Conditioning

Available from 10/2025.

Rental and service charges listed without VAT. Lessee pays no commission.

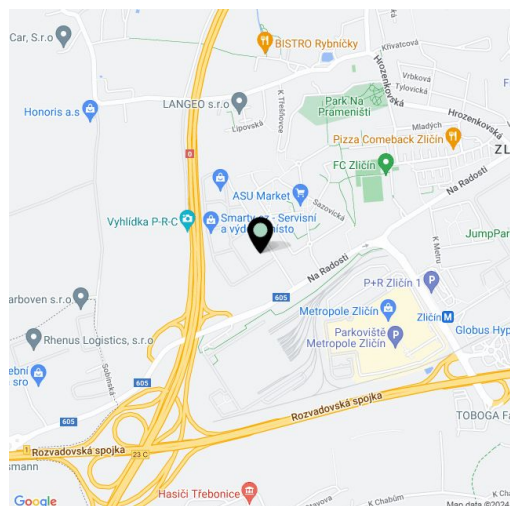



Warehouse space

Ask for price

1 467 m², Praha 5, Zličín, Na Radosti

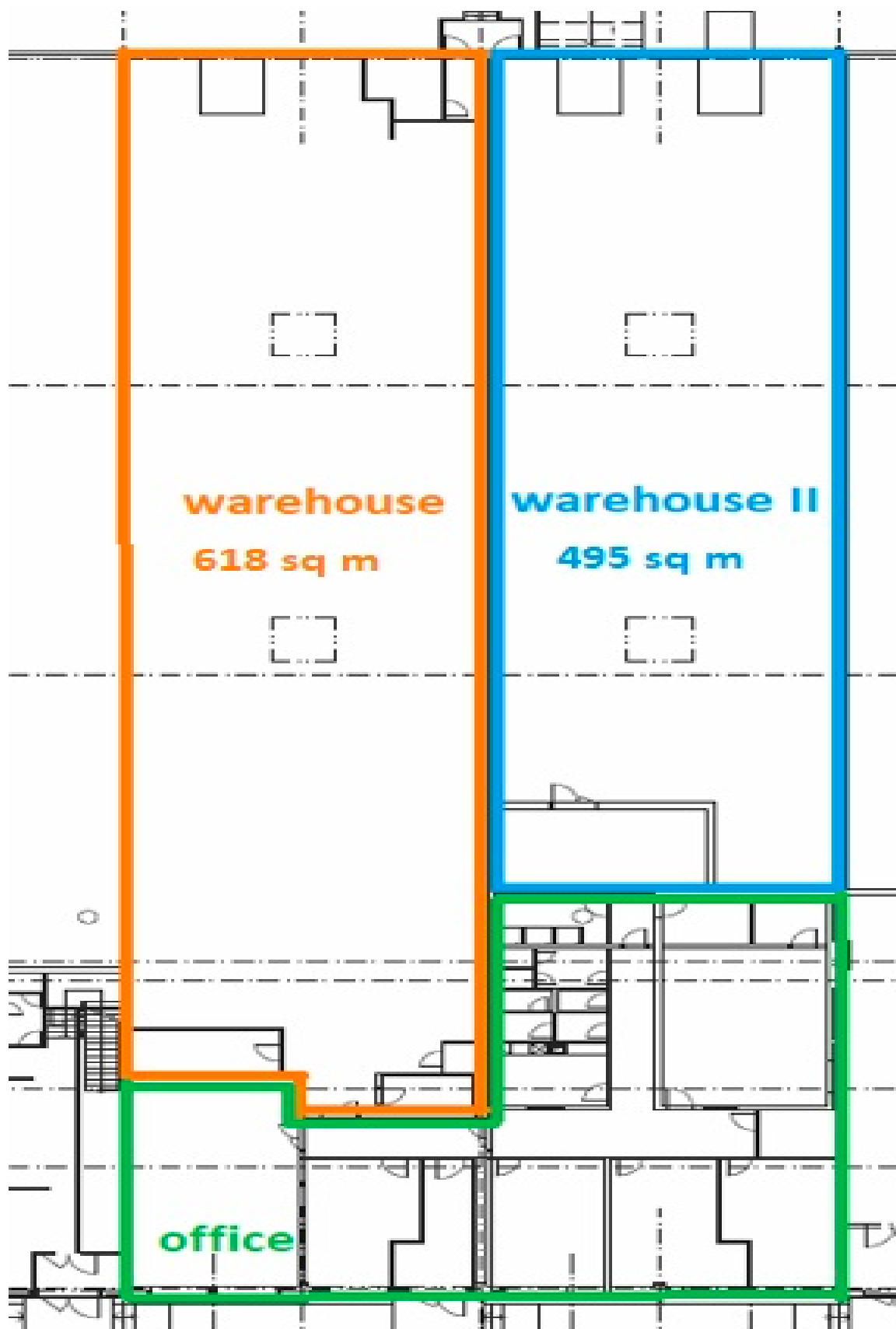



Warehouse space

Ask for price

1 467 m², Praha 5, Zličín, Na Radosti

