

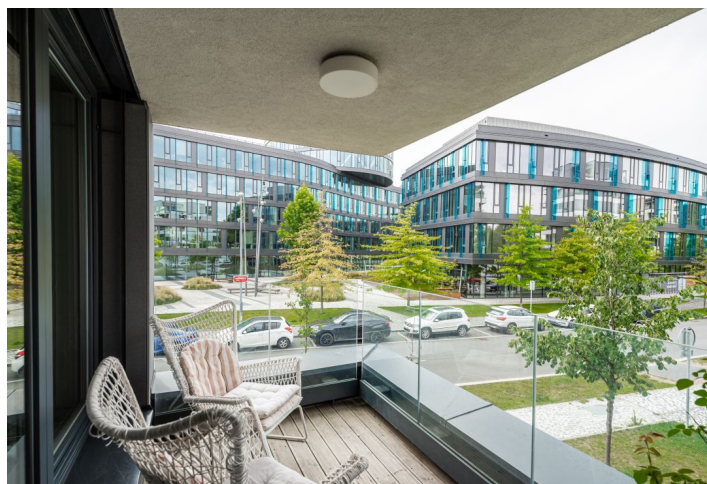

## Apartment One-bedroom (2+kk)

Sold

55.5 m<sup>2</sup>, Prague 5, Jinonice, Kačírková





## Apartment One-bedroom (2+kk)

**Sold**55.5 m<sup>2</sup>, Prague 5, Jinonice, Kačírková

Total area	61 m <sup>2</sup>
Floor area*	56 m <sup>2</sup>
Terrace	5 m <sup>2</sup>
Parking	1 garage parking space
Garage	Yes
Cellar	Yes
PENB	B
Reference number	105540

**This south-facing apartment with a terrace and a parking space is part of a modern new building in the Waltrovka residential complex, which offers a wide range of services and peaceful living in close proximity to a park with the same name.**

The apartment, located on the 1st floor, consists of a living room with a kitchen with access to the **terrace**, a bedroom, a bathroom, a separate toilet, and a hallway. It also includes **1 garage space** and a **cellar**, both located on the ground floor.

The airy space of the apartment is created by a **large-format window** with a view of the terrace. All rooms are equipped with high-quality, **custom-made furniture**, including the kitchen, which has Whirlpool appliances. The high standard facilities are complemented by a **wooden floor, wooden windows (triple-glazed)** with front window **aluminum blinds** and bathroom sanitary ware by **Laufen and Villeroy & Boch**. The centrally heated building with an elevator allows residents use of a **shared bicycle shed and garden**.

This rapidly developing part of Prague provides a large number of services, including restaurants and cafes, shops, medical facilities, state and private schools, as well as excellent connections to the city center from the **Jinonice metro station**. The popular natural areas of **Prokop Valley** or **Vidoule**, as well as nearby sports facilities and **golf courses**, provide opportunities for active enjoyment.

Floor area 55.5 m<sup>2</sup>, terrace 5 m<sup>2</sup>.

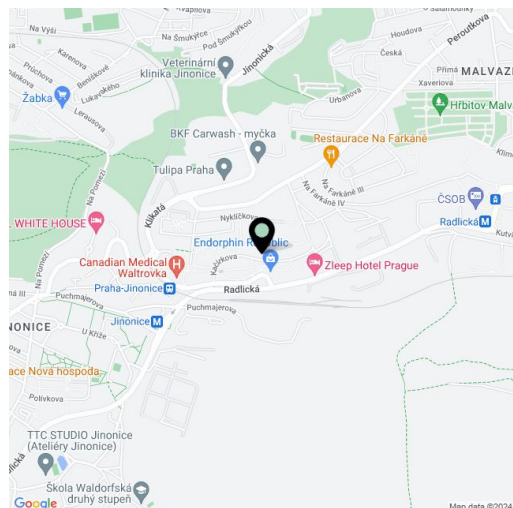

\* Area of the unit according to the Civil Code. The area consists of the sum total area of the entire unit bounded by perimeter walls.



# Apartment One-bedroom (2+kk)

55.5 m<sup>2</sup>, Prague 5, Jinonice, Kačírková

Sold

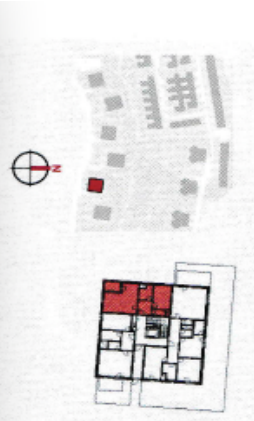

01	CHODBA	6,2 M <sup>2</sup>
02	WC	2,1 M <sup>2</sup>
03	POKOJ	12,9 M <sup>2</sup>
04	KOUPELNA	5,4 M <sup>2</sup>
05	OBŤVACÍ POKOJ + KK	25,7 M <sup>2</sup>
Účinná plocha bytu		52,3 M <sup>2</sup>
Podlahová plocha bytu		56,4 M <sup>2</sup>
06	LODŽIE	5,0 M <sup>2</sup>

**BYT Č. 102**

DŮM B5

2+KK | 52,3 M<sup>2</sup>



REZIDENCE WALTROVKA  
LIVING BY PENTA

