



Industrial space

434 m², Olomouc, Nemilany, Dolní Novosadská

Ask for price





Industrial space

Ask for price

434 m², Olomouc, Nemilany, Dolní Novosadská

Total area	434 m ²
Available area for rent	434 m ²
Ceiling height	10 m
Floor loading capacity	5 t/m ²
Column grid structure	—
Structure	Reinforced concrete structure
PENB	B
Reference number	105685

434 sq.m. of industrial, warehouse and office space for lease in a logistic park located in the district of Olomouc - Nemilany. The project consists of 4 buildings; construction of this park commenced 2009.

Location:

The logistic park is situated in the district of Olomouc – Nemilany with direct access to the motorway D35 exit 272. The park is well connected with the city center by public transport. The Nemilany train station is approx. 3 km from the park.

Features and Services:

- all infrastructure available in the area
- in the area are allowed trucks of any total weight
- high standards of buildings

Office:

- Flexible office layout
- Air-conditioning

Warehouse/Industrial space:

- Min.1 loading dock per 1000 sq.m
- Floor loading capacity 5 T/sq.m
- Clear height 10 m
- Truck yard 35 m
- Column grid structure 24x12 m
- Sprinkler system

Lessee pays no commission.

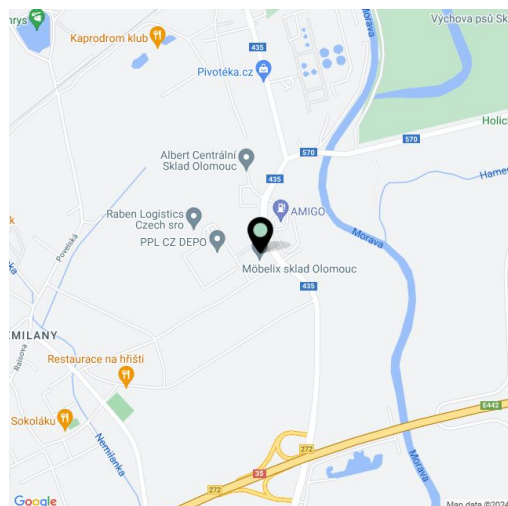



Industrial space

Ask for price

434 m², Olomouc, Nemilany, Dolní Novosadská

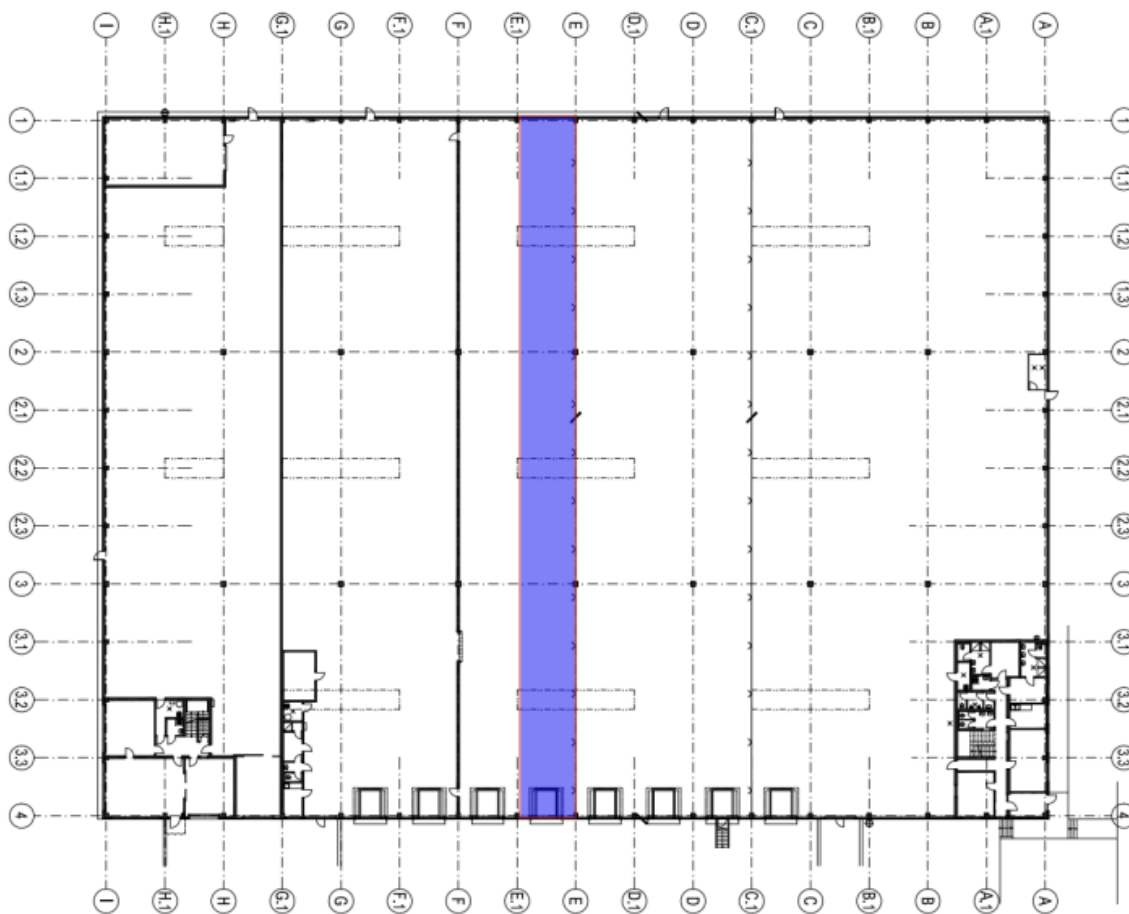

WH
434 sqm

Building A



Industrial space

434 m², Olomouc, Nemilany, Dolní Novosadská

Ask for price



