



House Five-bedroom (6+kk)

€ 1 389 331 | CZK 34 900 000

317 m², Prachatice, Kvilda





House Five-bedroom (6+kk)

€ 1 389 331 | CZK 34 900 000

317 m², Prachatice, Kvilda

Plot	598 m ²
Foot print	155 m ²
Garden	443 m ²
Parking	Yes
Cellar	-
PENB	C
Reference number	105882

This mountain family house with 4 fully equipped apartments, a sauna, and a ski storage room is located on the edge of Kvilda, the highest-altitude situated village in the Czech Republic. The area is renowned for its numerous cross-country skiing trails, bike paths, and hiking trails that wind through the picturesque Šumava landscape. The Kvilda ski resort is within walking distance.

The three-story house, approved for occupancy in 2012, comprises 4 separate apartments, each offering beautiful views across the Kvilda Valley and the surrounding nature. On the first floor, there is a spacious 110 m² apartment featuring a living room with a **tiled stove**, a dining area, a kitchen, a bedroom, and a bathroom. The second floor includes 2 apartments, each with a living room and kitchenette, a bedroom, and a bathroom. The basement level houses a one-room apartment with a bathroom. The shared areas of the house include a **sauna**, a stroller storage room, and a ski/bike storage room. **Ample parking** is available on the unfenced land adjacent to the house, which also features a small wooden structure with two storage rooms.

The house has **wooden triple-glazed windows** and 20 cm thick insulation. Heating is provided by a ground-source **heat pump** with **two boreholes** totaling 180 meters in depth. The property is **connected to the municipal water and sewage systems**.

The village of **Kvilda** is located in the heart of the beautiful Šumava plains and is one of the main tourist centers of **Šumava National Park**. In addition to extensive recreational activities such as hiking, cycling, cross-country skiing, and downhill skiing, it offers several nature trails, the Jezerní Slat **Observation Tower** near Kvilda, the Kvilda museum, and local country restaurants. Once the new highway section opens in December, traveling from Prague's center will take approximately 1 hour and 55 minutes.

Floor area 316.54 m², garden 443 m², built-up area 155 m², plot 598 m².

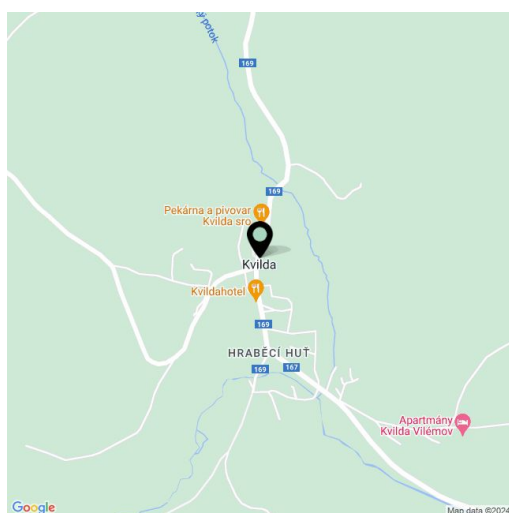



House Five-bedroom (6+kk)

€ 1 389 331 | CZK 34 900 000

317 m², Prachatice, Kvilda

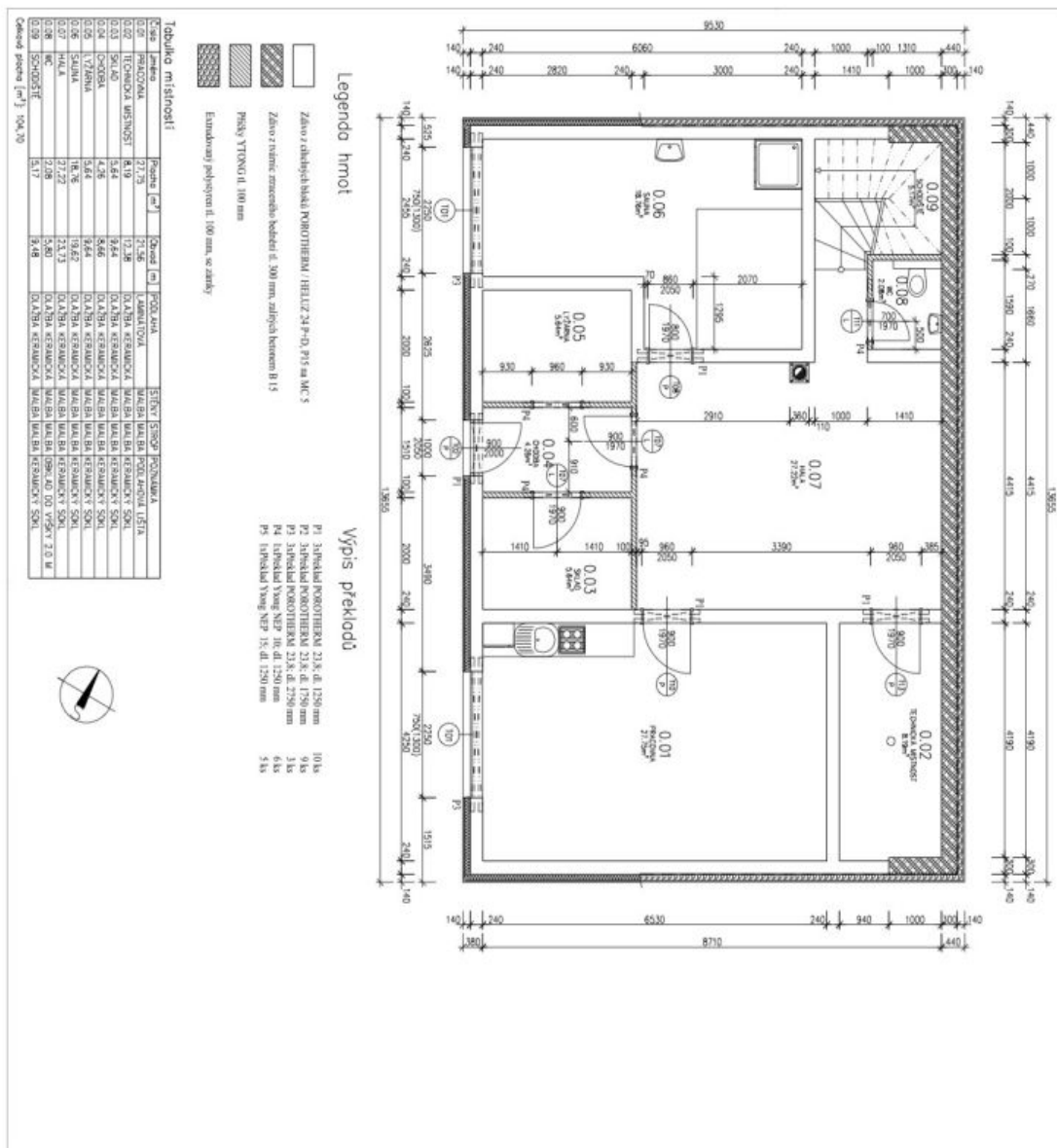



House Five-bedroom (6+kk)

€ 1 389 331 | CZK 34 900 000

317 m², Prachatice, Kvilda

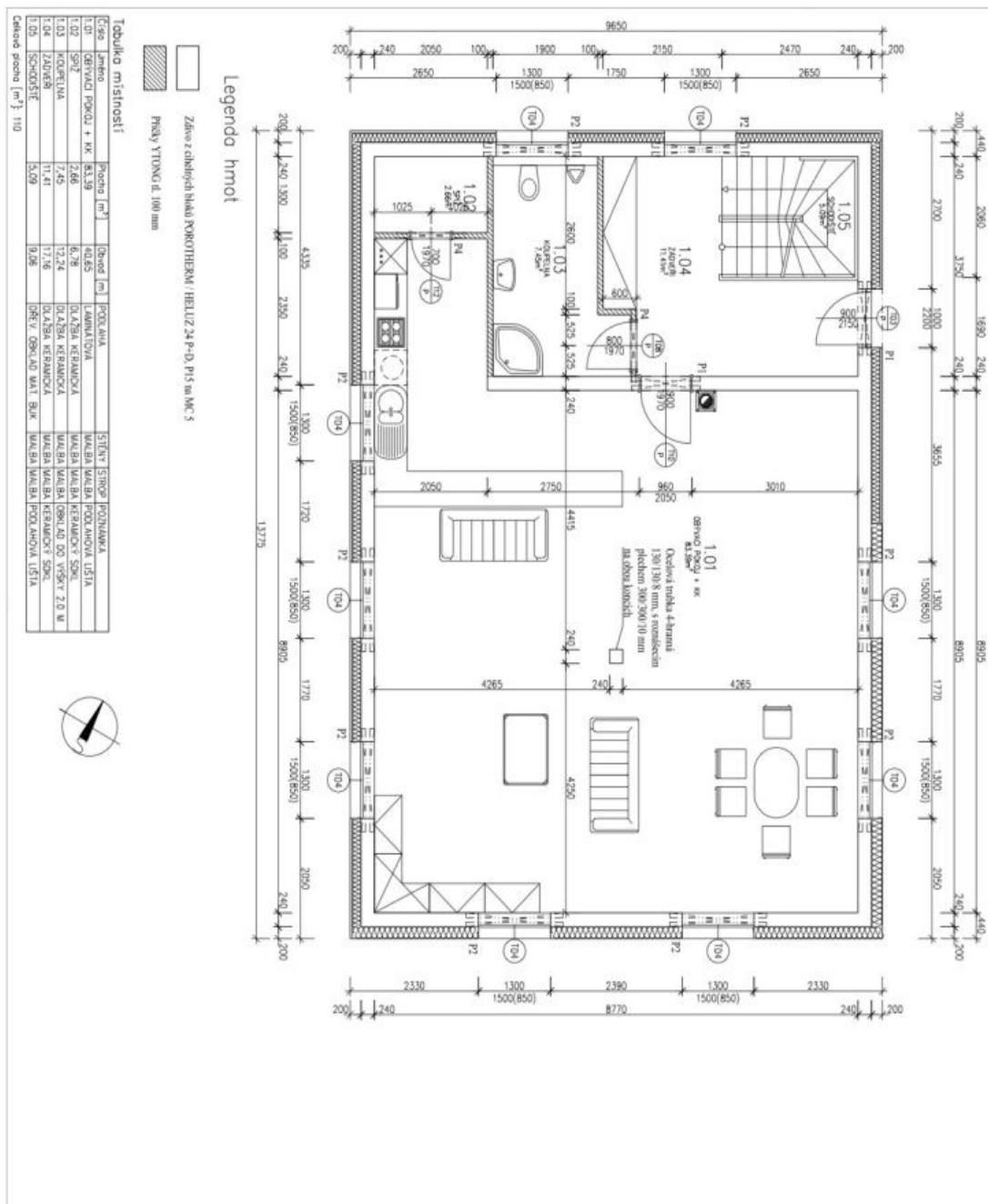



House Five-bedroom (6+kk)

€ 1 389 331 | CZK 34 900 000

317 m², Prachatice, Kvilda

