



Warehouse space

4 364 m², Ostrava-město, Ostrava, Halasova

Ask for price





Warehouse space

4 364 m², Ostrava-město, Ostrava, Halasova

[Ask for price](#)

Total area	4 364 m ²
Available area for rent	4 364 m ²
Office area	41 m ²
Ceiling height	10 m
Floor loading capacity	5 t/m ²
Column grid structure	—
Structure	Reinforced concrete structure
PENB	B
Reference number	106966

4 323 sqm of warehouse and **41 sqm** of office space incl. background for lease in an area located in Ostrava - Vítkovice. After a demanding rehabilitation, the 44ha brownfield is ready for the construction of a modern commercial-industrial park. The tenants of the park have at their disposal premises of various sizes suitable for companies operating in a wide range of commercial and production act.

Location:

The park is located in the wider center of Ostrava in the area of Ostrava Vítkovice with excellent transport accessibility. Direct connection to the highway leading to Brno and Poland. There are 3 entrances to the park. There is a tram stop near the complex.

Features and Services:

- All infrastructure available on site
- High standards of buildings
- A functional railway along the eastern perimeter of the compound
- A large number of parking spaces for cars and trucks

Industrial/Warehouse space:

- Flexible unit layouts
- Variable units from 1,500 sqm
- 4 drive-ins
- 16 docks with loading bridge
- Floor load: 5t/sq.m.
- Clear height of storage areas: 10-12 m
- Column module: 24×12 m
- Loading yard: 35 m
- Sprinklersystem
- Infrared emitters /ceiling heating units
- BREEAM Very Good

Office:

- Flexible office layout
- Air-conditioning

Rental and service charges listed without VAT. Lessee pays no commission.

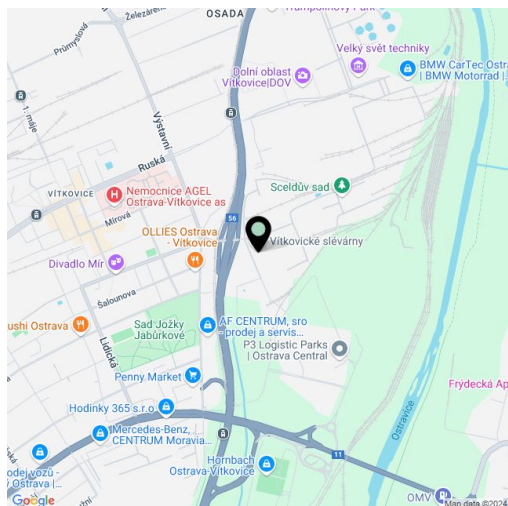



Warehouse space

4 364 m², Ostrava-město, Ostrava, Halasova

Ask for price

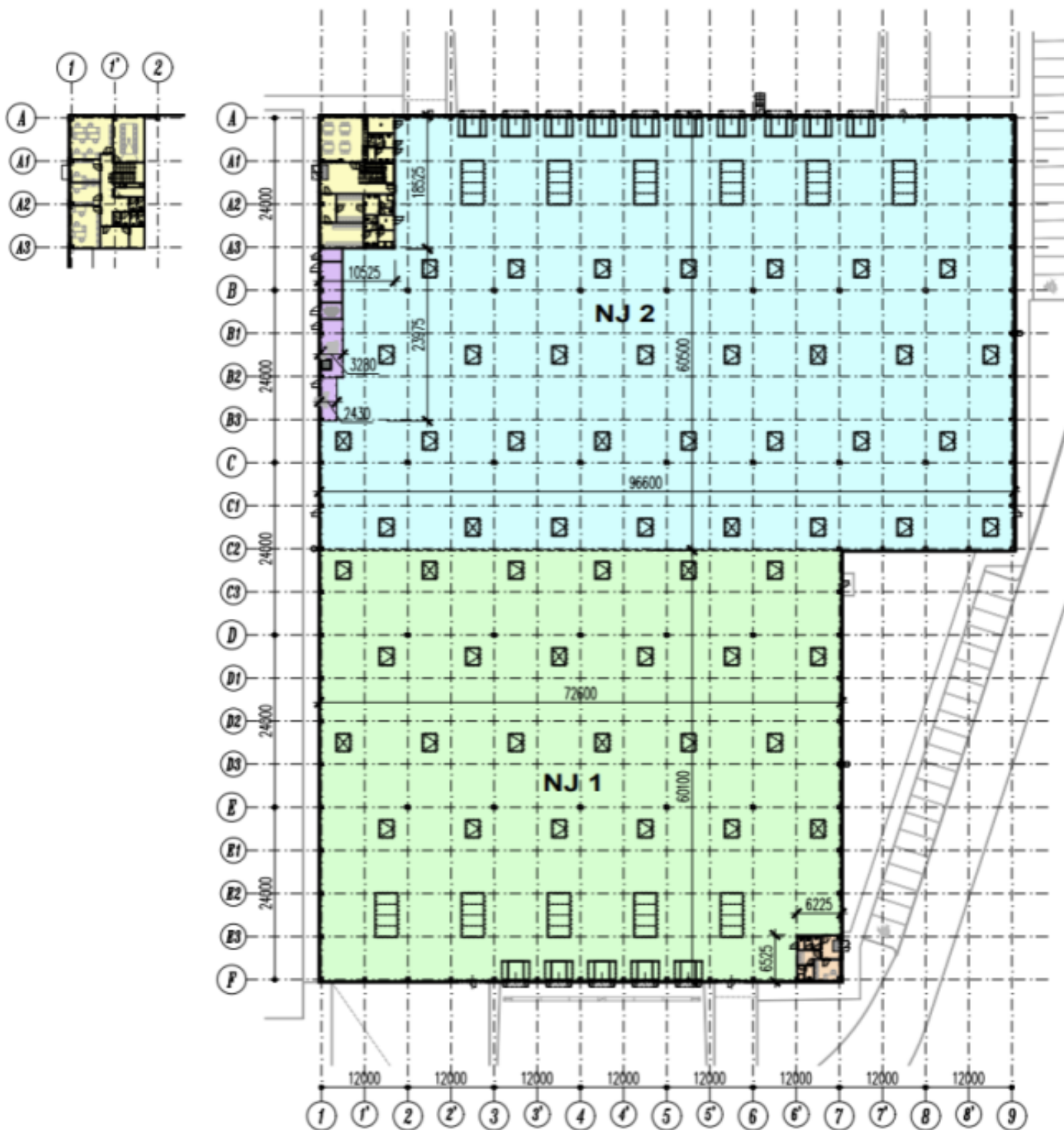



LEGENDA

- OF KOKANIKACE - MĀJNĀ TRASY
- OF KOKANIKACE - MĀJNĀ TRASY
- OF KOKANIKACE - MĀJNĀ TRASY
- OF - PLATOVĀNĀ CHYTOUŠTĀ
- OF - TRÁVA, DVĀŘNĀ LUKA
- KOLEJE
- OF VĚTRNĀK
- OF - SENCE
- OF - SENCE 20M
- OF - SENCE 10M
- OF - PĀNĚTĀNĀ
- OF - KOKANIKACE 5M
- ZÁKLADNĀ ÚZEŘĀ
- NĀMĚŘENĀ TĚLĀ ČI ČIHOUŠTĀ
- NĀMĚŘENĀ KOKANIKACE
- ZPĚVNĀČNĀ FLOUČĀ
- ŽELEŽNĀ
- ZÁMĚŘENĀ ÚZĀŘĀ - NĀMĚŘENĀ VĚŠENĀ
- STĀNĀ - PLÁŤNĀ (ALE PĚŠĀK, PĀČERNĀ KOKANIKACE)
- STĀNĀ - ŽELEŽNĀ (SĀK, ŽELEŽNĀ ČI LUKA, NĀMĚŘENĀ KOKANIKACE, OF)

Objekt	Podzemní	Podzemní	Podzemní	Podzemní	Podzemní	Podzemní	Podzemní	Podzemní	Podzemní	Podzemní	Podzemní	Podzemní	Podzemní	Podzemní	Podzemní	Podzemní	Podzemní	Podzemní	Podzemní
U1	U2	U3	U4	U5	U6	U7	U8	U9	U10	U11	U12	U13	U14	U15	U16	U17	U18	U19	U20
28 510	24 484	4 032	7	1 462	2 280	30	8	161	242	13									
29 524	28 497	4 042	7	1 462	2 280	30	8	161	242	13									
14 498	14 136	2 394	4	825	1 425	32	4	128	196	17									
18 516	9 212	2 394	4	825	1 425	16	4	81	136	17									
14 498	12 180	2 394	4	825	1 425	28	4	85	196	23									
14 498	12 180	2 394	4	825	1 425	28	4	85	196	23									
18 516	9 212	2 394	4	825	1 425	16	4	81	136	17									
18 516	9 212	2 394	4	825	1 425	16	4	81	136	17									
7 584	3 081	376	1	207	349	5	1	43	25	8,8									
4 182	3 081	376	1	207	349	5	1	43	25	8,7									
4 182	3 081	376	1	207	349	5	1	43	25	8,7									
1 444	849	376	1	207	349	5	1	43	25	8,7									
1 444	849	376	1	207	349	5	1	43	25	8,7									
1 444	849	376	1	207	349	5	1	43	25	8,7									
2 282	1 444	376	1	207	349	5	1	43	25	8,7									
1 665	576	376	1	207	349	5	1	43	25	8,7									
2 282	1 665	576	1	207	349	5	1	43	25	8,7									
14 498	14 498	14 498	14 498	14 498	14 498	14 498	14 498	14 498	14 498	14 498	14 498	14 498	14 498	14 498	14 498	14 498	14 498	14 498	14 498
4 364	2 040	25 838	4 270	4 130	348														

* Všechny údaje jsou uvedeny v m².
 * Všechny údaje jsou uvedeny v m².
 * Všechny údaje jsou uvedeny v m².



Warehouse space

4 364 m², Ostrava-město, Ostrava, Halasova

Ask for price



Budova	Zastavěná plocha m ²
L1	28 516
L2	29 524
L3	16 438
M1	10 516
M2	14 884
M3	14 884
M4	10 516
S1	38 444
S2	7 564
S3	4 180
S4	4 180
S5	4 180
XS1	1 444
XS2	1 444
Celkem	152 114