



Apartment Three-bedroom (4+kk)

€ 2 193 | CZK 55 000

141 m², Prague 6, Vokovice, Nobelova





Apartment Three-bedroom (4+kk)

€ 2 193 | CZK 55 000

141 m², Prague 6, Vokovice, Nobelova

Total area	180 m ²
Floor area*	141 m ²
Terrace	39 m ²
Front garden	6 m ²
Parking	Garage parking.
Garage	Yes
Cellar	8 m ²
Service price	Monthly deposit for services and water: CZK 6,000. Electricity and gas are billed separately (transferred to the tenant).
PENB	C
Reference number	107467
Available from	Immediately

Benefiting from a terrace, a front garden, and green views, this furnished split-level apartment is on the ground floor of the modern Na Krutci residential complex, designed by the Kuba & Pilař architectural studio, with a 24/7 reception and security, a sports center, and a tennis court. Conveniently located for the airport and international schools in Prague 6, with quick connections to the city center. Set on the edge of the Šárka protected nature preserve, an area with full amenities within easy reach, just five min. to the Nádraží Veleslavín tram stops and metro station.

The main floor of the apartment includes an **air-conditioned** living room with a fully fitted open plan kitchen and dining area, 2 bedrooms, a bathroom with a walk-in shower, a separate toilet, a storage room, and an entrance hall. In the basement, accessible by an interior staircase, is a guest bedroom and a bathroom with a walk-in shower and toilet.

Laminate floating floors, tiles, **wooden Euro windows**, built-in wardrobes in the hall and guest bedroom, automatic curtains and blinds, gas boiler, underfloor heating in the bathrooms, washer, dryer, dishwasher, Siemens kitchen appliances, **two cellars**. A **garage parking** space is included.

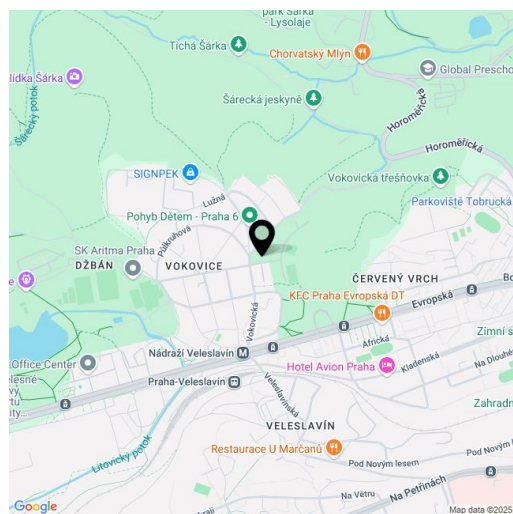

* Size of the unit according to the Housing Act.
The area consists of the sum total of the internal area of every room.



Apartment Three-bedroom (4+kk)

€ 2 193 | CZK 55 000

141 m², Prague 6, Vokovice, Nobelova

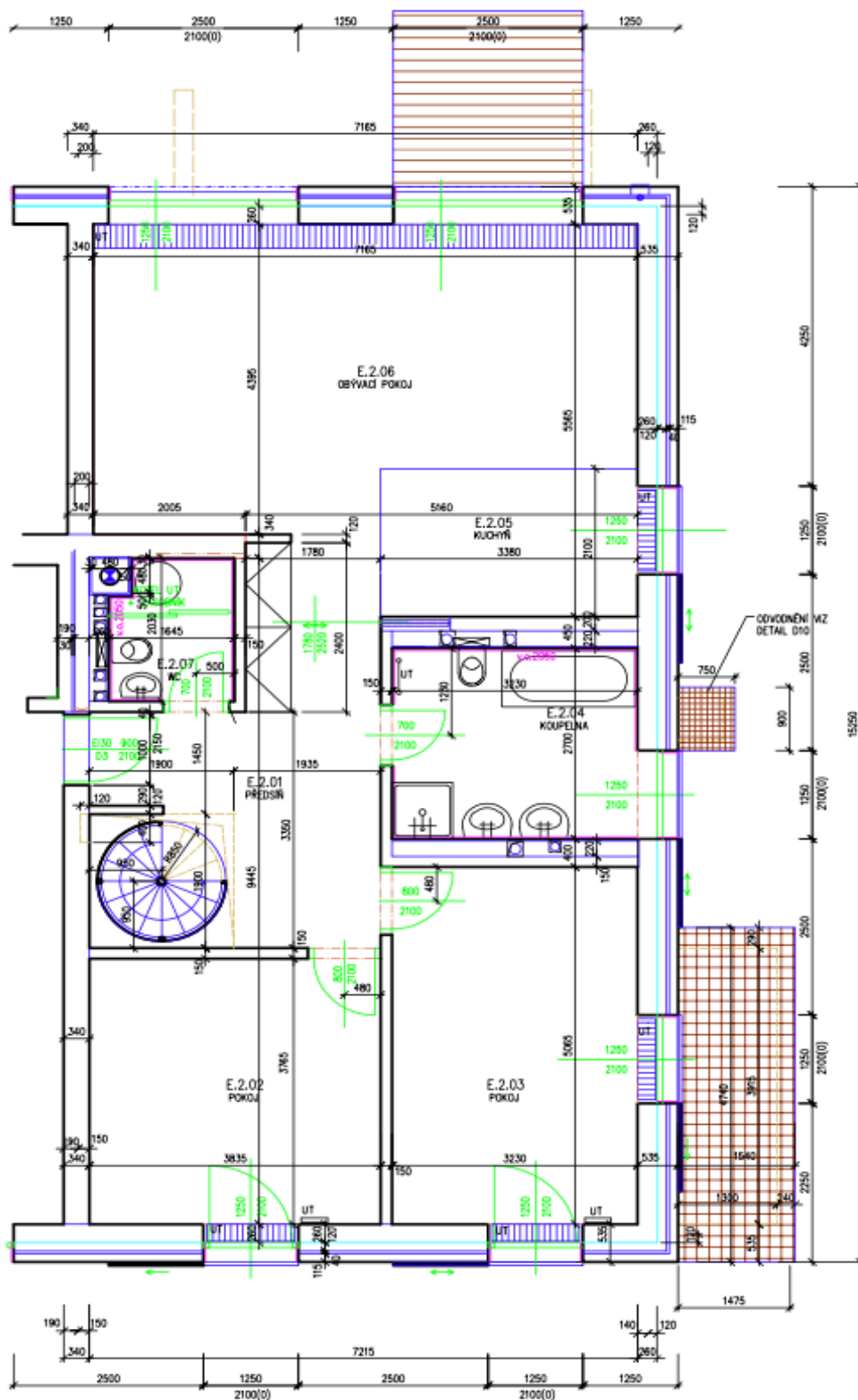



Apartment Three-bedroom (4+kk)

€ 2 193 | CZK 55 000

141 m², Prague 6, Vokovice, Nobelova

