

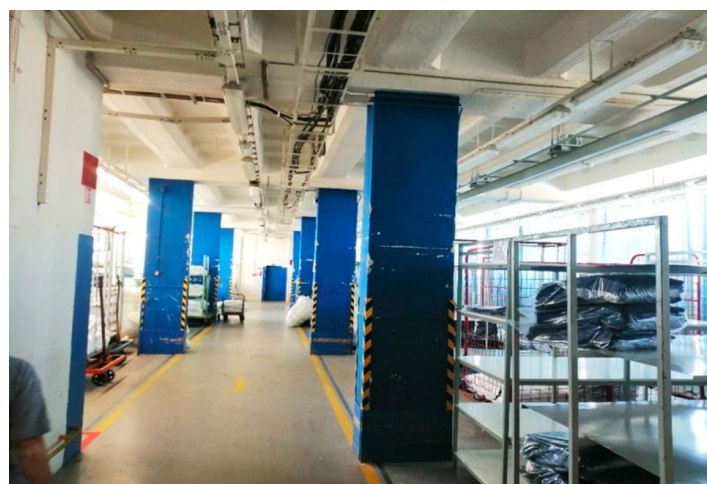

Industrial space

3 000 m², Břeclav, Břeclav, Mládežnická

Ask for price





Industrial space

3 000 m², Břeclav, Břeclav, Mládežnická

Ask for price

Total area	3 000 m ²
Available area for rent	3 000 m ²
Ceiling height	4 m
Floor loading capacity	2 t/m ²
Column grid structure	—
Structure	Reinforced concrete structure
PENB	G
Reference number	107741

3 000 m² of industrial, warehouse and office premises for lease in Břeclav. The premises are suitable for light manufacturing, logistics and storage.

Location:

The park is located in the southeastern part of the city of Břeclav (6.5 km from exit 48 of the D2 highway for cars up to 3.4 m high and 22 km for cars over 3.4 m high).

Equipment and services:

- The area is accessible 24/7 with permanent security
- Utility networks (sewerage, water supply), electrical network 230 V/400 V
- The area is gasified
- Outdoor handling areas for unloading and loading
- Possibility of parking at the object
- Excellent accessibility for employees by train and bus

Warehouse/Industrial space:

- Detached three-storey building B7
- 2 lifts in the building with a capacity of 4 t and 5 t
- Clear height 4 m
- Floor loading capacity 5 t/sq.m
- Sprinklers

Lessee pays no commission.

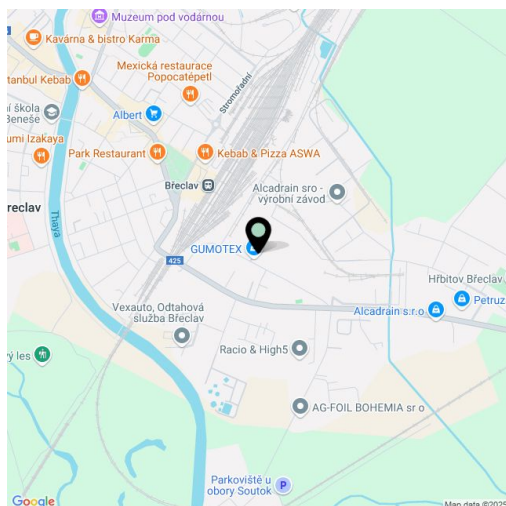



Plány – 1. nadzemní podlaží





Plány – 2. nadzemní podlaží

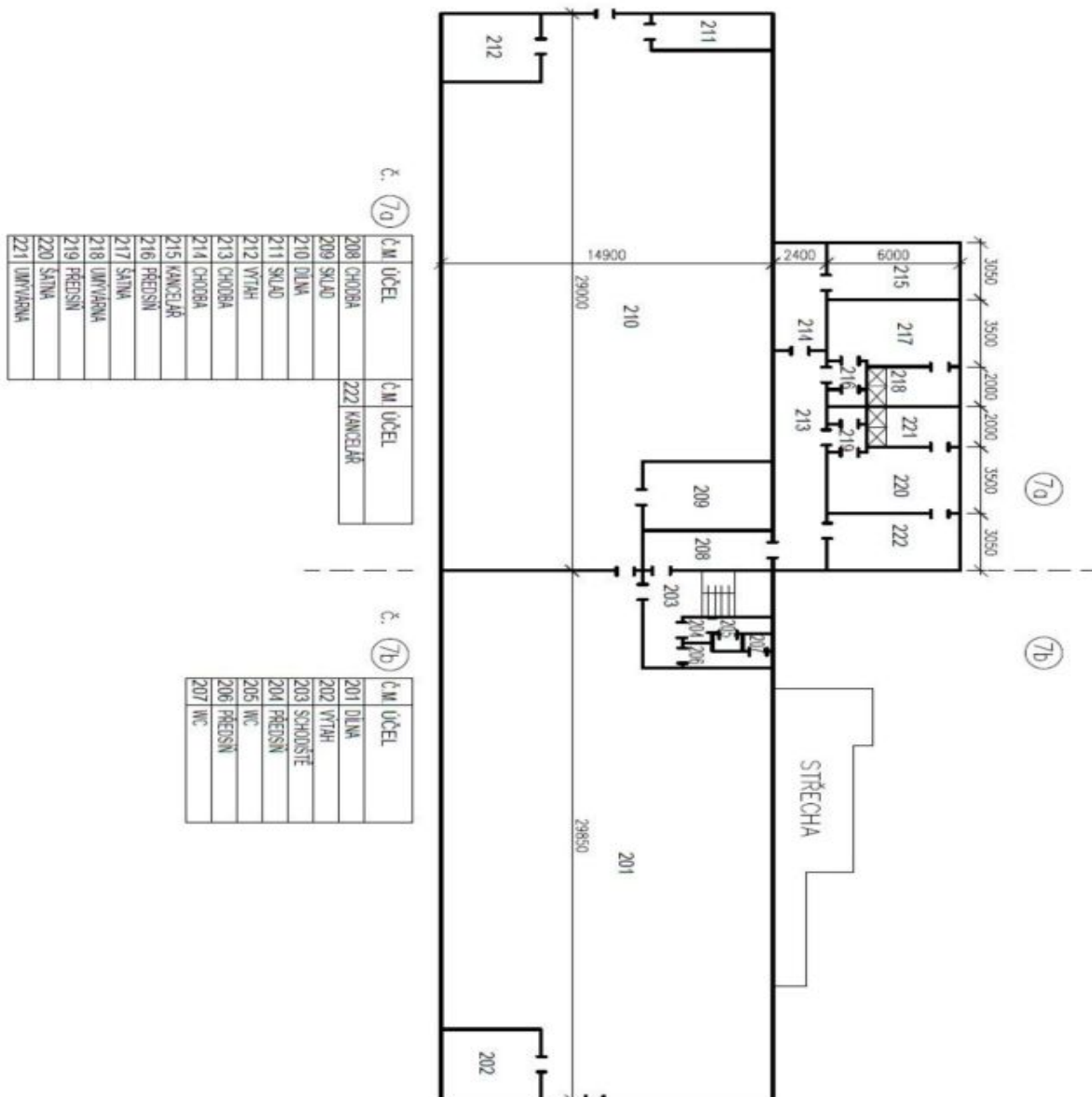



Plány – 3. nadzemní podlaží

