



House Five-bedroom (6+1)

Rented

312 m², Prague 5, Jinonice, Souběžná I





House Five-bedroom (6+1)

Rented312 m², Prague 5, Jinonice, Souběžná I

Plot	838 m ²
Foot print	164 m ²
Parking	Garage and parking on the plot.
Garage	Yes
Cellar	Yes
PENB	D
Reference number	12594
Available from	Immediately

Unfurnished 5-bedroom 3-bathroom free standing house with a sauna and a landscaped garden situated in Jinonice, Prague 5, just steps from the German School. Quiet residential location adjacent to a natural preserve, seven minutes to the nearest metro (Nové Butovice station), a short walk to Galerie Butovice Shopping Center, and within walking distance of a golf course and tennis courts.

On the ground floor there is a large living room opening into the winter garden and dining area plus access to the terrace and garden, a fully fitted and equipped kitchen, guest bedroom / study, shower bathroom, and entry hall. The upper floor includes three bedrooms, full bathroom and a fitted walk-in closet. The basement floor offers a guest suite (bedroom, shower bathroom), sauna, shower and relaxation area, playroom, utility room, and a separate back entrance.

The house has a garden of approx. 500 sq.m. with a lovely pond. Satellite connection, laminated and tile floors, safety windows with outdoor electrical blinds, floor heating throughout, built-in wardrobes, dishwasher. Garage (with remote control) and parking on the plot. Utilities CZK 8000 per month. Unfurnished despite the photos.

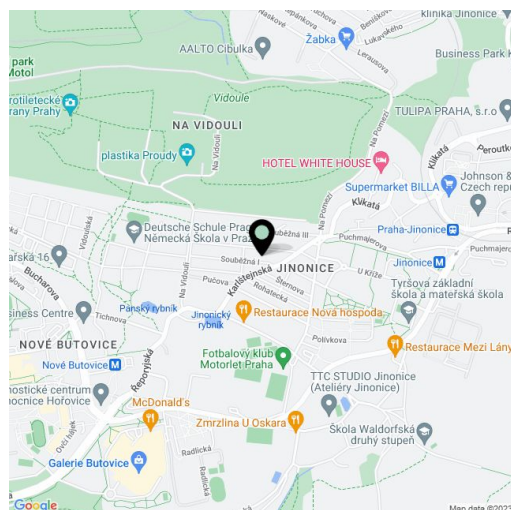

**House Five-bedroom (6+1)****Rented**312 m², Prague 5, Jinonice, Souběžná I**RODINNÝ DŮM
PRAHA 5
JINONICE**

SUTERÉN		96,8 m ²
01	SCHODIŠTĚ A CHODBA	10,2 m ²
02	DOMÁCÍ DÍLNA	32,7 m ²
03	UMÝVÁRNA	6,7 m ²
04	SKLAD	19,3 m ²
05	SKLAD	14,6 m ²
06	TECHNO.	13,3 m ²
PŘÍZEMÍ		123,4 m ²
1	ZÁDVEŘÍ	6,2 m ²
2	HALA	8,0 m ²
3	OBÝVACÍ POKOJ	32,7 m ²
4	JÍDELNA	12,2 m ²
5	KUCHYŇ	7,9 m ²
6	SPÍŽ	2,5 m ²
7	POKOJ	12,6 m ²
8	KOUPELNA, WC	4,3 m ²
9	SCHODIŠTĚ	7,3 m ²
10	GARÁŽ	24,0 m ²
11	SKLAD ZAHRAD.	5,7 m ²
12	ZIMNÍ ZAHRADA	
PODKROVÍ		91,7 m ²
21	LOŽNICE	23,0 (20,8) m ²
22	LOŽNICE	20,8 (19) m ²
23	PRACOVNA	14,4 (10,4) m ²
24	KOUPELNA	13,2 (10,1) m ²
25	ŠATNA	5,7 (5,2) m ²
26	SCHODIŠTĚ A CHODBA	14,6 m ²

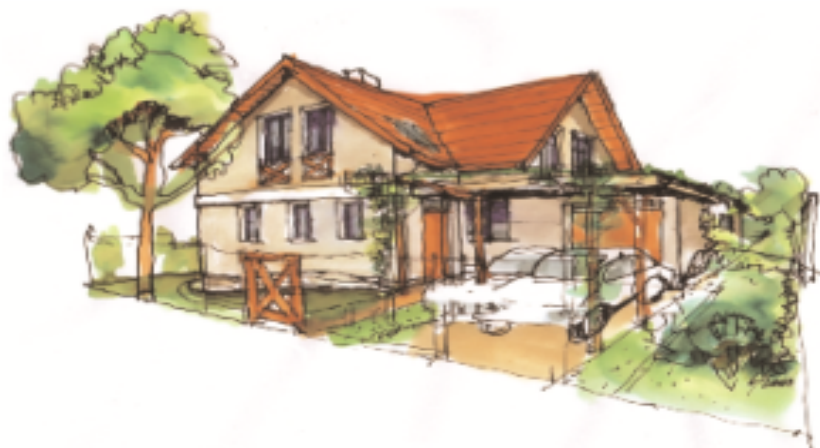
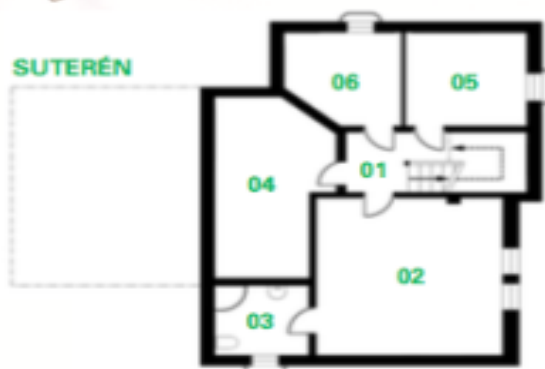



House Five-bedroom (6+1)

Rented

312 m², Prague 5, Jinonice, Souběžná I



WOHNHAUS PRAHA 5 JINONICE

KELLER		96,8 m²
01	TREPPENHAUS UND FLUR	10,2 m ²
02	HOBBYRAUM	32,7 m ²
03	BAD	6,7 m ²
04	LAGERRAUM	19,3 m ²
05	LAGERRAUM	14,6 m ²
06	HEIZUNGSRAUM	13,3 m ²
ERDGESCHOSS		123,4 m²
1	FLUR	6,2 m ²
2	HALLE	8,0 m ²
3	WOHNZIMMER	32,7 m ²
4	ESSZIMMER	12,2 m ²
5	KÜCHE	7,9 m ²
6	VORRATSRAUM	2,5 m ²
7	ZIMMER	12,6 m ²
8	BAD, WC	4,3 m ²
9	TREPPENHAUS	7,3 m ²
10	GARAGE	24,0 m ²
11	GARTENGERÄTE-RAUM	5,7 m ²
12	WINTERGARTEN	
DACHGESCHOSS		91,7 m²
21	SCHLAFZIMMER	23,0 (20,8) m ²
22	SCHLAFZIMMER	20,8 (19) m ²
23	ARBEITSZIMMER	14,4 (10,4) m ²
24	BAD	13,2 (10,1) m ²
25	ANKLEIDE	5,7 (5,2) m ²
26	TREPPENHAUS UND FLUR	14,6 m ²

