

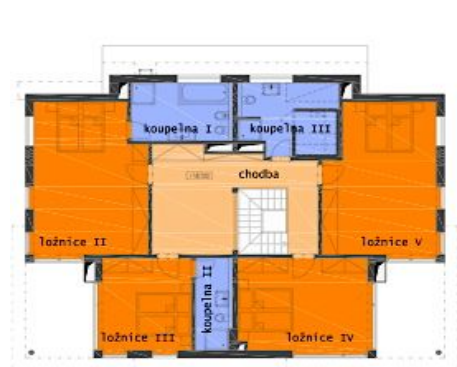

Apartment Five-bedroom (6+kk)

€ 1 734 413 | CZK 43 403 685

277.4 m², Prague 5, Smíchov, Mosnova



horní podlaží 6.np

chodba	21.44
ložnice II	27.10
koupelna I	9.36
ložnice III	13.97
koupelna II	5.25
ložnice IV	19.97
koupelna III	11.12
ložnice V	26.56
balkón I	39.33
balkón II	39.33

půdorys domu



vstupní podlaží 5.np

katalogový list

BYT Č.8

kategorie bytu

6 + KK

podlaží

5.np-6.NP

plocha bytu m²

hrubá podlažní plocha 282.33
čistá podlažní plocha 272.09
plocha balkonů/teras 78.66

užitnost m²

zádveři 8.89



Apartment Five-bedroom (6+kk)

€ 1 734 413 | CZK 43 403 685

277.4 m², Prague 5, Smíchov, Mosnova

Total area	356 m²
Floor area*	277 m²
Balcony	79 m²
Parking	Yes
Cellar	-
PENB	G
Reference number	13254

Spacious penthouse on the 5th and 6th floor of a new contemporary residence located in one of the highly sought after residential areas, Hřebenky, within easy reach of the Anděl commercial district, the popular Ladronka Park and the Kinského Garden; a 10 minute drive to the city center. The residence is formed by two interconnected villas situated on a steep hill with a beautifully landscaped mature garden and a gorgeous panoramic view of Prague. The villas present 8 apartments, 11 parking spaces and 9 cellars. This duplex situated in the upper villa offers an open space living, dining and kitchen area with French windows and 2 terraces. It further has 4 bedrooms, 3 bathrooms, extra WC and utility area. The equipment includes Internet and satellite TV connections in all main rooms, video intercom, and outside roller blinds with a wind sensor. The apartment is prepared for wireless alarm, and the last two floors will include air-conditioning as part of the standard equipment. Apartment 272 m², terrace 78,6 m². The purchase price includes 2 parking spaces and a cellar (10,8 m²) and VAT.

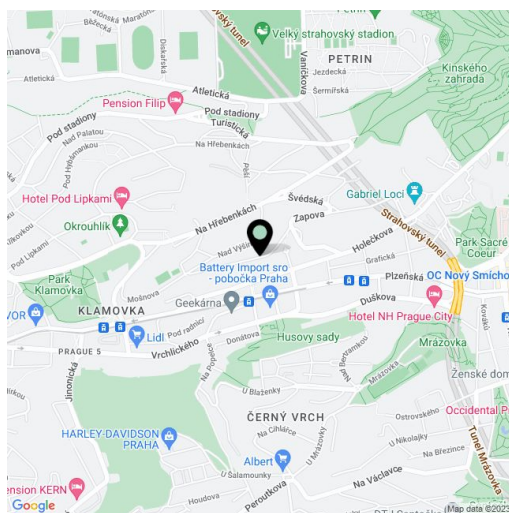

* Area of the unit according to the Civil Code. The area consists of the sum total area of the entire unit bounded by perimeter walls.