

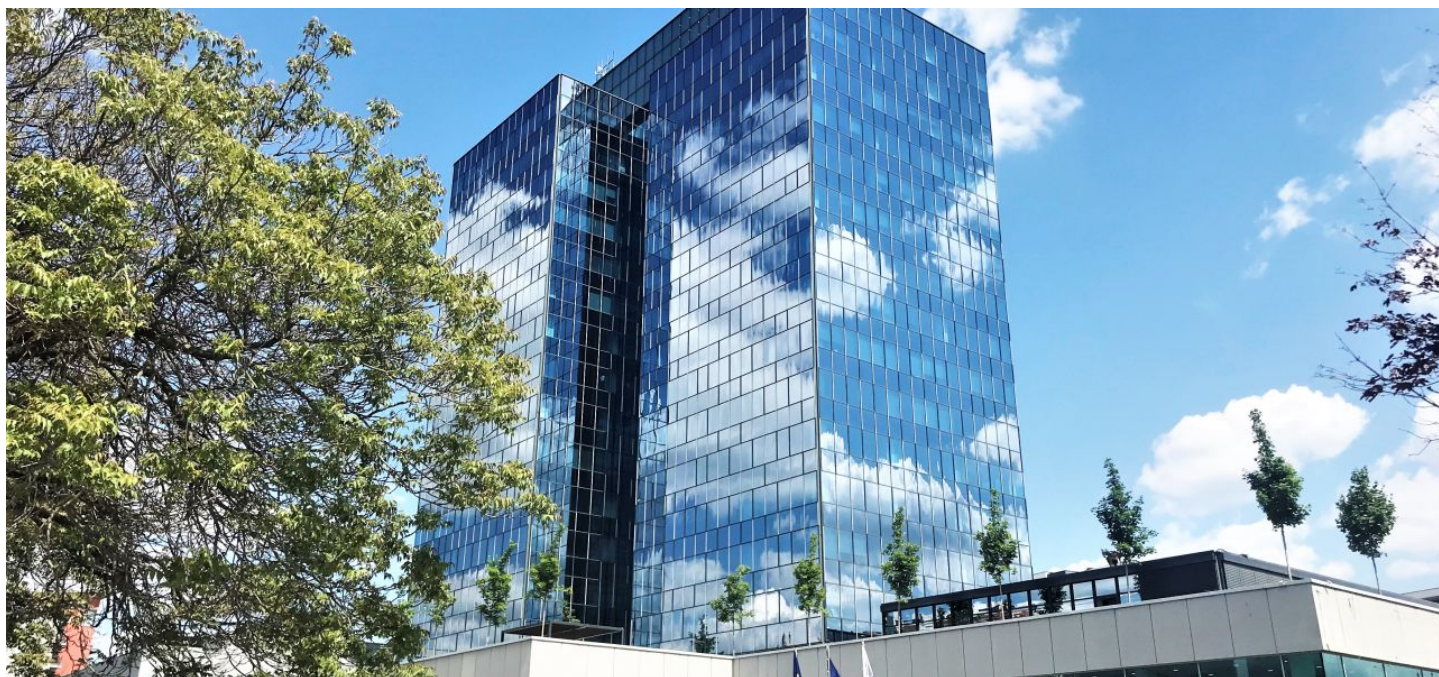

## Office building

8 500 m<sup>2</sup>, Praha 7, Holešovice, Jankovcova

Ask for price

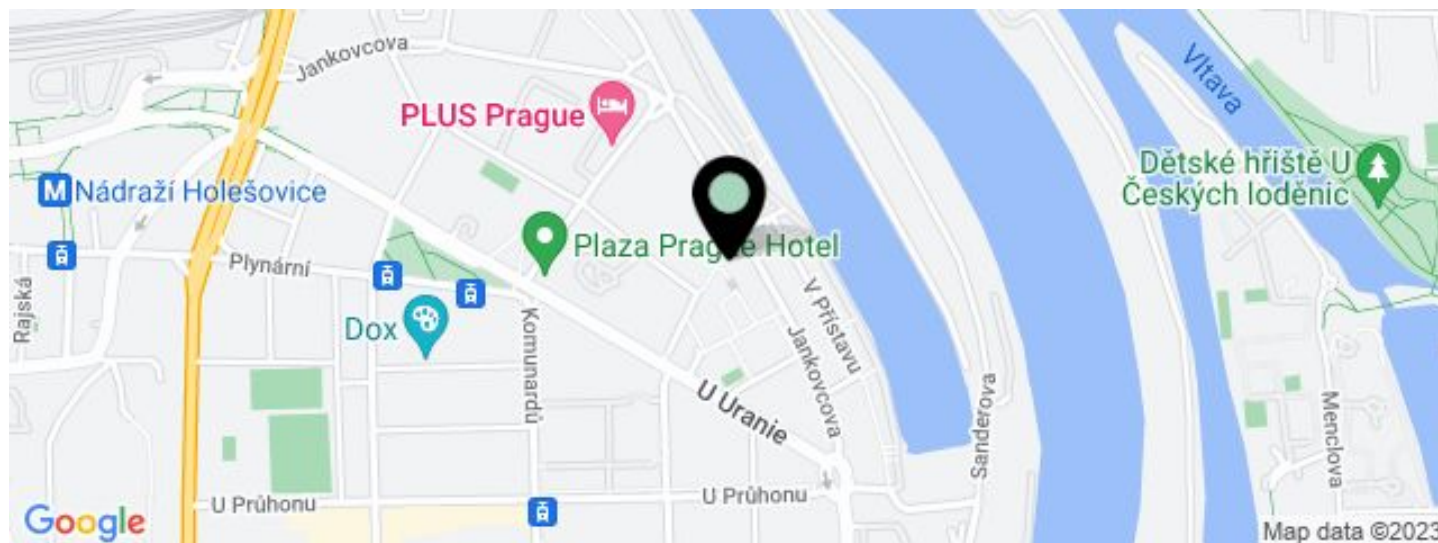

**Office building**8 500 m<sup>2</sup>, Praha 7, Holešovice, Jankovcova**Ask for price**

UNIT	AVAILABLE AREA	SERVICES	PARKING	MONTHLY RENT
Office space, 16th floor	300 - 850 m <sup>2</sup>	170 CZK monthly per m <sup>2</sup>	Yes	Ask for price
Office space, 15th floor	300 - 850 m <sup>2</sup>	170 CZK monthly per m <sup>2</sup>	Yes	Ask for price
Office space, 14th floor	300 - 850 m <sup>2</sup>	170 CZK monthly per m <sup>2</sup>	Yes	Ask for price
Office space, 13th floor	300 - 850 m <sup>2</sup>	170 CZK monthly per m <sup>2</sup>	Yes	Ask for price
Office space, 12th floor	300 - 850 m <sup>2</sup>	170 CZK monthly per m <sup>2</sup>	Yes	Ask for price
Office space, 11th floor	300 - 850 m <sup>2</sup>	170 CZK monthly per m <sup>2</sup>	Yes	Ask for price
Office space, 10th floor	300 - 850 m <sup>2</sup>	170 CZK monthly per m <sup>2</sup>	Yes	Ask for price
Office space, 9th floor	300 - 850 m <sup>2</sup>	170 CZK monthly per m <sup>2</sup>	Yes	Ask for price
Office space, 5th floor	300 - 850 m <sup>2</sup>	170 CZK monthly per m <sup>2</sup>	Yes	Ask for price
Office space, 4th floor	300 - 850 m <sup>2</sup>	170 CZK monthly per m <sup>2</sup>	Yes	Ask for price
Office space, ground floor, 2nd - 5th floor, 7th - 8th floor and 9th - 16th floor	300 - 8 500 m <sup>2</sup>	170 CZK monthly per m <sup>2</sup>	Yes	Ask for price



## Office building

8 500 m<sup>2</sup>, Praha 7, Holešovice, Jankovcova

**Ask for price**

Total building area	18 800 m <sup>2</sup>
Tenant consumption	—
Parking	100 - 150 EUR
Parking service charges	—
Parking ratio	—
Certification	—
PENB	B
Reference number	15054

**High quality A-class office space for lease located in high-rise dominant building in Prague 7 - Holešovice. The building has recently undergone a costly renovation and offers the office premises class A with stunning views of Prague. Underground garages and outdoor parking available.**

### Location:

The building offers excellent visibility and beautiful views to the tenants and is located at Libeňský bridge between vltavská metro station (line C) and Palmovka metro station (line B). The site offers good civic amenities.

### Features and Services:

- Flexible office space
- Structured cabling
- Fully air- conditioned
- Interior blinds
- Kitchenette
- WC within the unit
- High speed modern lifts
- Magnetic card access
- Underground and outdoor parking
- Central reception
- CCTV
- Electronic fire and security system
- Sprinklers

Rental and service charges are listed without VAT. Lessee pays no commission.



# Office building

8 500 m<sup>2</sup>, Praha 7, Holešovice, Jankovcova

Ask for price

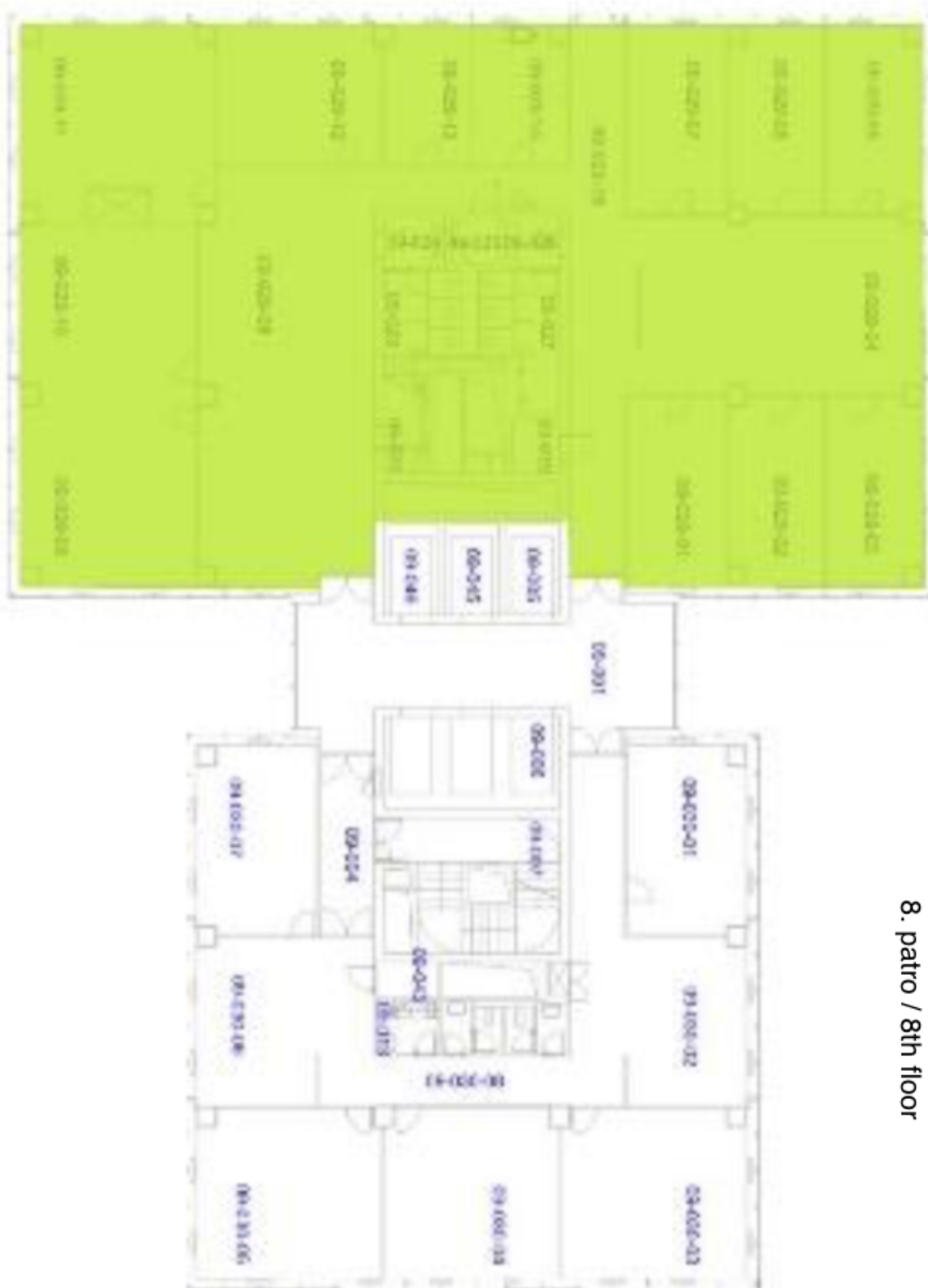

8. patro / 8th floor



## Office building

8 500 m<sup>2</sup>, Praha 7, Holešovice, Jankovcova

Ask for price

