



## Office space

€ 17.00 - 18.00 / m<sup>2</sup> | CZK 426 - 452 / m<sup>2</sup>

Prague 5, Smíchov, Plzeňská



**Office space**

Prague 5, Smíchov, Plzeňská

**€ 17.00 - 18.00 / m<sup>2</sup> | CZK 426 - 452 / m<sup>2</sup>**

<b>Service price</b>	170 CZK monthly per m <sup>2</sup>
<b>Available area</b>	376 m <sup>2</sup>
<b>Cellar</b>	-
<b>Parking</b>	EUR 140 / pp / month
<b>PENB</b>	G
<b>Reference number</b>	16065

Office premises for lease on the 1st floor in a multifunctional building situated in location of Prague 5 - Anděl.

**Location:**

The building is located in an attractive range of hotels, entertainment and shopping centers. Conveniently accessible due to the central location with superb connections to public transport. Tram stops and Anděl metro station (line B) are located just in front of the building. Easy access by car to the Strakonický tunnel and Prague ring road.

**Features and Services:**

- Open-plan layout or separate offices
- Raised floors
- Carpets
- Interior sunblinds
- Storage
- Reception desk
- 24-hour security
- Modern elevators
- Underground parking garage

Rental and service charges listed without VAT. Lessee pays no commission.

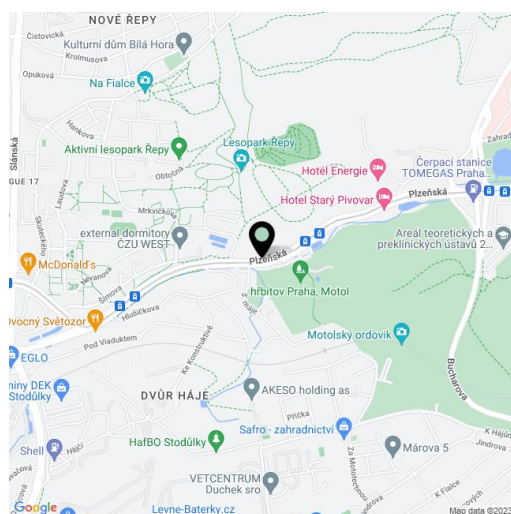



# Office space

€ 17.00 - 18.00 / m<sup>2</sup> | CZK 426 - 452 / m<sup>2</sup>

Prague 5, Smíchov, Plzeňská

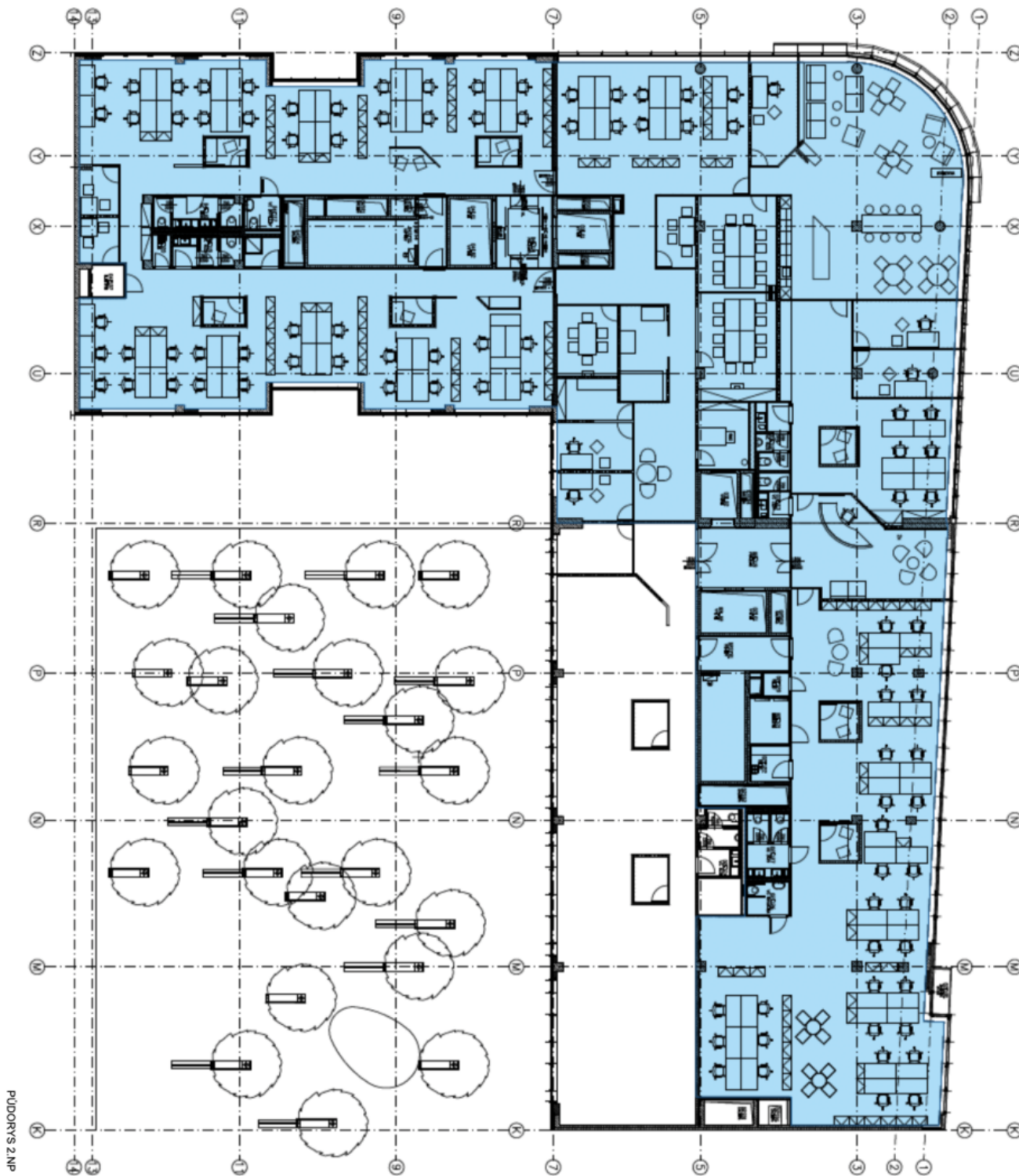

PUDORYS 2.NP