



## House Six-bedroom (7+1)

382 m<sup>2</sup>, Prague 10, Benice, Žitavská

**Sold**





## House Six-bedroom (7+1)

382 m<sup>2</sup>, Prague 10, Benice, Žitavská

**Sold**

Total area	382 m <sup>2</sup>
Plot	1 052 m <sup>2</sup>
Foot print	207 m <sup>2</sup>
Garden	845 m <sup>2</sup>
Floor area	350 m <sup>2</sup>
Terrace	32 m <sup>2</sup>
Parking	Yes
Garage	Yes
Cellar	-
PENB	B
Reference number	16721

**Modern family house with swimming pool and 2-car-garage in an architecturally unified residential area at the outskirts of Prague, 15 minutes by car on D1 highway to the center, within reach of the Čestlice commercial zone and public amenities in Průhonice.**

The house offers a spacious living room with a fireplace, double-height ceiling, an open space kitchen with a dining room - all with a direct access to the garden. Storage space and double garage in a lower groundfloor. In the second part of the ground floor is a room/study with TV and a guest room with en-suite bathroom and a closet. Upper floor consists of a spacious entrance hall and 4 bedrooms with a balcony or terrace. Two bedrooms share one large bathroom and the other two bedrooms each have en-suite bathroom and a closet.

Facilities include **a heat recovery ventilation**, underfloor heating, electric roller shutters, central vacuum, **IQ system to control heating, blinds and lights**. Heated swimming pool and a garden with irrigation system.

Pleasant and safe residential location with international nursery school in the compound. Nearby is Park Holiday Congress & Wellness centrum with tennis and squash courts, bowling, wellness and fitness centre, restaurant.

Interior 350 m<sup>2</sup>, terrace/balconies 32.7 m<sup>2</sup>, plot 1052 m<sup>2</sup>.

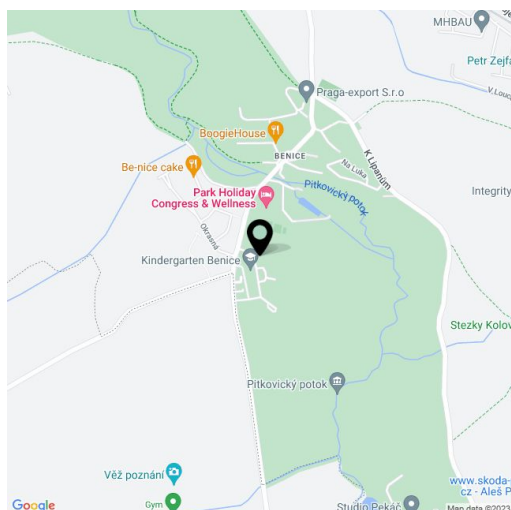



# House Six-bedroom (7+1)

382 m<sup>2</sup>, Prague 10, Benice, Žitavská

Sold

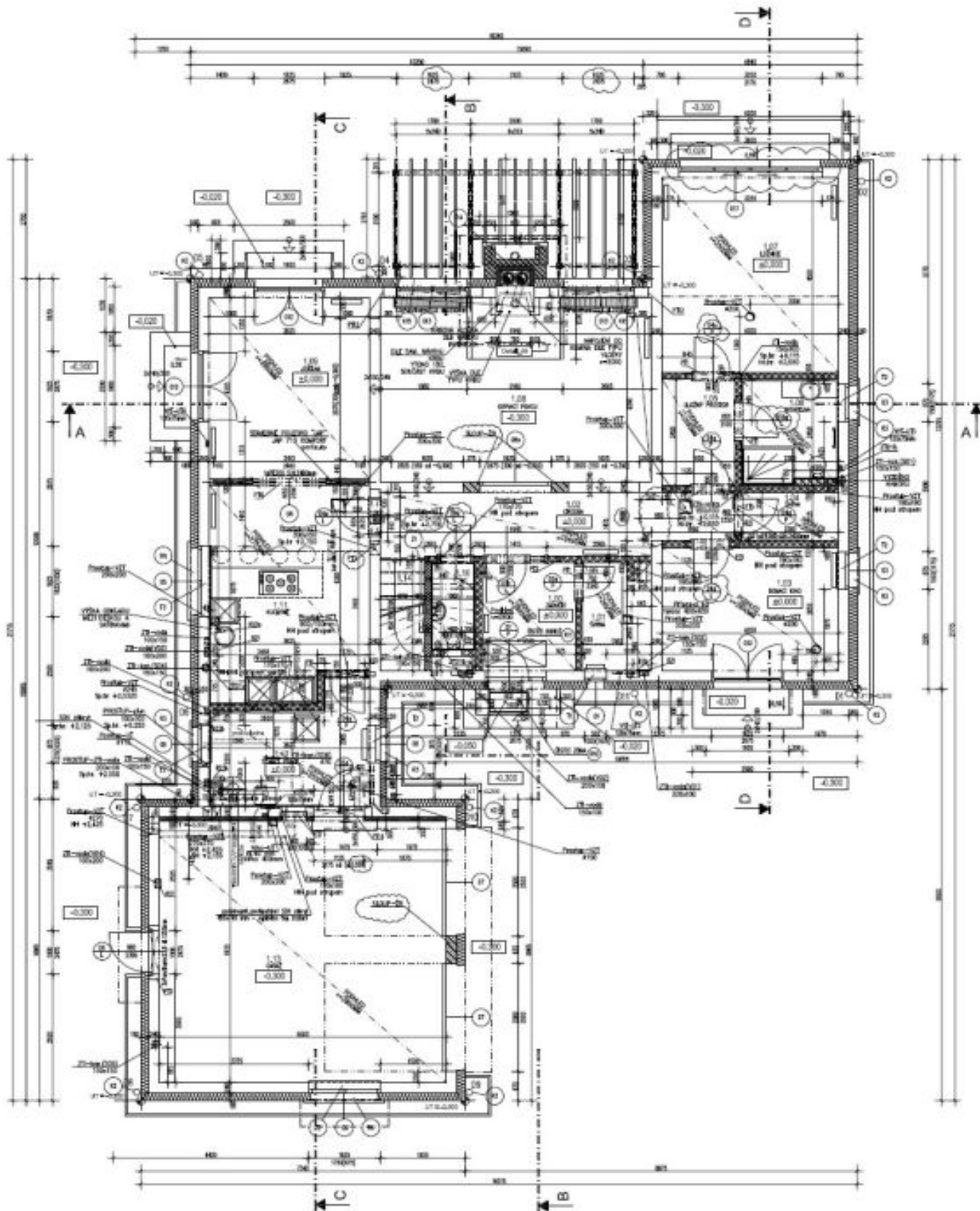



# House Six-bedroom (7+1)

382 m<sup>2</sup>, Prague 10, Benice, Žitavská

**Sold**

