

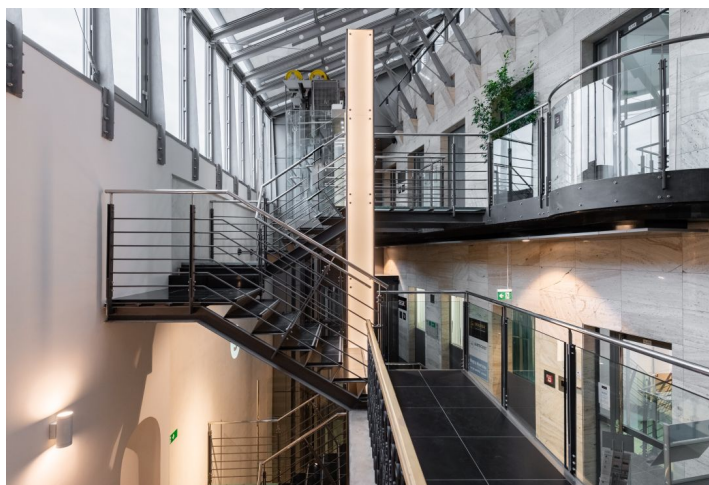

Office building

€ 23.00 / m² | CZK 579 / m²

849 m², Prague 1, Staré Město, Na Příkopě

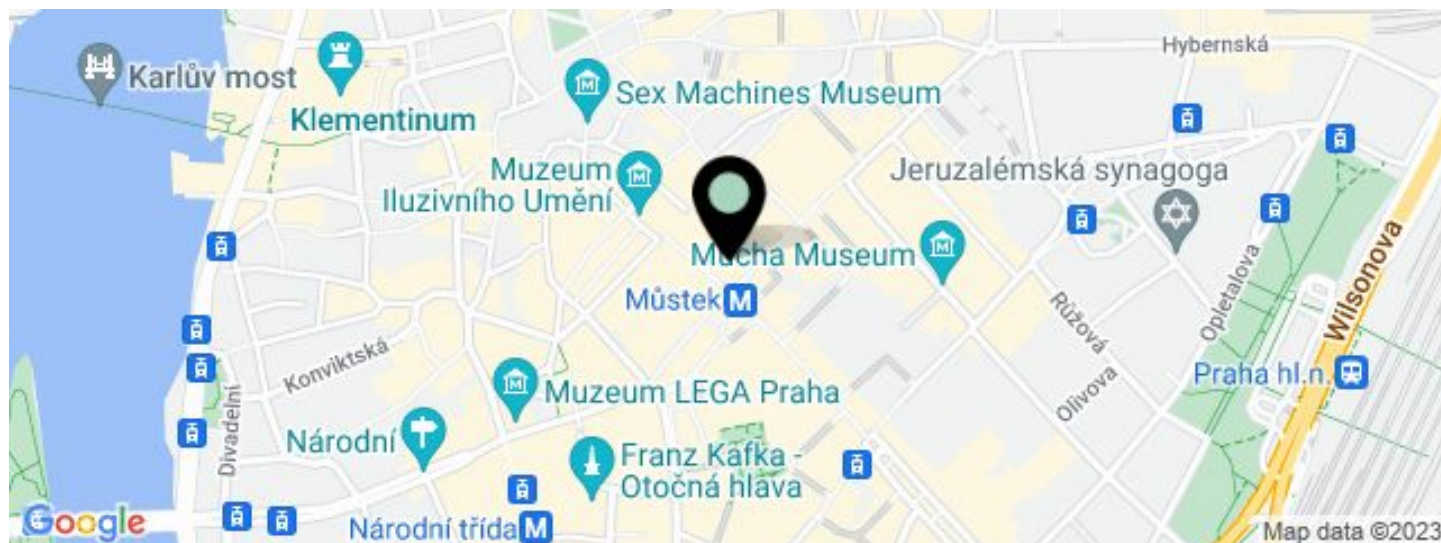

**Office building****€ 23.00 / m² | CZK 579 / m²**849 m², Prague 1, Staré Město, Na Příkopě

UNIT	AVAILABLE AREA	SERVICES	PARKING	MONTHLY RENT
Office space, 3rd floor	137 m ²	170 CZK monthly per m ²	EUR 180 / pp / month	€ 23 / m ²
Office space, 2nd floor	82 - 206 m ²	170 CZK monthly per m ²	EUR 180 / pp / month	€ 23 / m ²
Office space, 1st floor	420 m ²	170 CZK monthly per m ²	EUR 180 / pp / month	€ 23 / m ²



Office building

849 m², Prague 1, Staré Město, Na Příkopě

€ 23.00 / m² | CZK 579 / m²

Service price	170 CZK monthly per m ²
Total building area	2 577 m ²
Tenant consumption	—
Parking	180 EUR
Parking service charges	—
Parking ratio	—
Certification	—
PENB	D
Reference number	17501

Office building situated at the most prestigious business address in Prague offers office space for lease. The building was created by converting and joining two houses from the years 1893 and 1865, and successfully combines classic and modern styles. It was possible to retain the historic facades and a large part of the Classicist inner rooms, combining them with new spaces. The round steel extension and extensive glazing allows for beautiful views of Prague's Old Town. It is the work of SHArchitects in cooperation with the organization for cultural heritage and monument preservation and won the prestigious "Interior of the Year" prize in 1997. Possibility of 1 parking space for every 150 sq. m of leasable area.

Location:

Easy access by public transport - the Náměstí Republiky (line B) and Můstek (line A, B) metro stations and tram stops are only a few minutes' walk away.

Features and Services:

- Reception
- Atrium
- Modern glass lifts
- Magnetic card access
- Openable windows
- Air conditioning
- Parking

Rental and service charges are listed without VAT. Lessee pays no commission.