

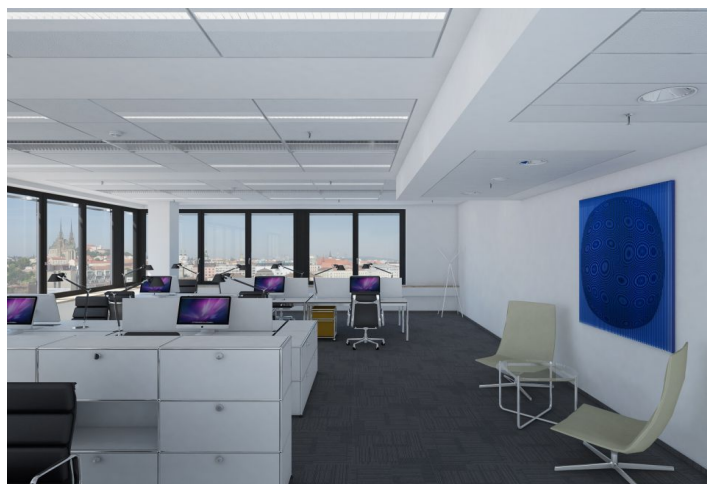

Office building

Rented

Brno-město, Brno - střed, Dornych





Office building

Brno-město, Brno - střed, Dornych

Rented

Total building area	8 595 m ²
Tenant consumption	—
Parking	157 park spaces
Parking service charges	—
Parking ratio	—
Certification	—
PENB	G
Reference number	19973

The polyfunctional building is a thirteen-floor structure built on the corner of Dornych and Plotní streets, directly next to the Vaňkovka shopping center. The building was built according to the project of the architectural group RAW and functionally is divided into two parts: an office building and a multi-level car park. The complex offers in total 8.500 sq.m of retail and office premises, parking is ensured in the building's onsite garage.

Location:

The building is located in the center of Brno, just between the train station and bus station, next to the Vaňkovka shopping center. The highway is reachable in 5 minutes by car.

Features and services:

- energy certificate A (exceptionally energy-saving)
- artificial light by means of LED technology
- 24/7 serviced reception and security service
- park adjustment of the area in front of the building
- use of highest quality materials in both interior and exterior
- controlled access to the building - electronic chip system
- in basement facilities for cyclists (changing rooms, showers, bicycle stands)

Rental price **4.500 CZK/sq.m/year**. Rental and service charges listed without VAT.

Other charges: media (water/sewer charges, electricity, heating/cooling, compulsory air exchange incl. moistening), running costs.