

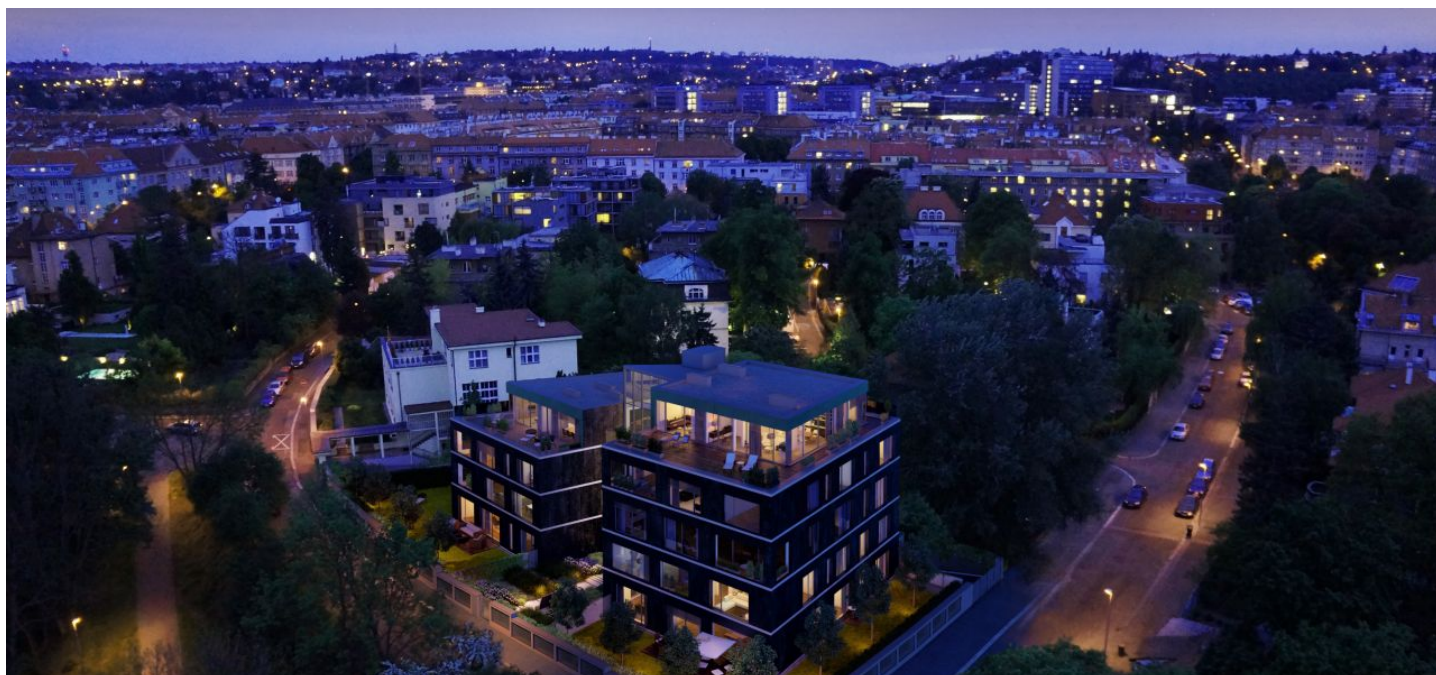

Apartment Three-bedroom (4+kk)

Sold

184 m², Praha 6, Bubeneč, Na Marně





Apartment Three-bedroom (4+kk)

Sold184 m², Praha 6, Bubeneč, Na Marně

Total area	198 m ²
Floor area*	184 m ²
Loggia	14 m ²
Parking	2 garage parking spaces included in the price
Garage	Yes
Cellar	Yes
PENB	B
Reference number	19990

Benefitting from a large loggia and floor-to-ceiling windows with views of the adjacent park, this high standard 3-bedroom apartment is part of the Villa Atrium Bubeneč, a modern project consisting of two elegant glazed buildings featuring only 10 residential units, set in a pleasant, quiet corner of the prestigious residential quarter of Prague 6. Timeless design, top quality fittings and a sought after address rank these apartments among the best of contemporary housing. Completion scheduled for the end of 2016.

Occupying the entire 2nd floor, the flat is dominated by a spacious living room with a kitchen, dining area and access to loggia; it also offers 3 bedrooms (one of them with en-suite bathroom and walk-in wardrobe), common bathroom, entrance hall with guest toilet and storage room/room for housework.

Equipment to include **air-conditioning**, Bauwerk massive hardwood floors, Porcelaingres tiles, **triple-glazed aluminum windows**, aluminum shutters with electric control, **Dornbracht**, Hüppe or Laufen bathroom fixtures, underfloor heating, **interior doors with internal hinges**, security door, videophone. Benefitting from the layout with **mostly only one apartment occupying each floor**, the residence will provide maximum comfort and privacy. The purchase price of each unit includes a **cellar** and up to **3 garage parking spaces**.

Bubeneč rightfully belongs to the most popular of Prague's residential areas. In addition to the pleasant and peaceful atmosphere with a number of beautiful parks, such as the **nearby Královská obora Stromovka and Letná**, the location offers excellent connections to the city center and easy access to the Letiště Václava Havla airport. Complete amenities including nurseries, schools, restaurants, cafes and sports clubs just a few minutes walk from the house.

Interior 184.4 m², loggia 13.5 m², 2 garage parking spaces, basement.

August 2015 - Construction started

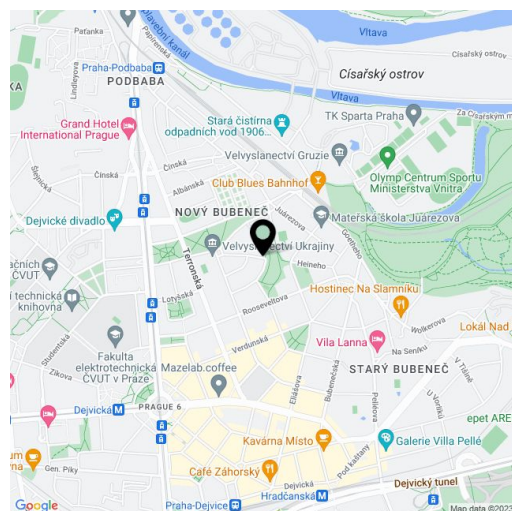

* Area of the unit according to the Civil Code. The area consists of the sum total area of the entire unit bounded by perimeter walls.



Apartment Three-bedroom (4+kk)

184 m², Praha 6, Bubeneč, Na Marně

Sold







BYT 6 3.NP

4 +KK 184,4 M²

6.01	VSTUP, HALA	30,6 M ²
6.02	WC	2,6 M ²
6.03	SÁTNA	6,6 M ²
6.04	OBÝVAČÍ POKOJ	38,5 M ²
6.05	JÍDELNA, KUCHYŇ	28,9 M ²
6.07	POKOJ	17,5 M ²
6.08	KOUPELNA	9,8 M ²
6.09	POKOJ	18,7 M ²
6.10	POKOJ	18,7 M ²
6.11	KOUPELNA	5,8 M ²
6.12	SÁTNA	4,8 M ²
BYT		184,4 M ²
6.06	LODŽIE	13,5 M ²
CELKEM BYT		197,9 M ²



Uvedená výměry jsou orientační, zohledňují měřič. Všechny záznamy korigují se k datu měření a není soudně způsobilé.



VILLA ATRIUM BUBENEČ
 ULICE NA MARNĚ - PRAHA 6
 08. 2014 WWW.VILLATRIUMBUBENEČ.CZ