



House Five-bedroom (6+kk)

Rented

460 m², Prague 5, Jinonice, Laténská





House Five-bedroom (6+kk)

Rented460 m², Prague 5, Jinonice, Laténská

Plot	1 000 m ²
Parking	Double garage.
Garage	Yes
Cellar	Yes
Service price	Deposit for utilities incl. energy and garden maintenance CZK 20,000 per month.
PENB	G
Reference number	20429
Available from	Immediately

Comfortable, air-conditioned 5-bedroom 4-bathroom freestanding house with 3 terraces in the recently built Botanica residential project in a green neighborhood bordering the Vidoule natural park. In close vicinity of the Prokopské and Dalejské Valleys with plenty of recreational opportunities, just moments from the German School. A quiet location with full amenities close-by, within walking distance of bus stops and the Nové Butovice metro station.

Ground floor: open plan living room with a fireplace plus a fully integrated kitchen and dining area, both with terrace and garden access, shower bathroom, walk-in closet, entry hall, storage room, garage access. First floor: master bedroom with an en-suite shower bathroom, walk-in closet, large terrace, three more bedrooms, full bathroom. Second floor: spacious bedroom, shower bathroom, access to a huge roof terrace. Basement floor (140 m²): laundry room, three rooms (fitness, playroom etc.), storage.

Wooden floors and tiles, floor heating on the ground floor and in all bathrooms, exterior electric blinds, built-in wardrobes, central vacuum, satellite TV connection, Internet, alarm, automatic irrigation. Double garage.

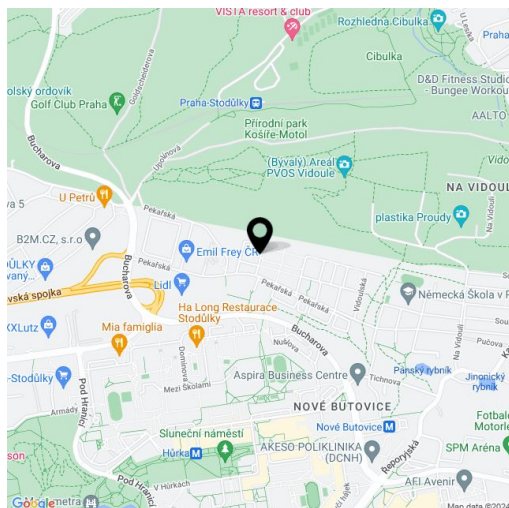



House Five-bedroom (6+kk)

460 m², Prague 5, Jinonice, Laténská

Rented

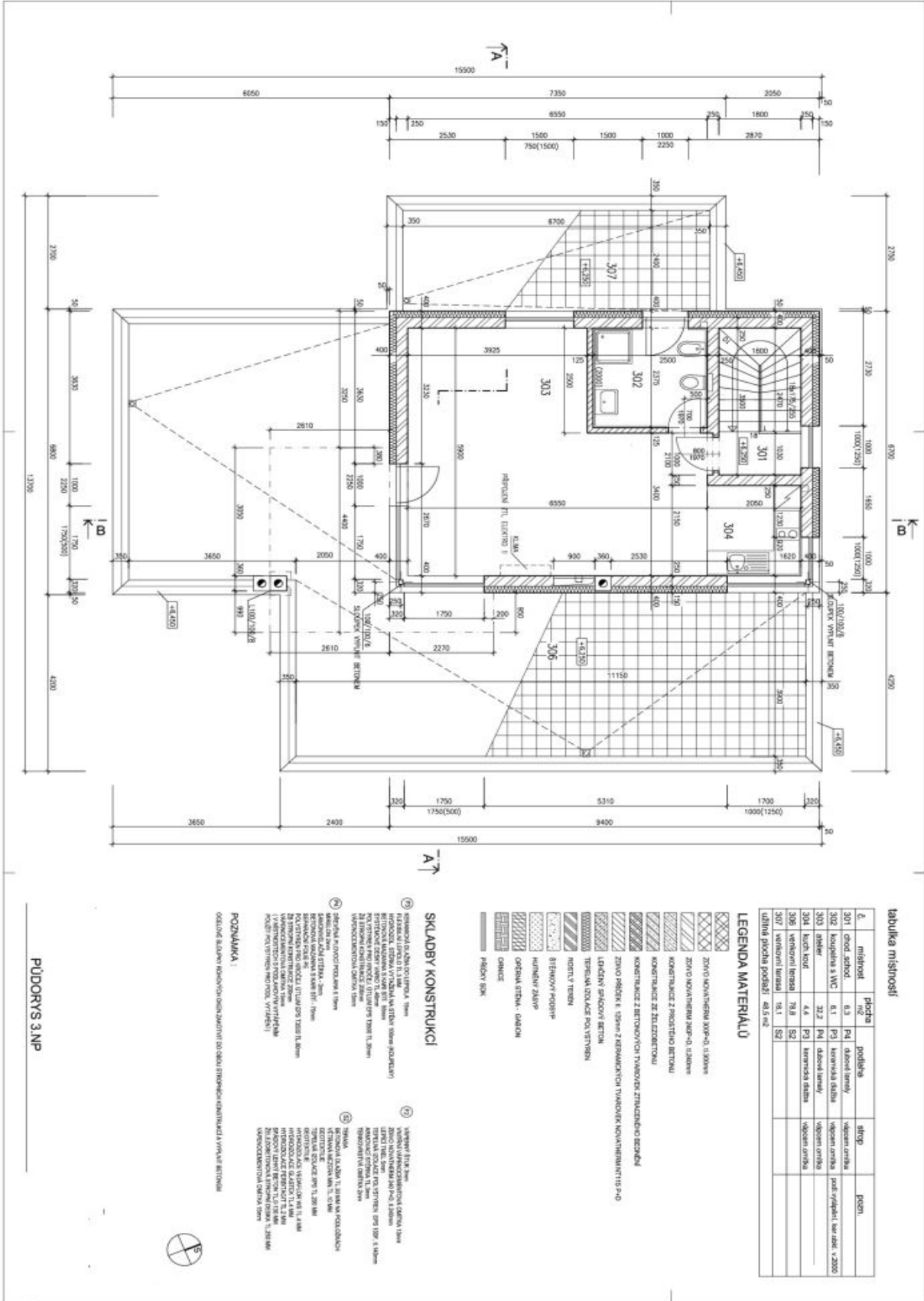



House Five-bedroom (6+kk)

460 m², Prague 5, Jinonice, Laténská

Rented

