



Apartment Studio (1+kk)

Rented

22 m², Praha 6, Bubeneč, Eliášova





Apartment Studio (1+kk)

Rented

22 m², Praha 6, Bubeneč, Eliášova

Total area	24 m ²
Floor area*	22 m ²
Balcony	2 m ²
Parking	-
Cellar	-
PENB	G
Reference number	21726
Available from	Immediately

Cozy furnished studio with a balcony on the third floor of a renovated, well kept residential building with a lift, situated in the popular neighborhood of Bubeneč, Prague 6, a few min. walk from Hradčanská and Dejvická metro stations. Highly sought after address with quick access to city center and full amenities in the area, within walking distance of the Prague Castle, and Letná and Stromovka Parks.

The studio consists of a living room / bedroom area with a balcony facing the courtyard, a fitted kitchenette in the entry hall, and shower bathroom with toilet.

Solid wood parquet and marble floors, aluminum windows, security entry door, crystal chandelier, washing machine, fridge, single plate induction cooker, microwave oven, video entry phone. Common building charges and utilities including internet CZK 2000 per month. Despite the photos the apartment is FURNISHED.

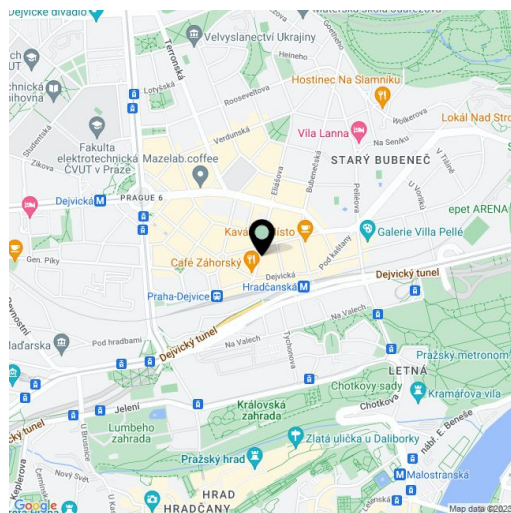

* Area of the unit according to the Civil Code. The area consists of the sum total area of the entire unit bounded by perimeter walls.

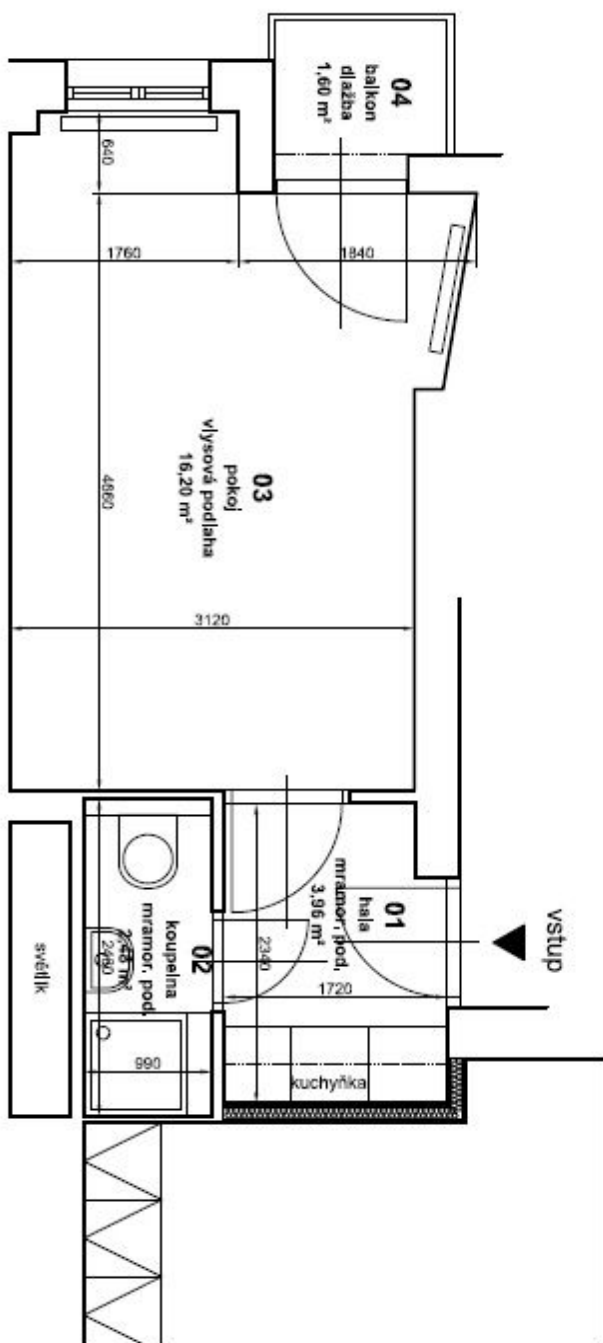

Apartment Studio (1+kk)

22 m², Praha 6, Bubeneč, Eliášova**Rented**

TABULKA MÍSTNOSTÍ - návrh

č.m.	název místnosti	m ²	podlaha	stěny	poznámky
01	hala	3,96	mrámor. dlažba	omítka	
02	koupelna	2,48	mrámor. dlažba	ker. obklad	
03	oboj	16,20	výs. podlaha	omítka	
04	balkon	1,60	ker. dlažba	omítka	
celkem		24,24 m ²			