



Office space

Prague 9, Horní Počernice

Ask for price





Office space

Prague 9, Horní Počernice

Ask for price

Available area	350 m ²
Cellar	-
Parking	Yes
PENB	B
Reference number	24086

350 sq.m. of office premises for lease in an industrial park situated 15 minutes from the city center (from Prague). The project consists of 28 warehouse buildings; construction of this park commenced 2006. **Land bank with potential to develop more than 45 300 sq.m. – build-to-suit project delivery within 6 months.**

Location:

The industrial park is situated 15 minutes from Prague's city center, exit 3 on D10 highway (Prague – Mladá Boleslav – Germany). The park is reachable by a shuttle bus – connection to Černý Most (line B) metro station, the Horní Počernice train station is 1 km from the park.

Features and Services:

- 24/7 manned security in the area
- Park maintenance

Office:

- Flexible office layout
- Air-conditioning

Warehouse/Industrial premises:

- Flexible layout with small units from 500 sq.m. to large warehouse space up to 40 000 sq.m.
- Min.1 loading dock per 400-1000 sq.m
- Floor loading capacity 5-8 T/sq.m
- Clear height 10-12 m
- Truck yard 35-45 m
- Column grid structure 24x12 m
- Possible cross docking
- Infa-heating or heating blowers
- Sprinkler system

Rental and service charges listed without VAT. Lessee pays no commission.

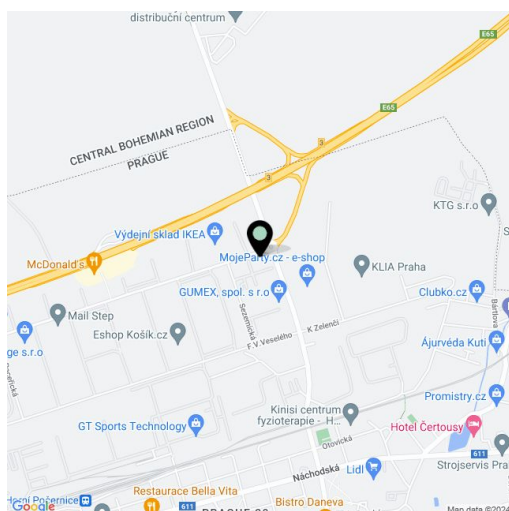

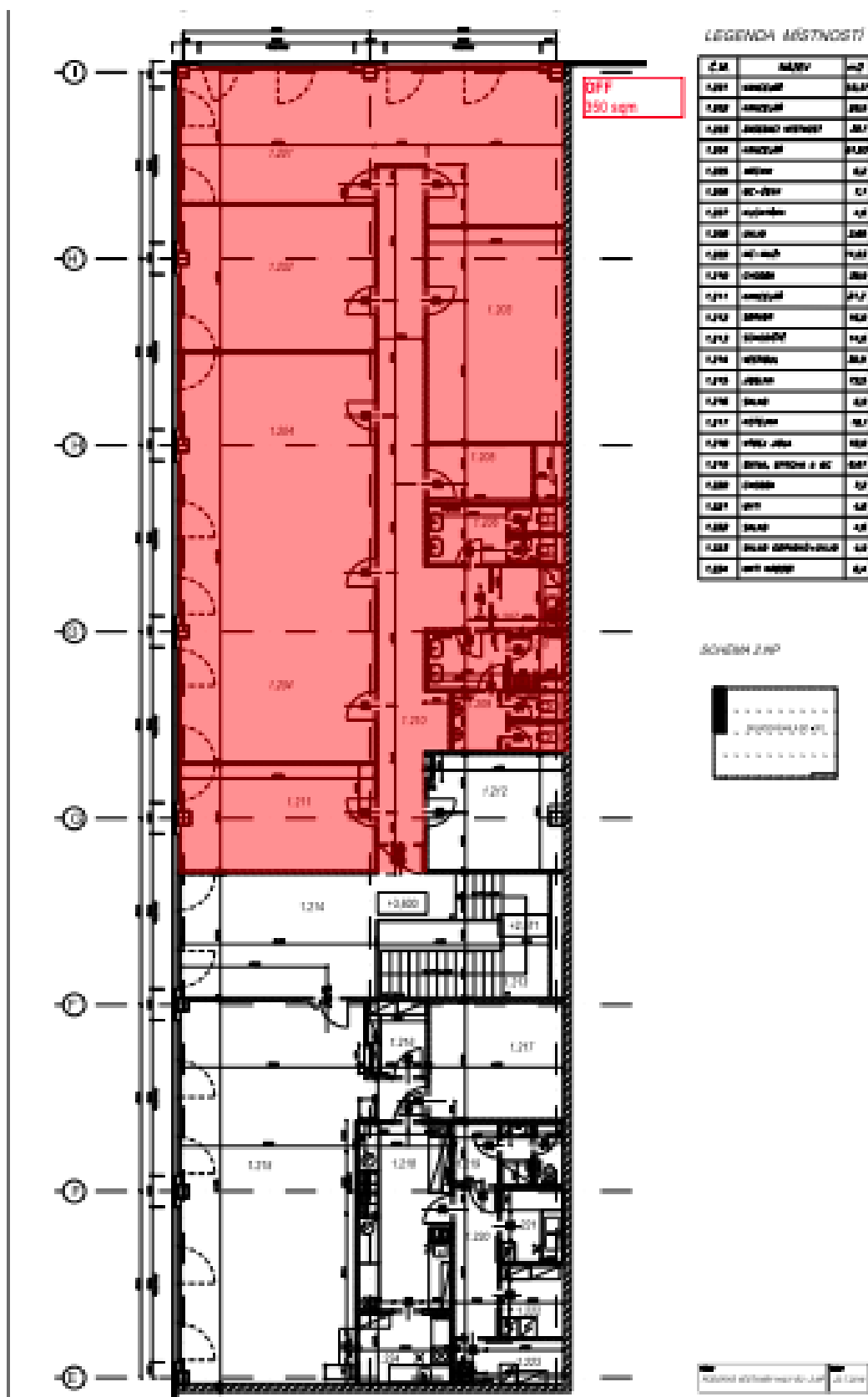



Office space

Prague 9, Horní Počernice

Ask for price

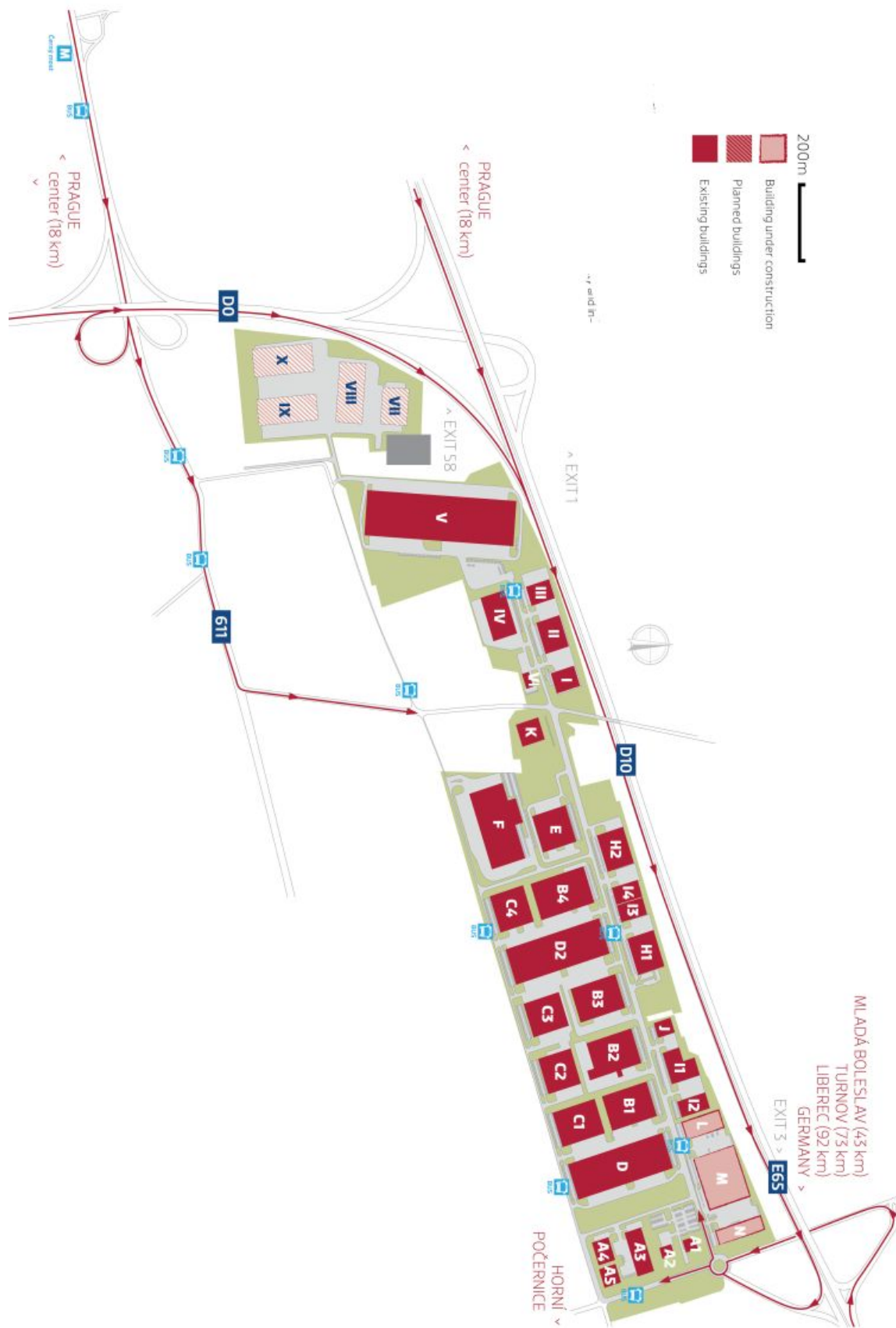



Office space

Prague 9, Horní Počernice

Ask for price

