

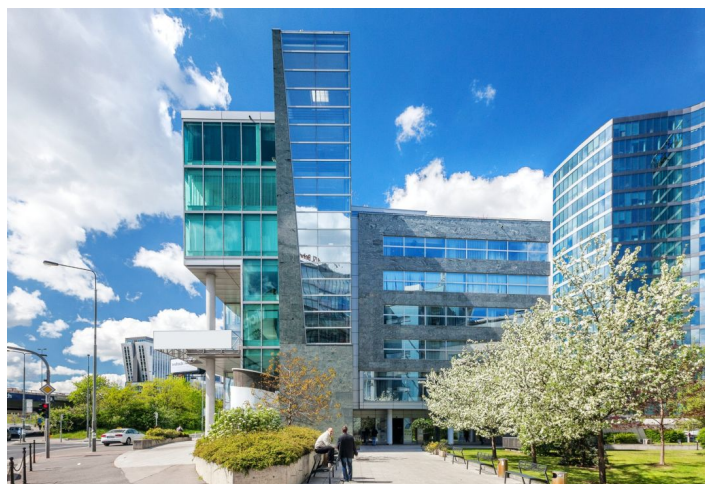

Office space

Prague 4, Michle, Vyskočilova

€ 14.90 - 15.25 / m² | CZK 375 - 384 / m²



**Office space**

Prague 4, Michle, Vyskočilova

€ 14.90 - 15.25 / m² | CZK 375 - 384 / m²

Service price	105 CZK monthly per m ²
Available area	1 727 m ²
Cellar	-
Parking	EUR 115 / ps / month
PENB	A
Reference number	25017

Office space for lease in an administrative building situated in the business district of Prague 4, designed by Czech architect Jan Aulík. The seven-storey building offers more than 12,000 m² of high-quality office and retail space and ample underground parking.

Location:

Very good accessibility by car and public transport – Budějovická and Kačerov metro stations (line C) are just 2 minutes by bus or 8 minutes on foot. A shuttle bus connects the building with the metro stations. Easy access to Prague's city ring and to the D1 highway leading to Brno.

Features and Services:

- 24/7 Access
- Access Control
- Air Conditioning
- Can be divided
- Flexible floorplan
- Floorplan greater than 2000 sqm
- Green Certification
- Monitoring
- Openable Windows
- Outdoor shades
- Parking
- Raised Floor
- Reception
- Security
- Ventilation

Rental and service charges listed without VAT. Lessee pays no commission.

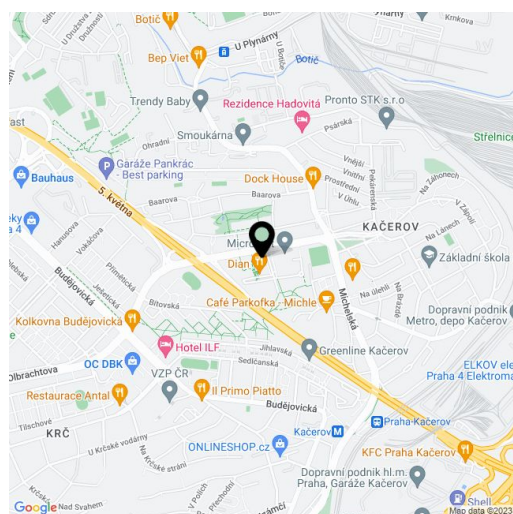

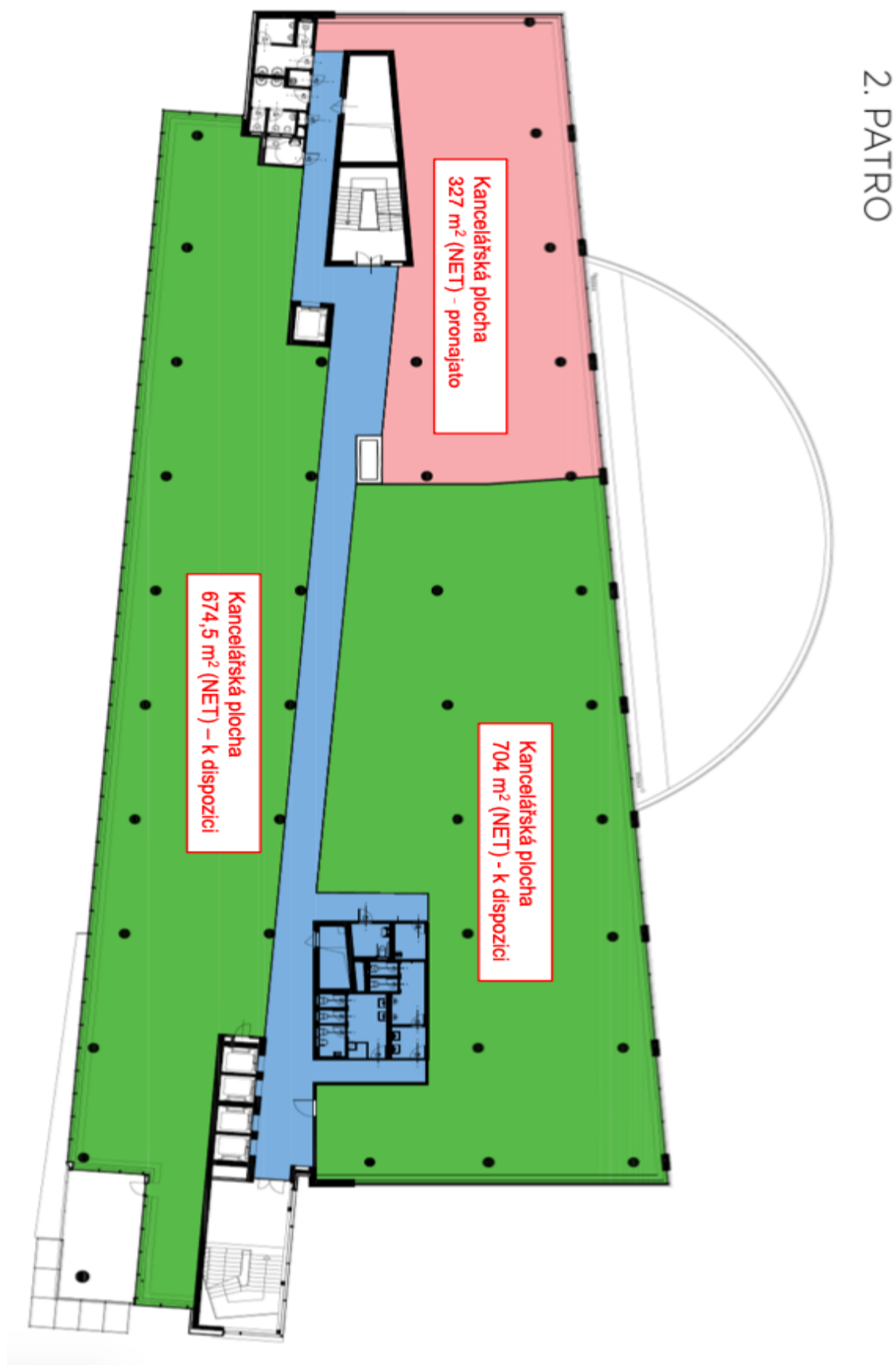

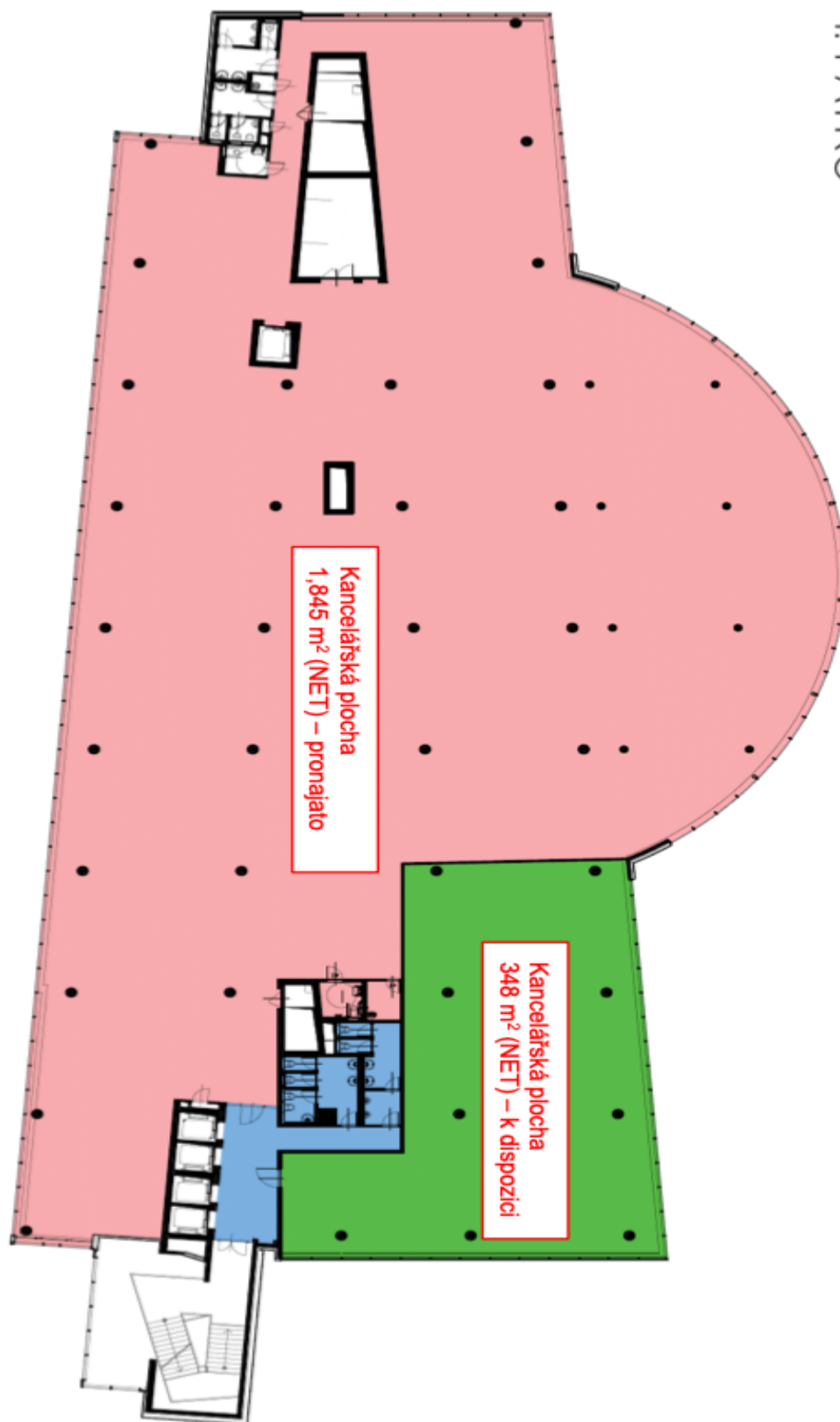

1. PATRO