



Apartment Three-bedroom (4+kk)

Rented

133 m², Prague 5, Smichov, Kobrova





Apartment Three-bedroom (4+kk)

Rented133 m², Prague 5, Smíchov, Kobrova

Total area	139 m ²
Floor area*	133 m ²
Balcony	6 m ²
Parking	Garage parking.
Garage	Yes
Cellar	Yes
PENB	C
Reference number	25279
Available from	Immediately

High quality 3-bedroom 2-bathroom flat with a balcony and far reaching views, situated on the third floor of the modern project Residence Sacre Coeur 2. Located in Hřebenky, a highly sought after residential area in close vicinity of the Kinského Garden, Petřín hill and Nový Smíchov shopping and entertainment center. The residence offers 24-hour reception with security and underground garage parking. Quiet area with bus connections, convenient to Újezd trams, Anděl metro, and the French School, quick access to the city center. Bus stop in front of the building, direct connection to the airport.

The sunny interior features a spacious living room with a fully fitted open kitchen and balcony with views of Prague, three separate bedrooms overlooking the landscaped courtyard, en-suite bathroom (walk-in shower, sink, toilet), family bathroom (bathtub, double sink, toilet), laundry room, guest toilet, and entrance hall with built-in wardrobes and storage.

Wooden floors, large format tiles, security entry door, oversized French windows, floor heating, built-in storage, dishwasher, cellar, chip entry. One garage parking space included. Common building charges, water and heating CZK 8,200/month. Electricity is billed separately. Available from May 2021.

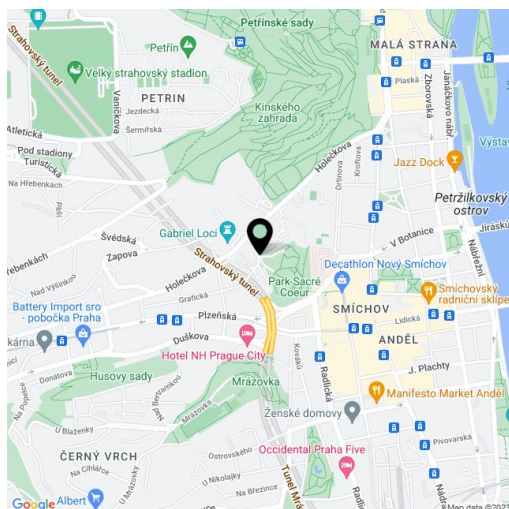

* Area of the unit according to the Civil Code. The area consists of the sum total area of the entire unit bounded by perimeter walls.



Apartment Three-bedroom (4+kk)

133 m², Prague 5, Smíchov, Kobrova

Rented

SACRE COEUR 2 | F3.1 | 4+kk | 3. podlaží
 developer: společnost SATPO

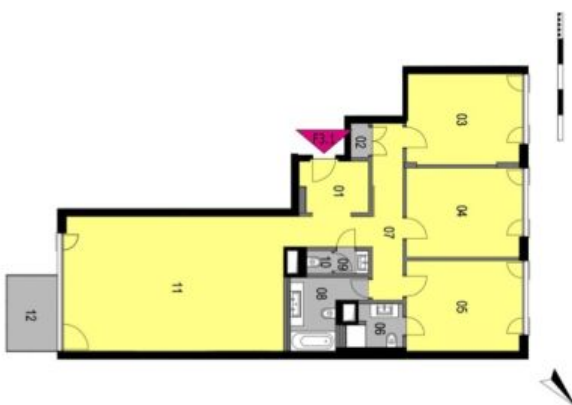

cena vč. DPH: na vyžádání	
místnost	m ²
01 vstupní hala	5,4 m ²
02 komora	1,1 m ²
03 pokoj	16,0 m ²
04 pokoj	15,9 m ²
05 ložnice	16,3 m ²
06 koupelna	3,7 m ²
07 chodba	9,0 m ²
08 koupelna	6,6 m ²
09 předstíh WC	1,3 m ²
10 WC	1,0 m ²
11 obývací pokoj + KK	50,6 m ²
průčky, sloupy a šachty	5,9 m ²
obývací plocha	132,8 m ²
00 sklep	6,7 m ²
užitná plocha	139,5 m ²
12 balkon	6,0 m ²
celková plocha	145,5 m ²
garáže, sklepy, sklady	
sklep	S02.05
garážové stání	G02.106



Příloha č.3

Udaje platné ke dni: **10.05.2016** | Společnost SATPO si vyhrazuje právo změny. Veškeré materiály a informace jsou pouze orientační. V uvedených plochách jednotek jsou započítány plochy přístřešků, schodišť a stoupač v souladu s výškovým měřítkem 386/2013 Sb.

www.satpo.cz

mimořádná místa pro život

SATPO