



House Four-bedroom (5+1)

220 m², Praha 6, Suchdol, Nad Dolíky

Rented





House Four-bedroom (5+1)

Rented220 m², Praha 6, Suchdol, Nad Dolíky

| | |
|------------------|---------------------------------|
| Total area | 220 m ² |
| Plot | 433 m ² |
| Floor area | 207 m ² |
| Terrace | 13 m ² |
| Parking | Garage and parking on the plot. |
| Garage | Yes |
| Cellar | - |
| PENB | G |
| Reference number | 25733 |
| Available from | Immediately |

This three-story 4-bedroom 2-bathroom semidetached house with 2 terraces and a small garden located in a quiet green residential neighborhood in Suchdol, Prague 6. Location with quick access to amenities and the city center, the airport, the Riverside School and the International School of Prague. Set in a slope, the house offers beautiful green views of the adjacent valley.

Upper floor: fully fitted kitchen with dining area and pantry, walk-in closet, guest toilet, garage access, entrance hall. Middle floor: living room with a **terrace**, one bedroom, bathroom with bathtub, walk-in shower and toilet, utility room. Ground floor: three bedrooms - one with a walk-in closet and one with **terrace and garden** access, shower bathroom with toilet, storage room.

Tile and laminated floors, underfloor heating on the upper floor, wooden stairs, large windows, blinds, built-in wardrobes, gas boiler, washer, dryer, dishwasher, microwave oven, alarm. **Garage plus parking in front of the garage.** Utilities around CZK 6000 per month.

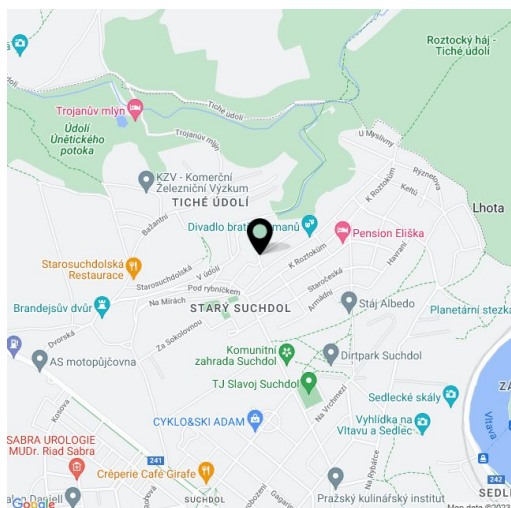



House Four-bedroom (5+1)

220 m², Praha 6, Suchdol, Nad Dolíky

Rented

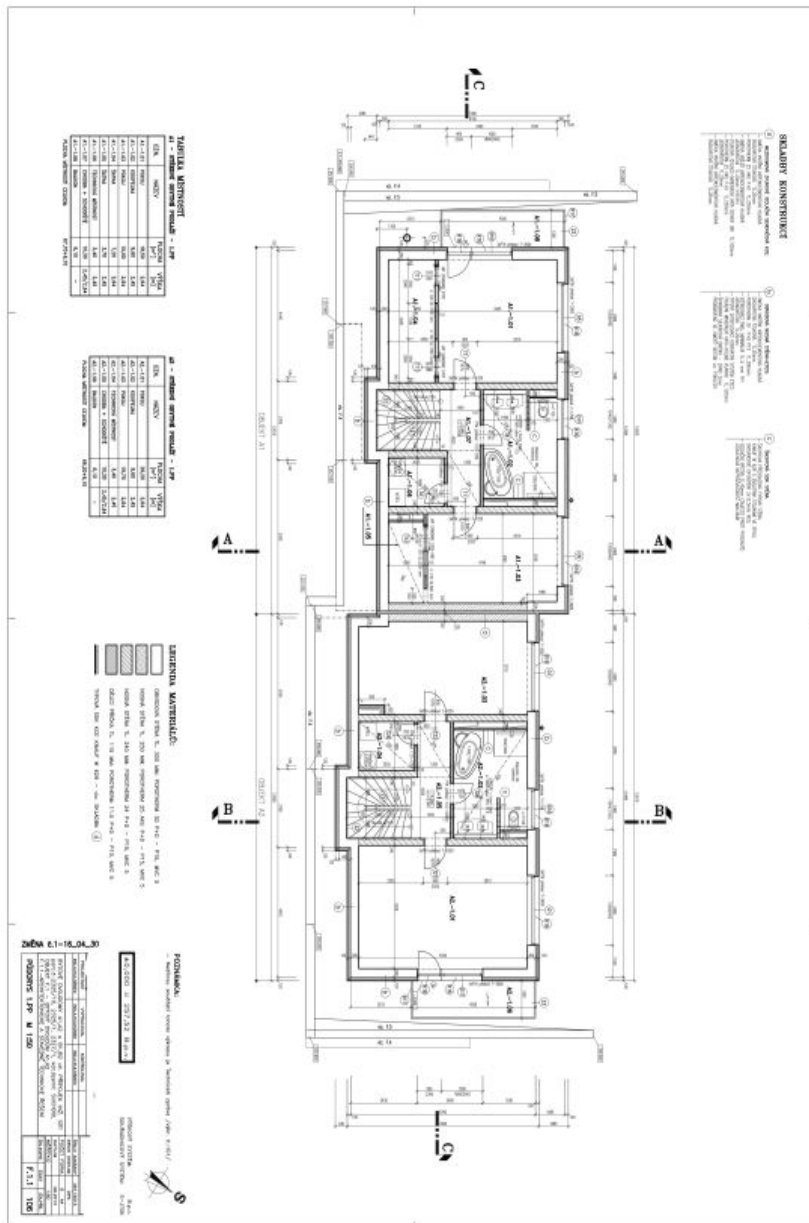



House Four-bedroom (5+1)

220 m², Praha 6, Suchdol, Nad Dolíky

Rented

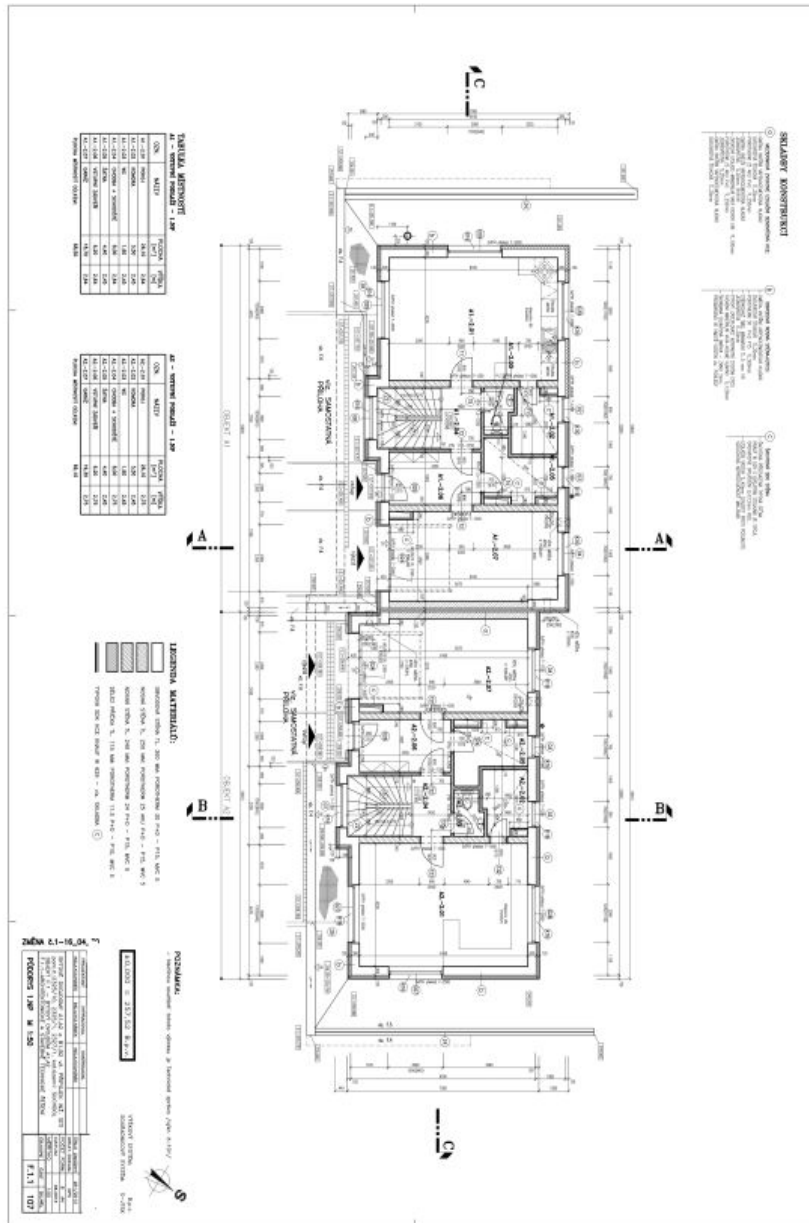



House Four-bedroom (5+1)

220 m², Praha 6, Suchdol, Nad Dolíky

Rented

