

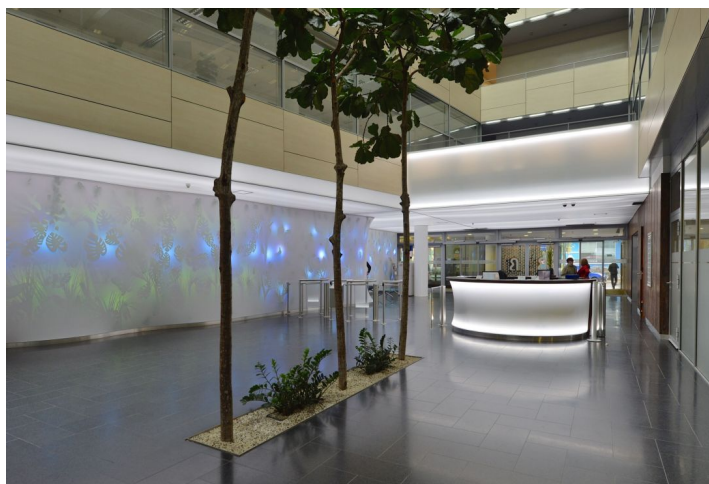

Office space

Prague 4, Michle, Vyskočilova

€ 17.00 / m² | CZK 427 / m²

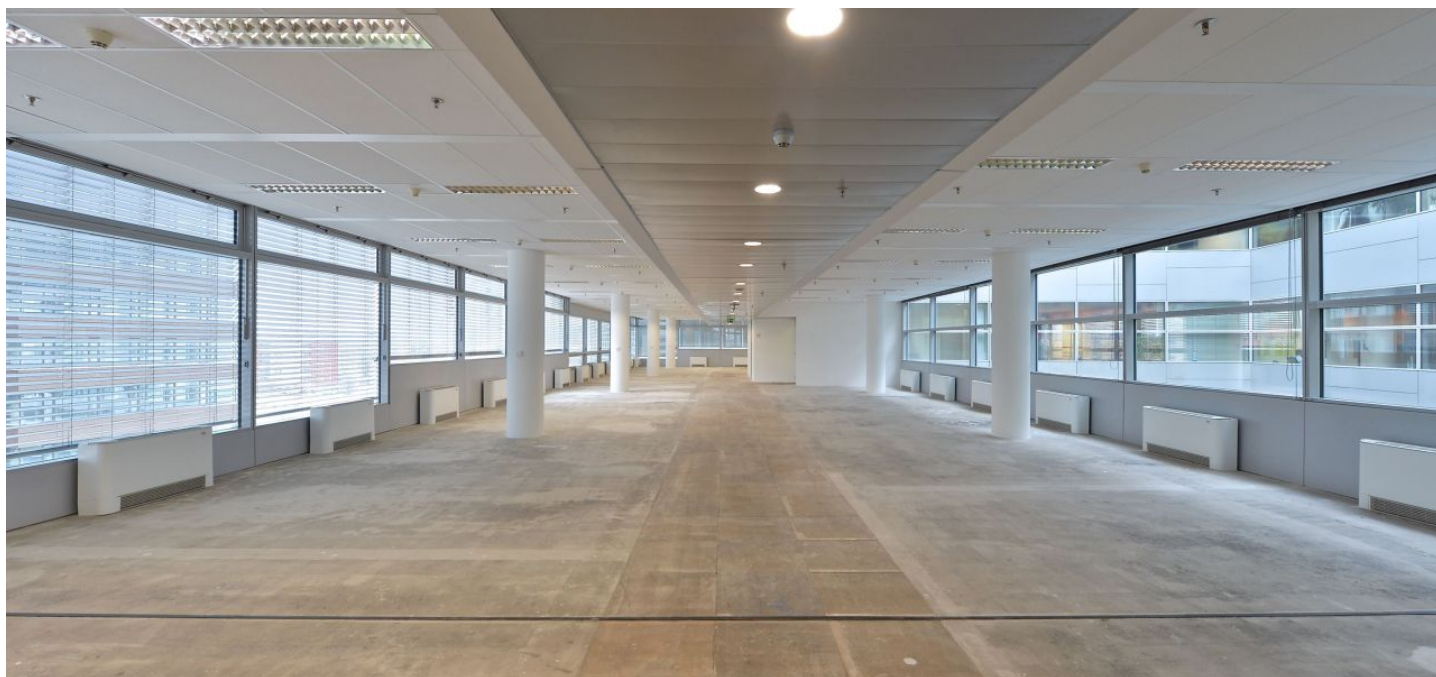

**Office space**

Prague 4, Michle, Vyskočilova

€ 17.00 / m² | CZK 427 / m²

Service price	133 CZK monthly per m ²
Available area	748 m ²
Cellar	-
Parking	EUR 125 / ps / month
PENB	D
Reference number	26208

The modern office building, originating from the workshop of the architectural studio Aulík Fišer, offers the rental of quality Class A office space in Prague 4. These can be used as an open plan, separate office units or a combination of both options together. The building, completed in 2005, also offers all tenants a roof terrace accessible with excellent views of Prague. BREEAM certification at the Very Good level.

Location:

The metro station Budějovická (line C) is connected to free shuttle buses and is only a 5-minute walk away. There is also a public transport stop in front of the building. Another benefit is the immediate connection to the North-South motorway and the D1 motorway connecting Prague with Brno, Budapest and Vienna.

Features and Services:

- Representative reception
- CCTV and electronic security system
- 24/7 security service and access
- Access card system
- Modern elevators
- Extensive Canteen
- Café, restaurant, coffee shop and fitness center within BB Centrum
- Roof terrace accessible to all tenants

Images might not accurately reflect the current state of the premises.

Rental and service charges listed without VAT. Lessee pays no commission.

