



Apartment One-bedroom (2+1)

Rented

67 m², Praha 5, Smíchov, Na Bělidle





Apartment One-bedroom (2+1)

Rented

67 m², Praha 5, Smíchov, Na Bělidle

Total area	67 m ²
Parking	-
Cellar	-
PENB	G
Reference number	27513
Available from	Immediately

This completely refurbished 1-bedroom apartment is on the fourth floor of a well kept, renovated traditional building with no lift situated just steps from the Vltava river. Conveniently located within walking distance of the Nový Smíchov commercial and entertainment center, Anděl metro station and multiple tram links. Safe and quiet living with great connection to the city center.

The interior includes a fully fitted kitchen with a dining area, a bright living room, a bedroom with a **walk-in closet**, a shower room, a walk-through **walk-in closet**, a separate toilet, and an entrance hall with built-in storage.

New kitchen, high ceilings, **solid wood parquet floors**, **granite tiling**, security entry door, blinds, gas boiler, washing machine, dishwasher, Astra satellite connection, independent energy meters, balcony on the mezzanine floor of the building. A **shared back yard garden** is available to the tenants. Deposit for service charges and utilities: CZK 3500 per month.

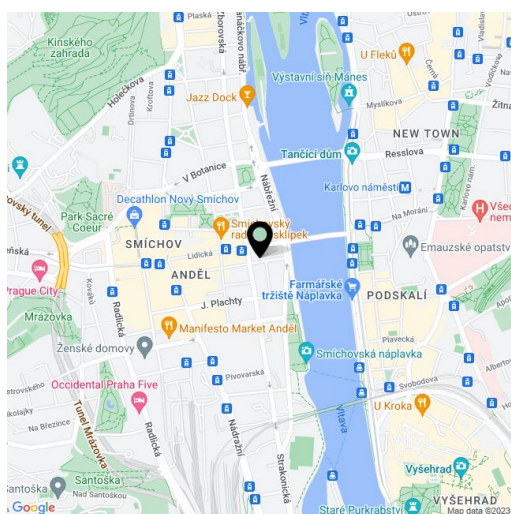

* Area of the unit according to the Civil Code. The area consists of the sum total area of the entire unit bounded by perimeter walls.



Apartment One-bedroom (2+1)

67 m², Praha 5, Smíchov, Na Bělidle

Rented

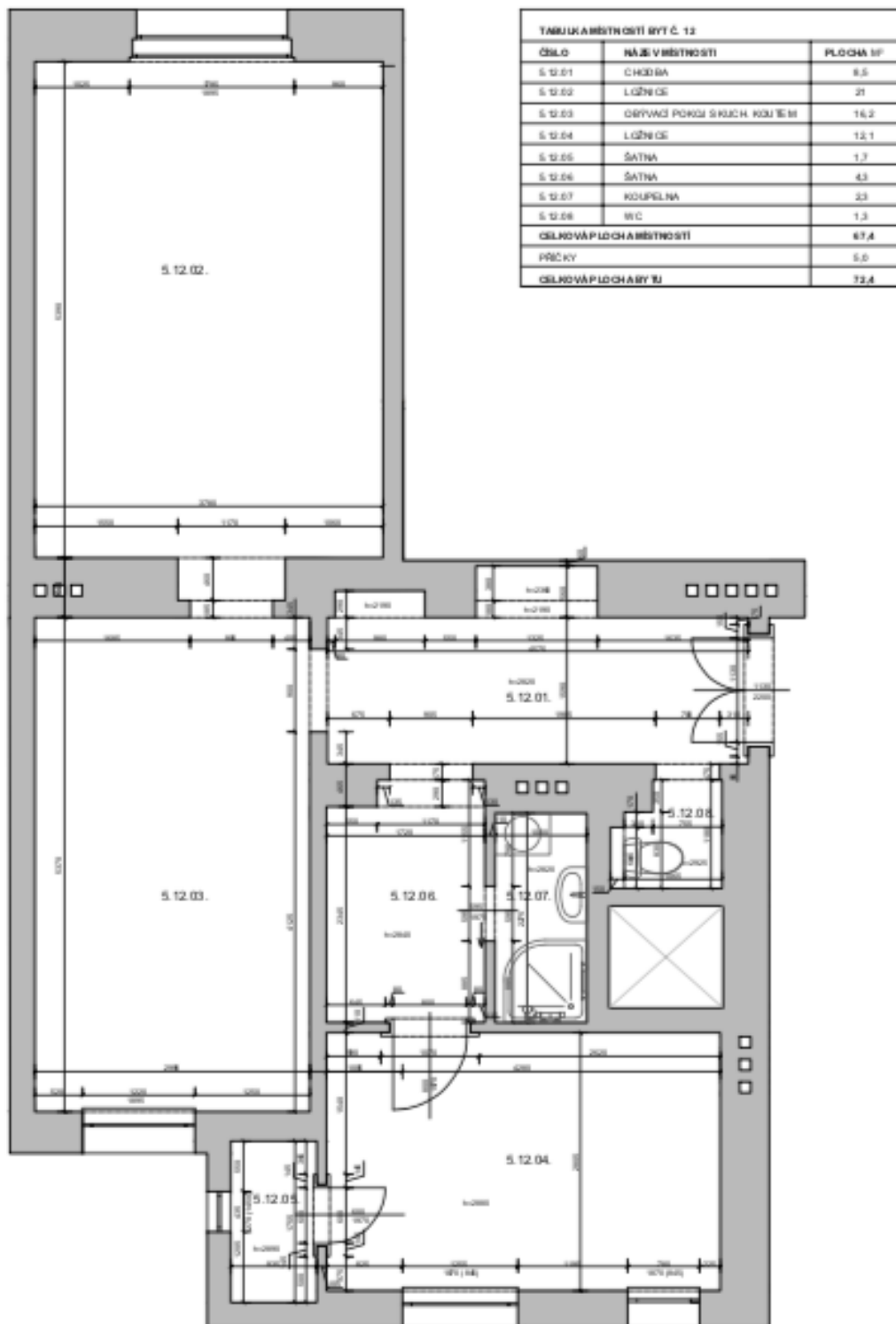

TABULKA MĚSTNOSTI BYT Č. 12		
ČÍSLO	NÁZEV MĚSTNOSTI	PLOCHA M ²
S. 12.01	CHODBA	8,5
S. 12.02	LŽIŤNICE	21
S. 12.03	OBYVACÍ POKOJ S KUCH. KOUZLEM	16,2
S. 12.04	LŽIŤNICE	12,1
S. 12.05	SÁŤNA	1,7
S. 12.06	SÁŤNA	4,3
S. 12.07	KOUPELNA	2,3
S. 12.08	WC	1,3
CELKOVÁ PLOCHA MĚSTNOSTI		67,4
PRÍKRY		5,0
CELKOVÁ PLOCHA BYTŮ		72,4