



Retail space

Praha-západ, Libčice nad Vltavou, Areál Šroubáren

Ask for price





Praha-západ, Libčice nad Vltavou, Areál Šroubáren

Available area	1 390 m ²
Min. area	550 m ²
Parking	Yes
PENB	C
Reference number	27725

Atypical non-residential space for lease in a former boiler building situated in the industrial complex of Šroubárna Libčice, northwest of Prague. The building was built at the turn of the 19th and 20th centuries from bricks of the renowned Fischer brand. At present, it is being sensitively renovated, with emphasis on the preservation of the original form of the building.

The recently finished reconstruction of the building is the work of the Hoffman architectural studio. This atelier also successfully revitalized the adjacent building, the Coal Mill, which was awarded the national prize for the Grand Prix Architecture 2013.

The complex of approx. 1,400 m² consists of two interconnected buildings, suitable, for example, for a restaurant and event room. The main industrial style building is designed as an open space and is followed by a second two-story building.

Location:

The complex is located in the village of Libčice, northwest of Prague, on the banks of the Vltava River boasting beautiful views of the river and rock formations. Close to the D8 motorway and Prague Vodochody Airport. The area is in the vicinity of the railway station and offers good connections to Prague (about 20 minutes). Cycling path along the river and the possibility of boat cruises are interesting features of this site.

Rental and service charges listed without VAT. Lessee pays no commission.

Photographer: Andrea Thiel Lhotáková

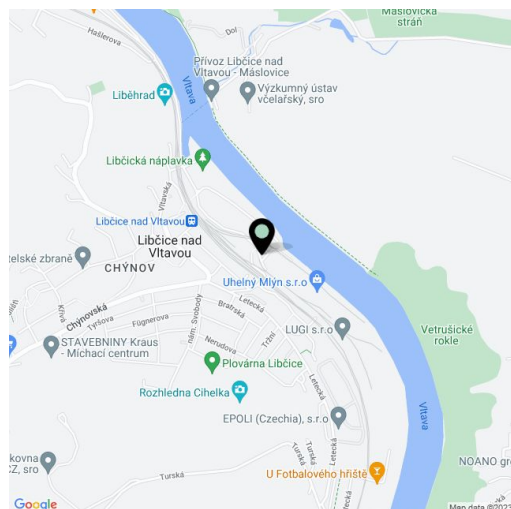

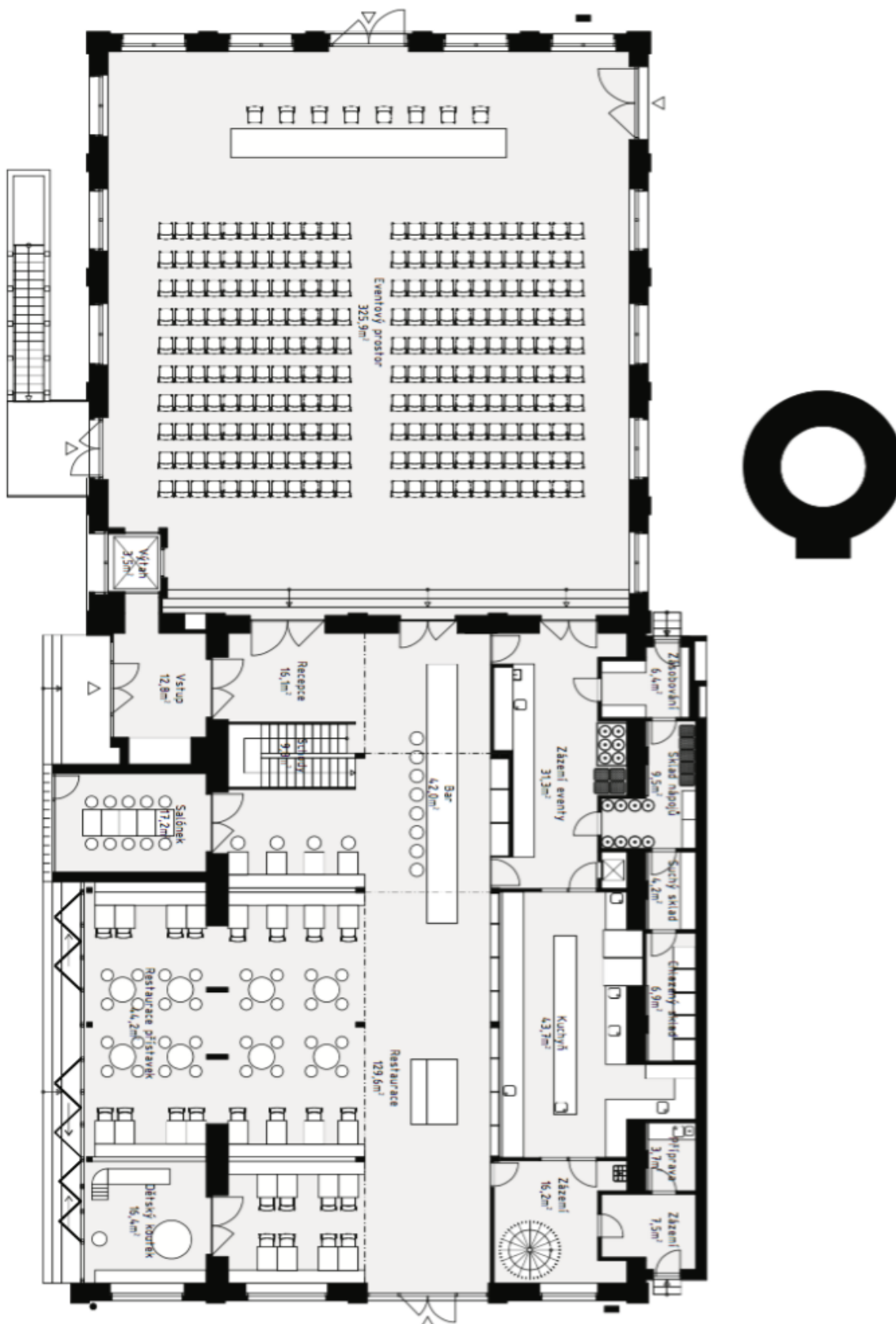



Retail space

Praha-západ, Libčice nad Vltavou, Areál Šroubáren

Ask for price

