

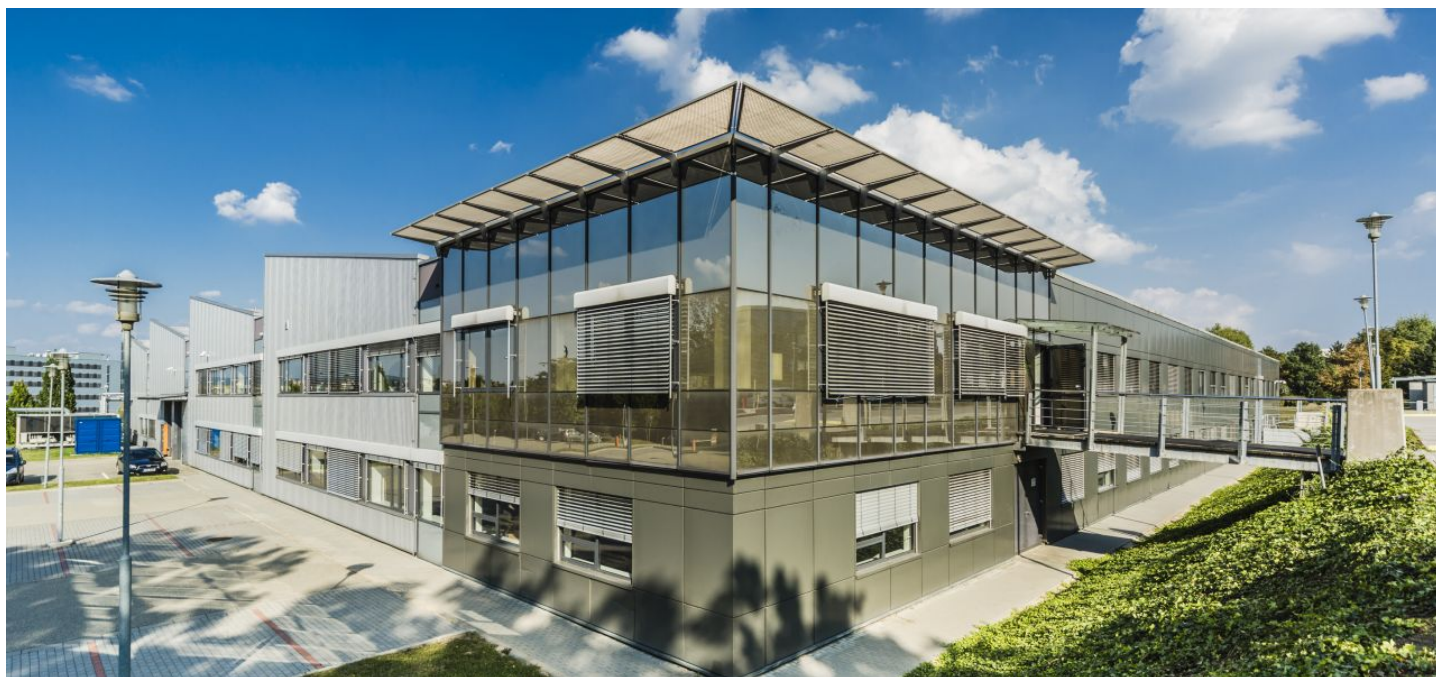

Industrial space

2 556 m², Brno-město, Brno - Královo Pole, Podnikatelská

Ask for price





Industrial space

[Ask for price](#)2 556 m², Brno-město, Brno - Královo Pole, Podnikatelská

Total area	2 556 m ²
Ceiling height	3.2 m
Floor loading capacity	20 t/m ²
Column grid structure	—
Structure	—
PENB	C
Reference number	30705

Premises for research and light industry for lease in close proximity to the Brno University of Technology.

So far, over 65,000 sq. m. of space for rent has been built, and in the final phase it will offer 190,000 sq. m. of mixed-use space for rent. The complex includes restaurants, bank branches, and a fitness center.

Location:

The B3 building is located in Zone B of the complex, located in the north of Brno, with easy access to the city ring road, the D1 highway, and R43 Brno - Svitavy. Public transport (tram, trolleybus, bus) is nearby.

Features and services:

High-speed Internet

Floor load of the production part 20 kN / sq.m.

Floor load of the storage part 40 kN / sq.m.

Net ceiling height 3,200 - 4,500 mm

Kitchenette, shower, and toilet

Underground and outdoor parking

24/7 security

Rental charges are listed without VAT. Lessee pays no commission.

