

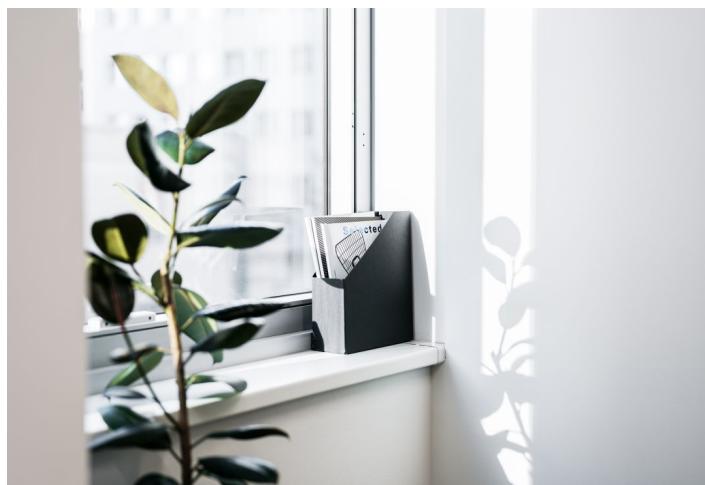

Office building

€ 18.00 - 22.00 / m² | CZK 452 - 552 / m²

1547 m², Prague 4, Nusle, Lomnického

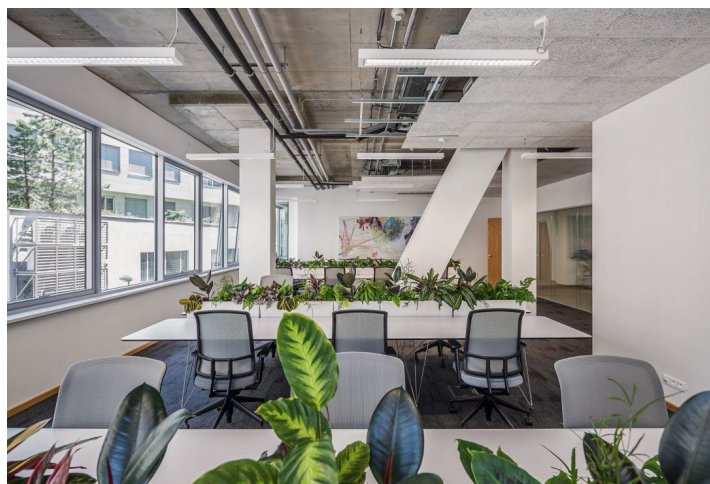

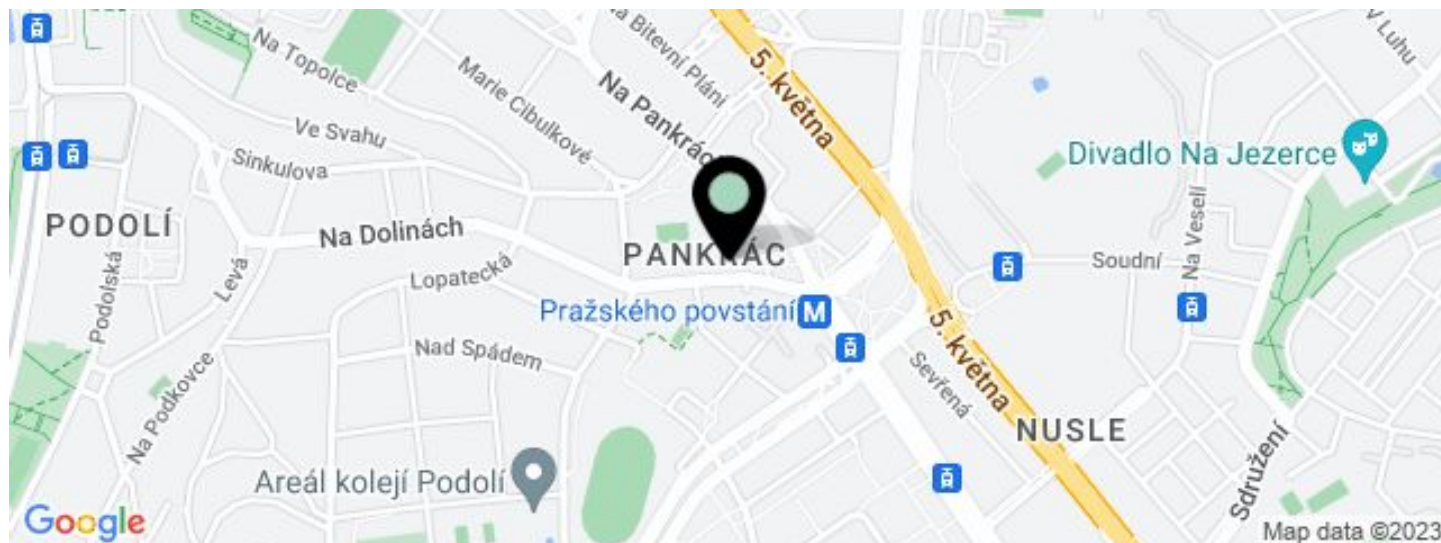
**Office building****€ 18.00 - 22.00 / m² | CZK 452 - 552 / m²**1547 m², Prague 4, Nusle, Lomnického

UNIT	AVAILABLE AREA	SERVICES	PARKING	MONTHLY RENT
serviced offices	11 - 1547 m ²	298 CZK monthly per m ²	120 EUR	€ 18 - 22 / m ²
coworking	11 - 30 m ²	298 CZK monthly per m ²	EUR 120 / ps / month	€ 18 - 22 / m ²
serviced offices	162 m ²	298 CZK monthly per m ²	120 EUR	€ 18 - 22 / m ²
serviced offices	29 m ²	298 CZK monthly per m ²	120 EUR	€ 18 - 22 / m ²



Office building

1 547 m², Prague 4, Nusle, Lomnického

€ 18.00 - 22.00 / m² | CZK 452 - 552 / m²

Service price	298 CZK monthly per m ²
Total building area	1 547 m ²
Tenant consumption	—
Parking	120 EUR
Parking service charges	—
Parking ratio	—
Certification	—
PENB	A
Reference number	31499

Shared offices (from 11 sq. m.) with flexible lease terms located in the sought-after business district of Pankrác (Prague 4), directly across the street from a metro station.

Price per person in a private office from 6,500 CZK / month incl. services and furniture.

myhive Flexi Offices are perfect for anyone looking to lease stylish, furnished offices for several days, weeks, or months. The project offers fully equipped **private offices** (from 11 sq. m. to 95 sq. m.), **coworking space**, a **pop-up office**, fully equipped **conference rooms**, and a wide spectrum of services designed to make sure your business runs smoothly. The modern facilities of the Pankrác House building, which include garage parking, a restaurant, a cafe, and conference rooms are at your disposal.

Location:

myhive Flexi Offices are easily accessible by car as well as public transportation – the building is **across the street from the Pražského povstání metro station (only 3 stops from Muzeum)**, close to the north-south arterial road (connected to the D1 highway) and several bus and tram stops. Complete civic amenities, Vyšehrad Park, and the popular Náplavka embankment are all within walking distance.

myhive Flexi Offices services:

- Daytime reception (from 8:30 a.m. to 6:30 p.m.)
- Fully equipped offices
- Receiving mail and packages
- Fully equipped conference rooms (leasable separately)
- Lounge for clients
- Phonebox
- Pop-up Office
- Coworking
- Furnished kitchenettes
- Smart printer
- High speed Wi-Fi
- IT support, legal advice

Equipment and building standards:

- Modern reception and lounge
- Underground parking
- Magnetic card access
- 24/7 security
- Restaurant, cafe, and conference room on the ground floor
- Multifunction control and safety equipment
- Raised floors
- Openable windows

**Office building**1 547 m², Prague 4, Nusle, Lomnického**€ 18.00 - 22.00 / m² | CZK 452 - 552 / m²**

Service price	298 CZK monthly per m ²
Total building area	1 547 m ²
Tenant consumption	—
Parking	120 EUR
Parking service charges	—
Parking ratio	—
Certification	—
PENB	A
Reference number	31499

Fitness room, dressing room, showers, bike storage
Warehouse space

myhive Flexi Offices price list including services:**Coworking:**

Hot desking CZK 300/day

Hot desking 24/7 CZK 4,500/month

Conference rooms:

From CZK 200/hr.

Available immediately.

Lease and service charges listed without VAT. Lessee pays no commission.

For more about **myhive Flexi Offices**, see www.myhiveflexi.cz/en.



Office building

€ 18.00 - 22.00 / m² | CZK 452 - 552 / m²1547 m², Prague 4, Nusle, Lomnického