



Apartment One-bedroom (2+1)

Sold

90 m², Semily, Harrachov





Apartment One-bedroom (2+1)

Sold90 m², Semily, Harrachov

Total area	103 m ²
Floor area*	90 m ²
Terrace	13 m ²
Parking	1 garage parking space
Garage	Yes
Cellar	Yes
PENB	B
Reference number	33242

This southwest-facing apartment on the ground floor with beautiful views is part of a new building in the **TRIO Harrachov** complex, which is located next to a forest just a few steps from the center of a popular resort. This vacation apartment can become not only a second home, but thanks to its suitability for renting out, it is also an interesting investment opportunity. Completion of the project is scheduled for December 2021.

The layout of the apartment will consist of a foyer, a hall, a spacious living room, a kitchen with a dining area, a bedroom with access to the terrace, and a bathroom (bathtub, sink, toilet).

The apartment is offered in a **finished state**, with a preparation for a kitchen and complete sanitary equipment. Features include **wooden flooring** (ceramic tiles in the bathroom), triple-glazed wooden windows with thermal and acoustic insulation, and security entrance doors. Heating will be provided by a central gas boiler. The unit comes with a **garage parking place** and a **cellar**, perfect for storing bicycles, skis, and other sports or children's equipment.

Harrachov is one of the most popular mountain resorts in the Krkonoše Mountains with a complete infrastructure and **excellent conditions for a wide range of sports activities throughout the year**. The complex is located by a creek and forest at the foot of Hřebínek Hill, **200 meters from a cable car and ski slopes**. Within walking distance (600 m) there is also a cable car station leading to the popular Devil's Mountain. Other easy-to-reach activities include **golf** (9-hole course with indoor simulator), a bobsleigh track, a rope center, a swimming pool, **an indoor pool**, or paragliding. The main promenade is close-by, but the complex is in a quiet location. There is a restaurant near the future complex, and others are in close proximity, as well as grocery stores, a post office, or ATMs. Among the town's attractions are the Mammoth jumping bridge, the glass or ski museum, or the beautiful **Mumlava Waterfalls**. From Prague, the town of Harrachov can be comfortably reached by car in two hours.

Total floor area 89.98 m², terraces 13.22 m², cellar.

For more information about the project visit the website www.trioharrachov.cz.

In addition to regular property viewings, we also offer **real time video viewings** via WhatsApp, FaceTime, Messenger, Skype, and other apps.

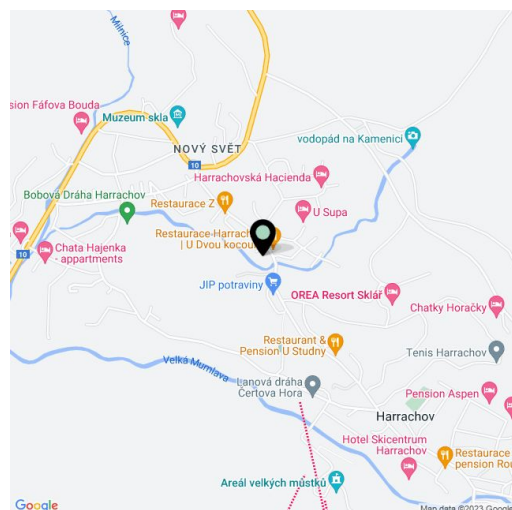

* Area of the unit according to the Civil Code. The area consists of the sum total area of the entire unit bounded by perimeter walls.



Apartment One-bedroom (2+1)

90 m², Semily, Harrachov

Sold

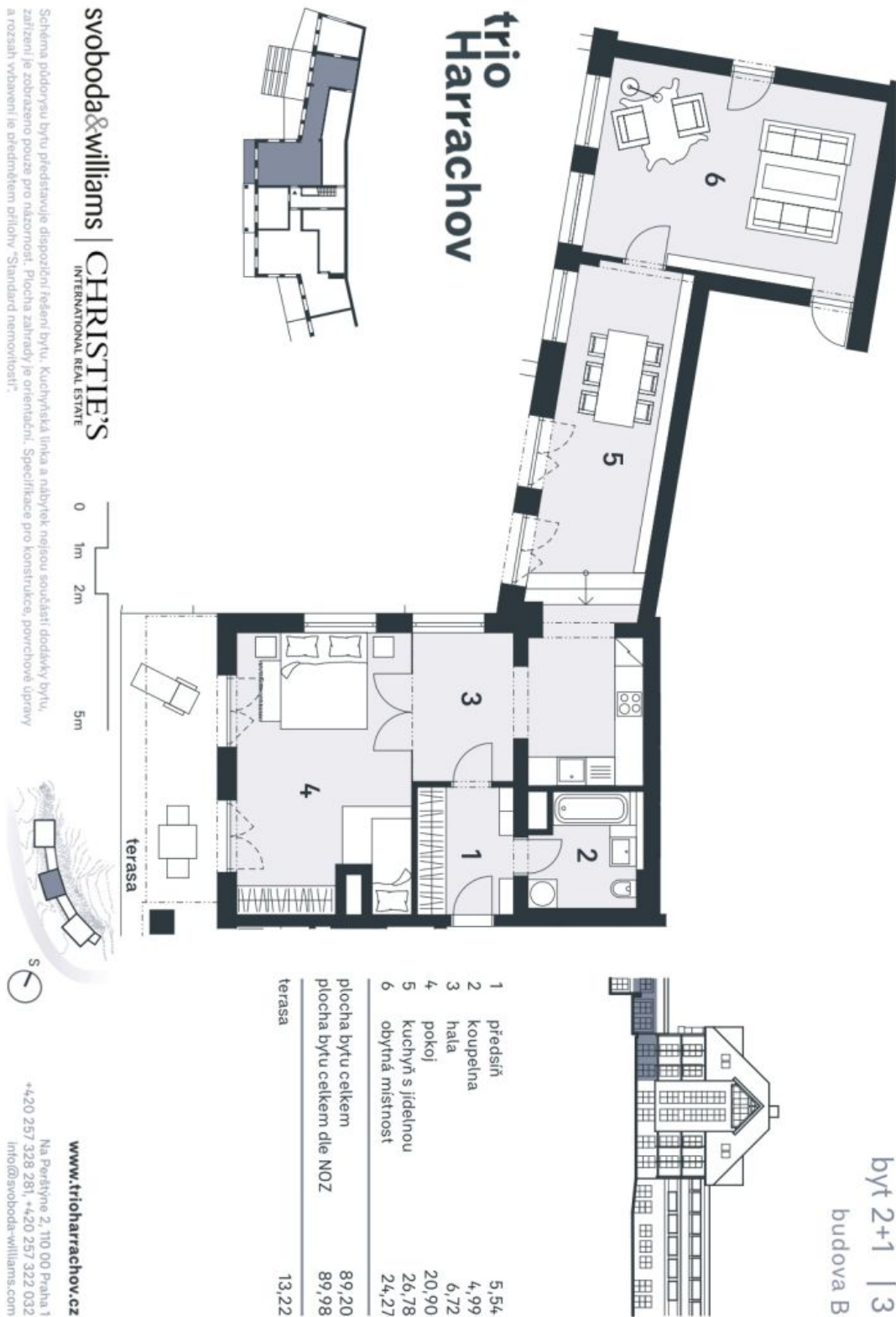

Schřma pŮdorysu bytu představuje dispozici řednř bytu. Kuchynřskř linka a nřbytel nejleř součástí dodřky bytu, zařizenř je zobrazeno pouze pro nřzornost. Plocha zařizenř je orientovřnř. Specifikace pro konstrukci, povrchovř uprřvy a rozsah vřbavrenř je uvedenřm pŮlichv "Standard nemovitostř".