



Apartment Two-bedroom (3+kk)

Ask for price

122 m², Prague 1, Staré Město, Dlouhá





Apartment Two-bedroom (3+kk)

Ask for price

122 m², Prague 1, Staré Město, Dlouhá

Total area	122 m ²
Parking	-
Cellar	Yes
PENB	G
Reference number	35032

A high standard of luxury living rivaling offers in other metropolises, a balcony overlooking Týn Cathedral, and a prestigious location. This air-conditioned apartment is situated in an apartment building in the heart of Old Town on Dlouhá Street, whose history dates back to the year 1310 and today is especially popular among lovers of good food and fashion.

A spacious living room (65 sq. m.) with an open plan kitchen and dining area provides a meeting place for family and friends. The relaxation area consists of 2 bedrooms, one with a south-facing balcony. Both bedrooms have a private bathroom; there is also a guest toilet accessible from the entrance hall.

Cozy interior with an impressive quality of carefully selected materials. The floors are oak (brushed oil) as well as the paneling; bathrooms are decorated with screed surfaces, large-format slim Del Conca Boutique Armani tiles and Alape, Duravit, Paffoni, Kaldewei, or Hüppe sanitary ware. The kitchen is equipped with built-in Bora and AEG appliances and worktop and Brac limestone tiles. The furniture is custom-made or selected in the Konsepti showroom, decorated with handcrafted Baccman & Berglund handles. Designer light fixtures are by the Moooi, Foscarini, and Modular brands. The Toshiba air-conditioning system ensures an optimum temperature even on hot days.

The historic building is located near the U Salvátora Evangelical Church, the Catholic Church of the Holy Spirit, and the Spanish Synagogue, near Old Town Square and Pařížská Avenue. The surrounding area offers a wide variety of restaurants of all possible cuisines, shops, including boutiques of world-renowned and Czech brands, as well as schools of all levels or medical services. The location is easily accessible by metro and tram. The nearby Za Svatyněmi Garden close to the St. Agnes Convent provides green spaces for relaxation.

Interior 122.1 m², cellar.

In addition to regular property viewings, we also offer real-time video viewings via WhatsApp, FaceTime, Messenger, Skype, and other apps.

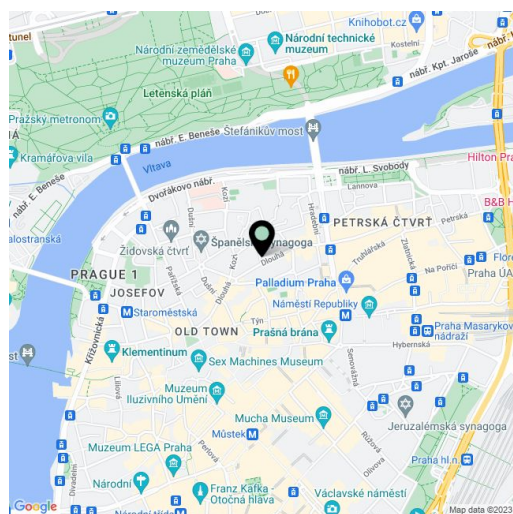

* Area of the unit according to the Civil Code. The area consists of the sum total area of the entire unit bounded by perimeter walls.



Apartment Two-bedroom (3+kk)

Ask for price

122 m², Prague 1, Staré Město, Dlouhá

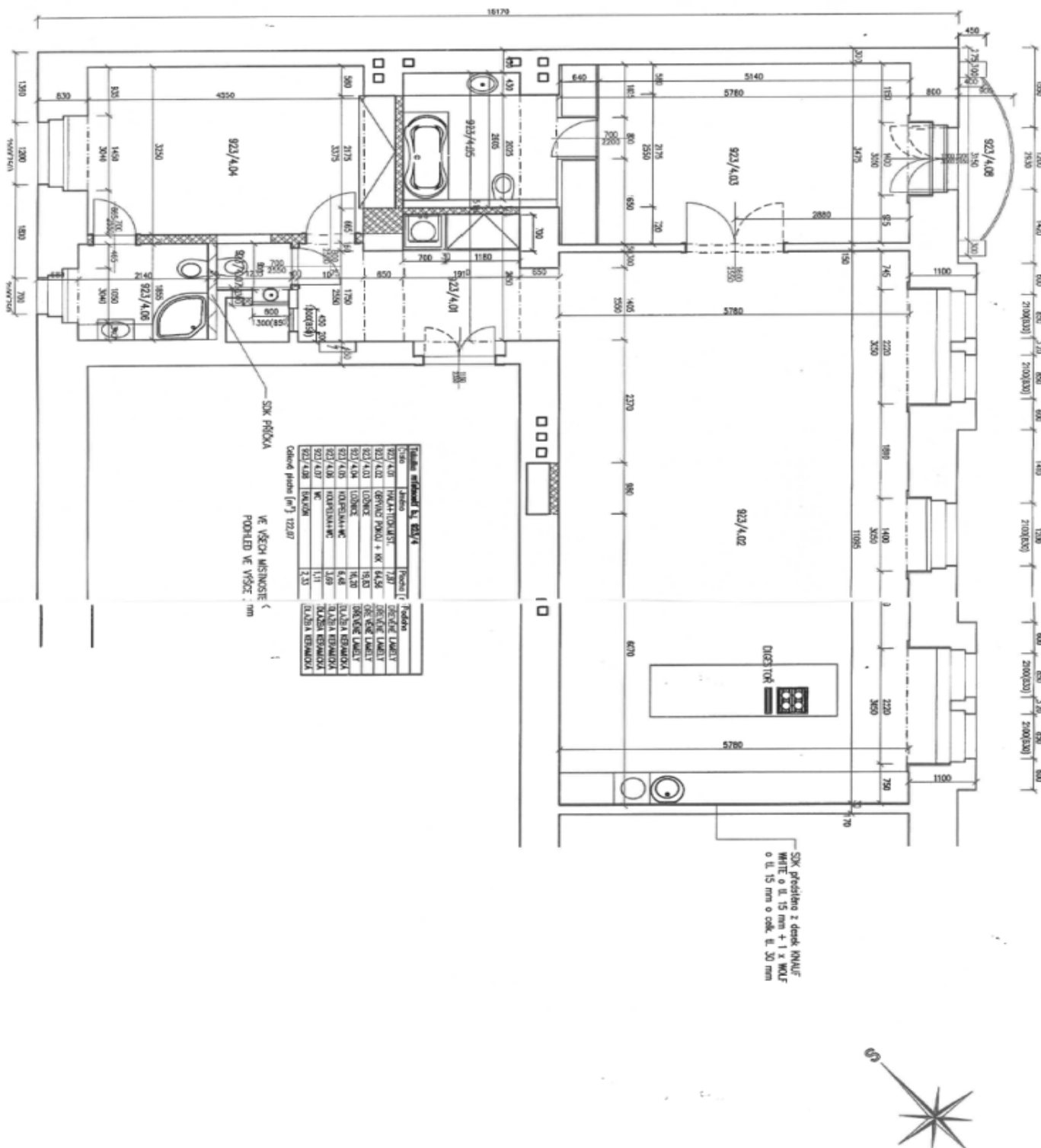

Tabulka umístění št. 923/4

Číslo	Área	Prostředí	Podoba
923/4.01	PROSTŘEDÍ	2,07	OKRÉSL. LAMELY
923/4.02	OBÝVACÍ	24,56	OKRÉSL. LAMELY
923/4.03	LOŽNICE	18,82	OKRÉSL. LAMELY
923/4.04	LOŽNICE	18,82	OKRÉSL. LAMELY
923/4.05	KUPELNA+WC	6,46	OKRÉSL. LAMELY
923/4.06	KUCHYŇ	1,69	OKRÉSL. LAMELY
923/4.07	WC	1,11	OKRÉSL. LAMELY
923/4.08	OBÝVACÍ	2,33	OKRÉSL. LAMELY
923/4.09	OKRÉSL. LAMELY		OKRÉSL. LAMELY

Číslo místnosti (m²) 122,07

VE VŠECH MÍSTNOSTECH
PODLEHÁ VE VÝŠCE: mm

SKV předstěna z desek (KNAUF)
WHITE o tl. 15 mm + 1 x KNAUF
o tl. 15 mm o celk. tl. 30 mm

