

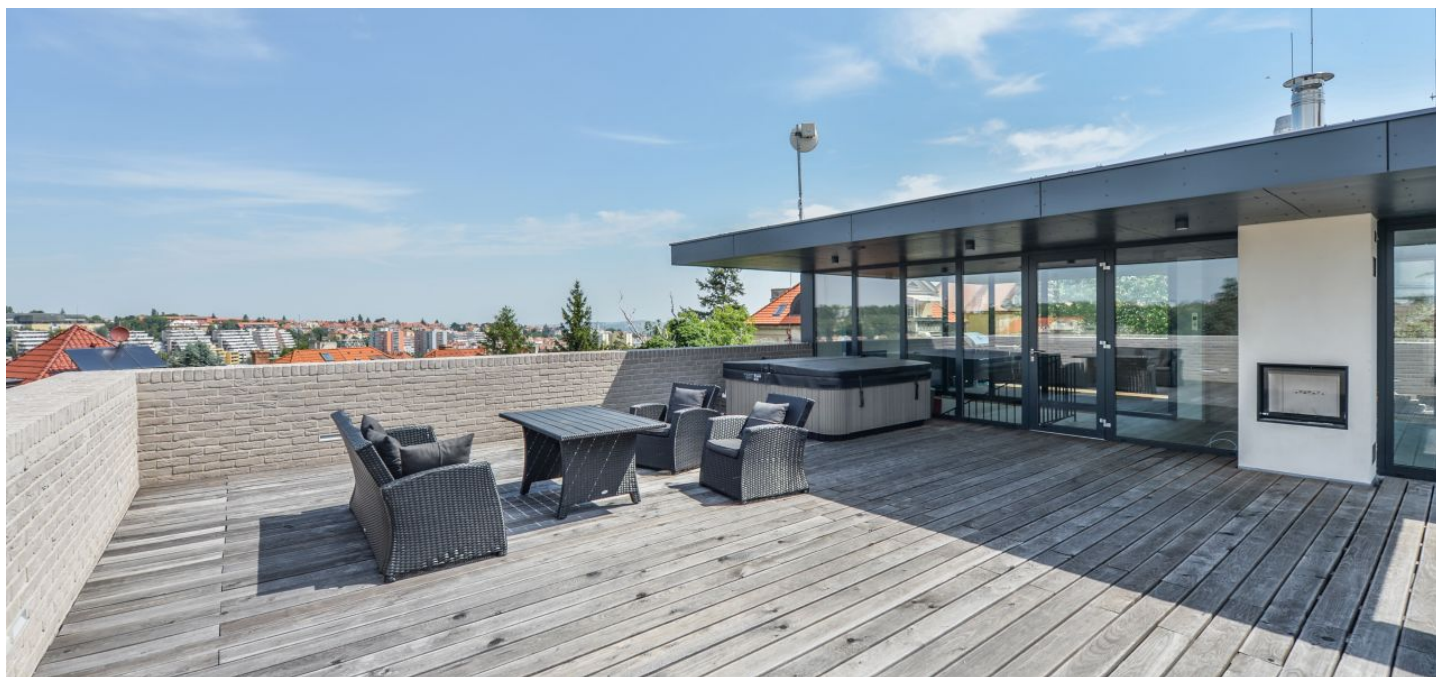

House Four-bedroom (5+1)

Rented

636 m², Prague 6, Břevnov, Dvořeckého





House Four-bedroom (5+1)

Rented636 m², Prague 6, Břevnov, Dvořeckého

Total area	636 m ²
Plot	638 m ²
Foot print	307 m ²
Garden	331 m ²
Floor area	531 m ²
Terrace	105 m ²
Parking	Double garage and two covered spaces on the plot.
Garage	Yes
Cellar	Yes
PENB	G
Reference number	35579
Available from	Immediately

This contemporary 4-bedroom 3-bathroom freestanding home (2016) boasts high quality equipment, an elevator, air-conditioning, a swimming pool, a wine cellar, and a rooftop terrace with a jacuzzi ideal for sunset-watching. Situated on a quiet one-way street in a green residential neighborhood in Břevnov, Prague 6, near the Břevnov Monastery. Located in close vicinity of the Prague Castle, the Ladronka and Hvězda Parks, with full amenities within easy reach and quick access to the city center, the airport, and international schools. The city center can be reached by tram in 20 minutes, and the bus ride to the Petřiny metro station (line A) takes eight minutes.

The ground floor of the house features a **100 sq. m. open space** including a living room and a separate fully fitted kitchen and dining area, plus an adjacent **garden** created on the roof of the carport. There is a large entrance hall, a **walk-in closet**, and a toilet. The first floor offers a bedroom with an en-suite bathroom, two further bedrooms, a family bathroom, and a staircase gallery with an **elevator**. The second floor includes a bedroom, a bathroom, and **two rooftop terraces**. The basement floor consists of a double garage, a wine cellar, storage space, and a utility room.

High quality equipment, **air-conditioning**, **hardwood floors**, large-format tiles, floor-to-ceiling aluminum windows with external blinds, storage, **fireplace**, laundry chute, gas boiler. **Double garage** and **two covered parking spaces** on the plot. Utilities are billed separately. Available from July 2020.

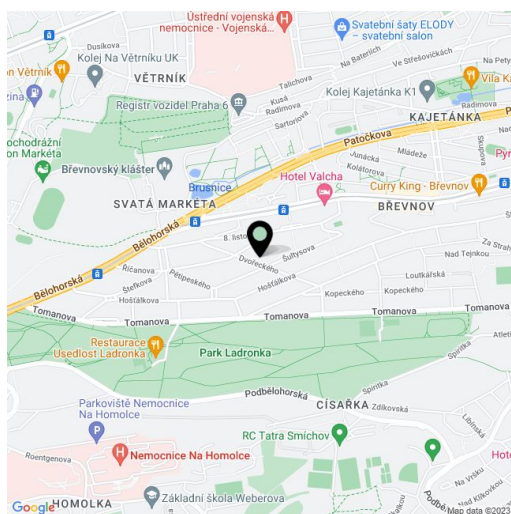



House Four-bedroom (5+1)

Rented

636 m², Prague 6, Břevnov, Dvořeckého

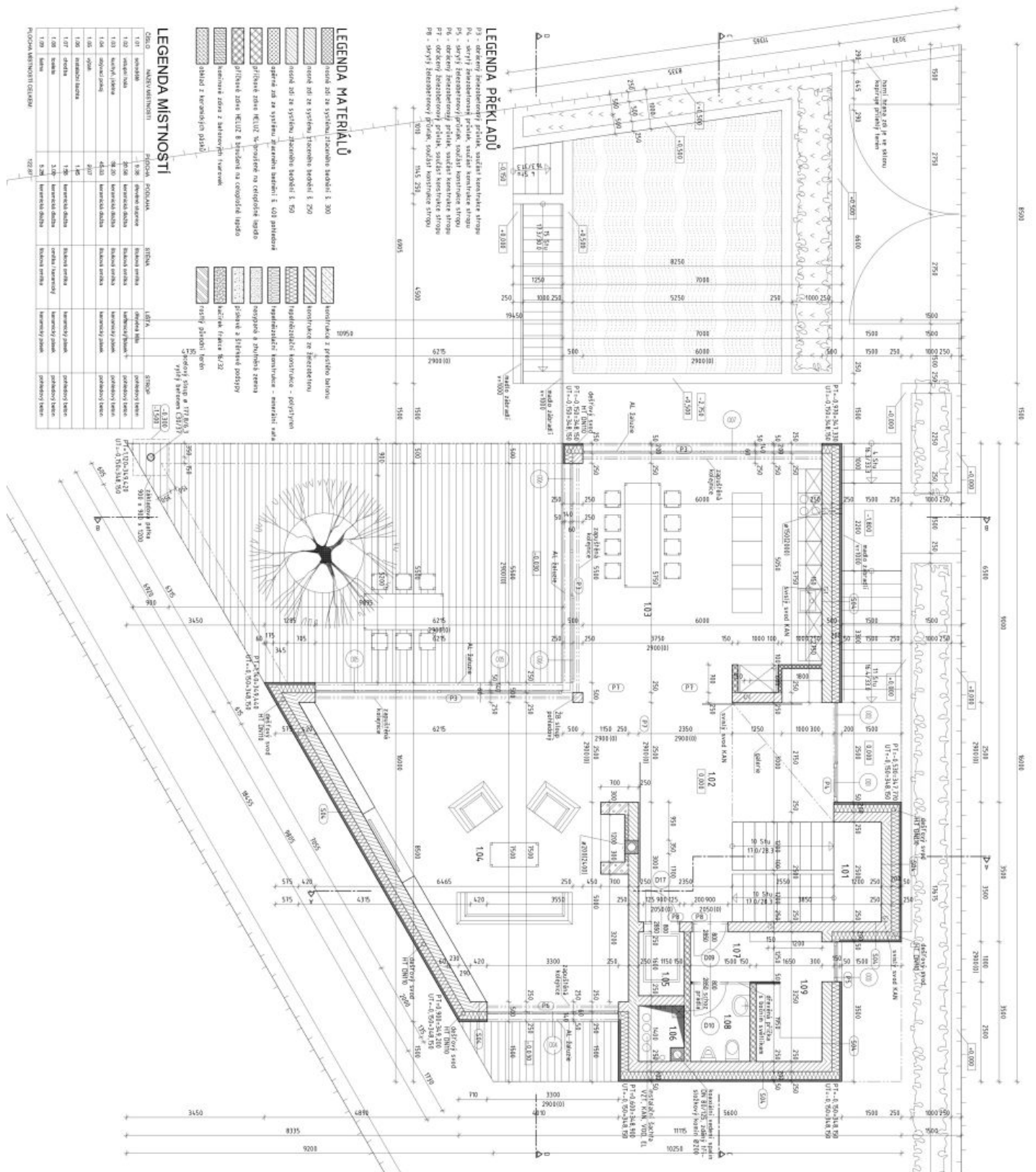



House Four-bedroom (5+1)

636 m², Prague 6, Břevnov, Dvořeckého

Rented

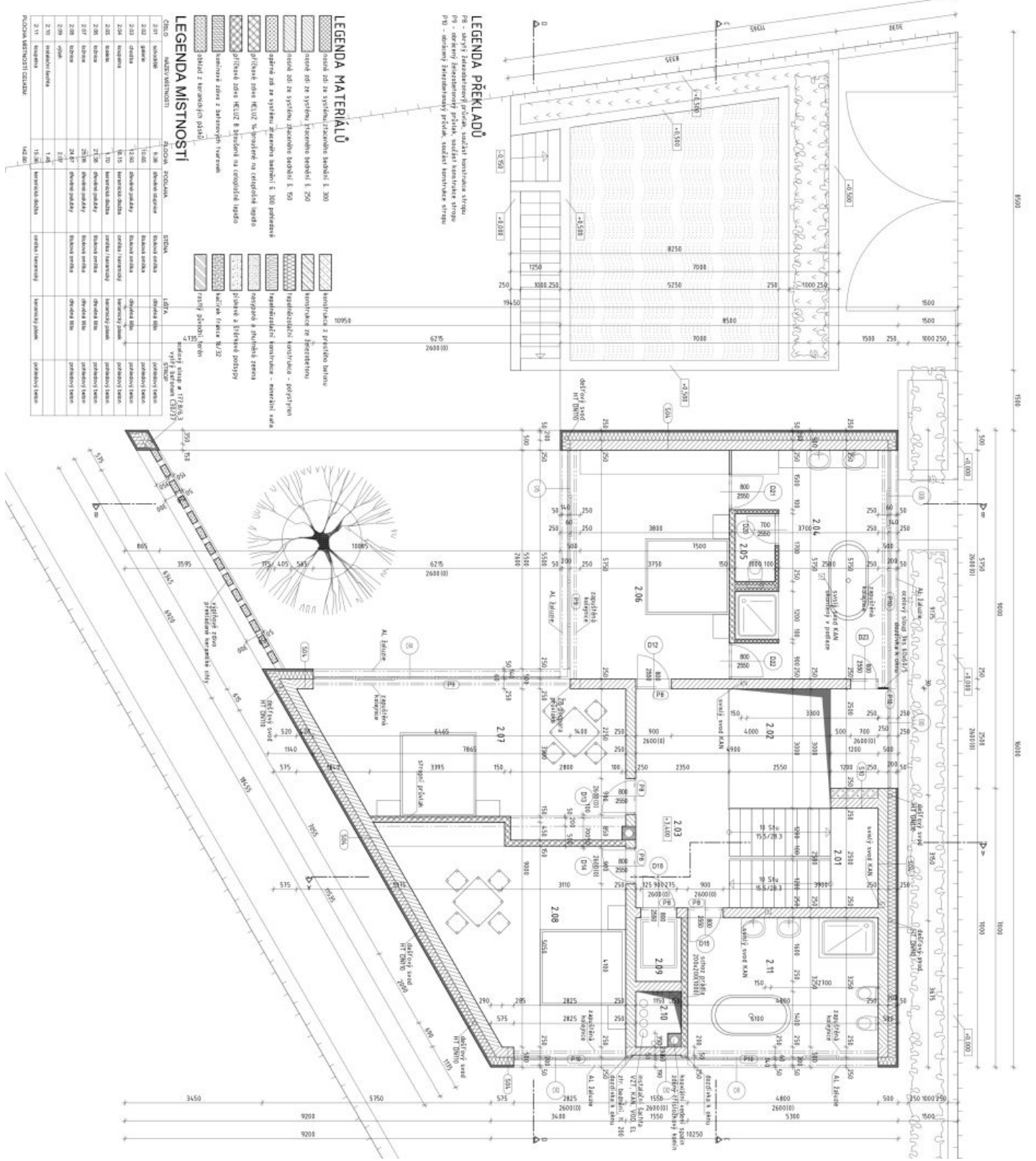



House Four-bedroom (5+1)

636 m², Prague 6, Břevnov, Dvořeckého

Rented

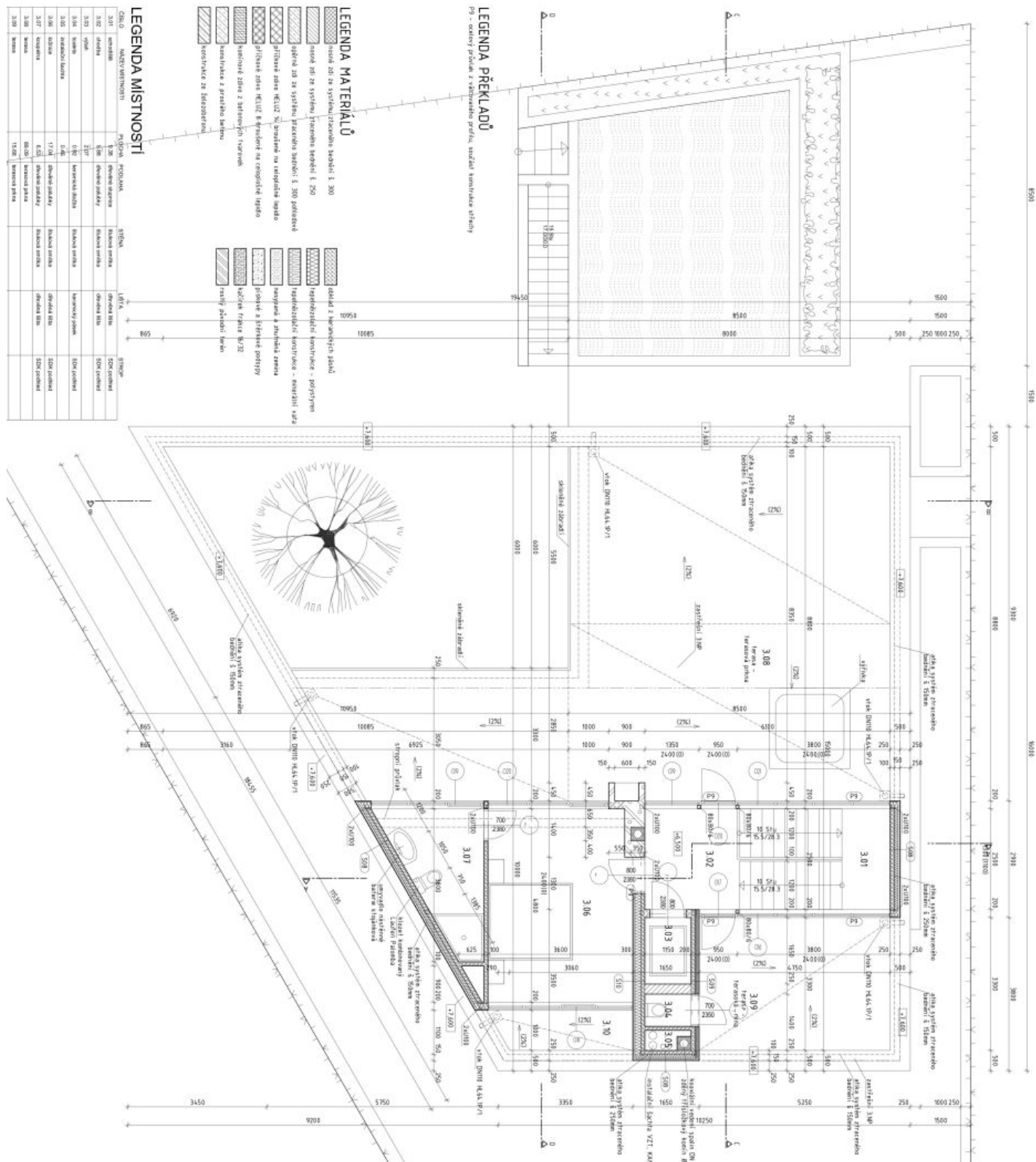



House Four-bedroom (5+1)

Rented

636 m², Prague 6, Břevnov, Dvořeckého

