



Industrial space

2 449 m², Prague 5, Zličín, Na Radosti

Ask for price





Industrial space

2 449 m², Prague 5, Zličín, Na Radosti

Ask for price

Total area	2 449 m ²
Available area for rent	2 449 m ²
Ceiling height	8 m
Floor loading capacity	—
Column grid structure	—
Structure	Reinforced concrete structure
PENB	B
Reference number	36785

1,635 sq.m. of industrial and **814 sq.m.** of office premises for lease in a Business Park situated in Prague 5. The project consists of 5 warehouse, industrial and office buildings; there are 2 entrances with the gatehouse.

Location:

Project is located 450m from Exit "na Radosti" – direct connection to Prague Ring Road (R1) and D5 highway to Germany. Excellent access to the airport Prague Václav Havel Airport – cca 5km (10 minutes by car). Zličín Business Centre (line B) and Metropole Zličín shopping mall is 550 m from areal.

Features and Services:

- Flexible units (Storage / Office / Light Production / Showroom)
- On-site property management
- 24/7 manned security and CCTV
- Park maintenance

Office:

- Turn key office
- Lighting 500 Lux
- Air Conditioning

Industrial premises/ Warehouse:

- 2 loading docks per 600 sq.m
- Building depth 55 m
- Shuttle bus to metro
- Lighting 200 Lux
- Clear hight 8 m

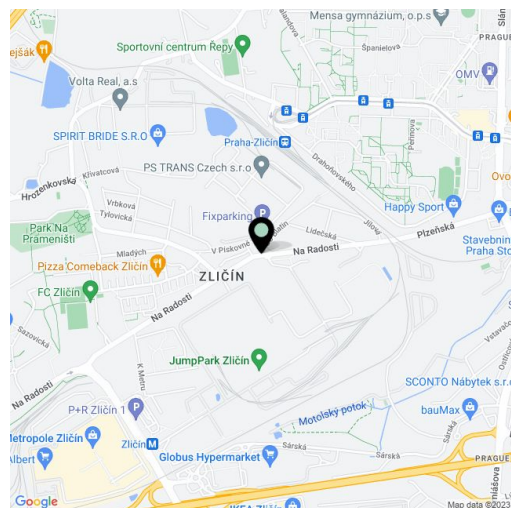

Rental and service charges listed without VAT. Lessee pays no commission.



Industrial space

Ask for price

2 449 m², Prague 5, Zličín, Na Radosti

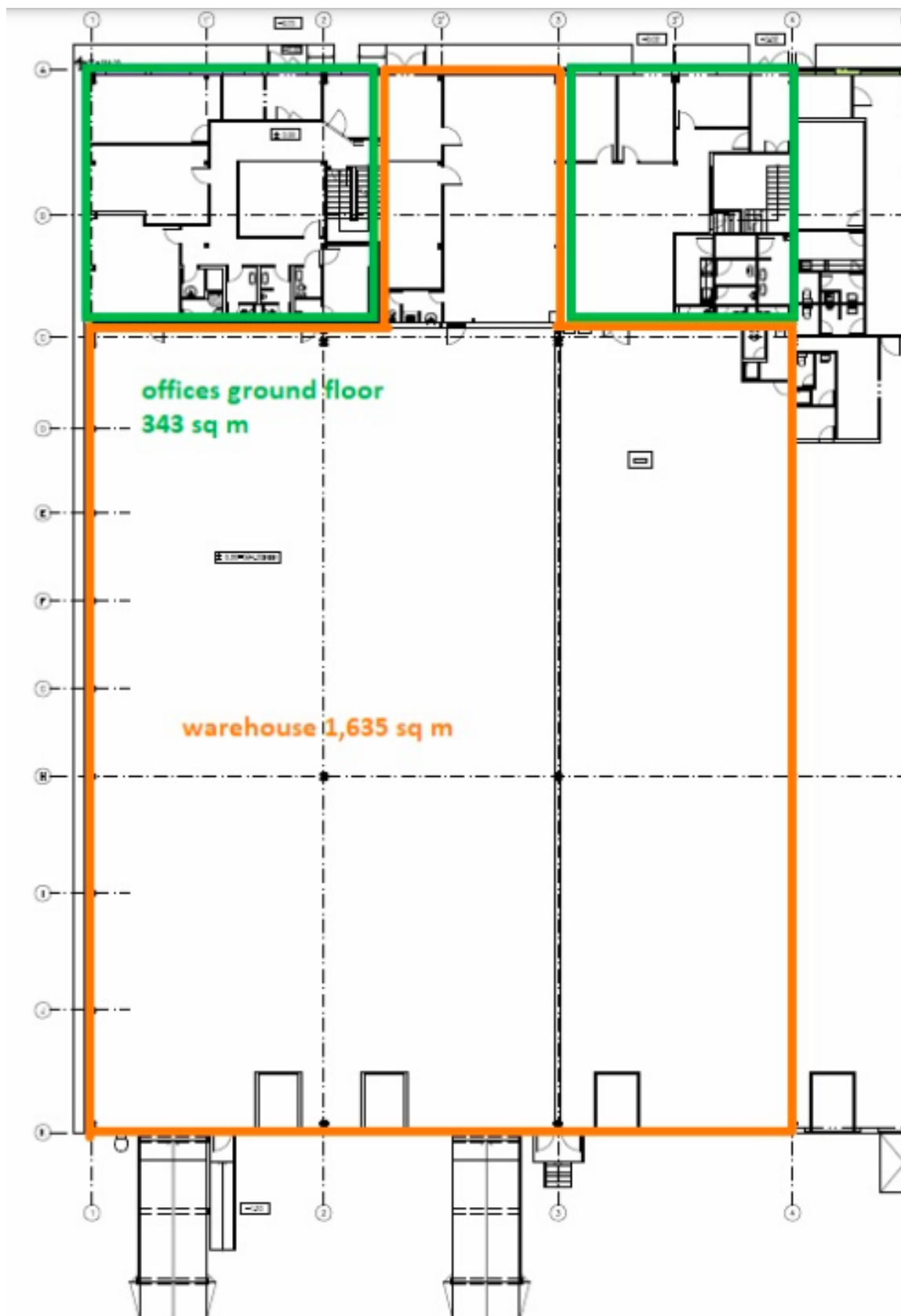



Industrial space

2 449 m², Prague 5, Zličín, Na Radosti

Ask for price

