

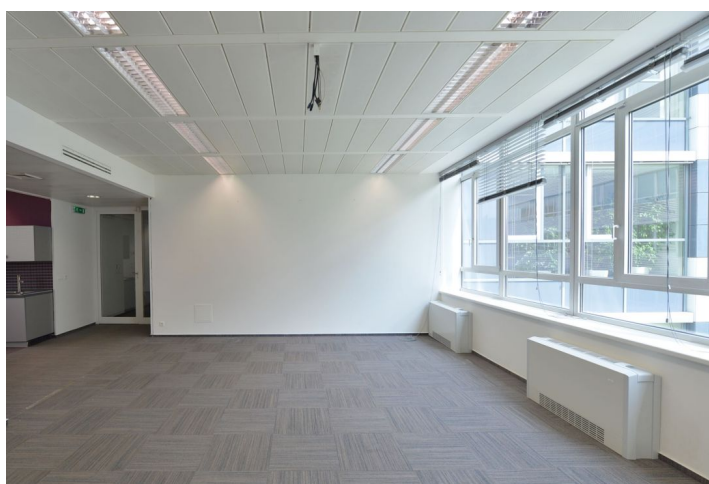

Office space

Prague 6, Dejvice, Evropská

Rented

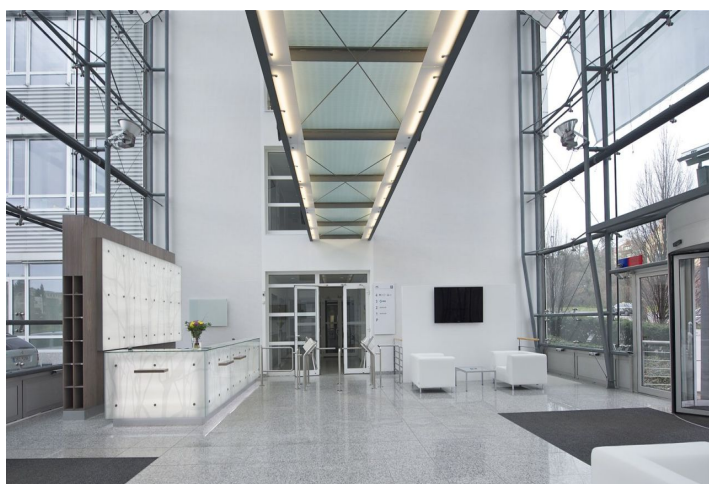
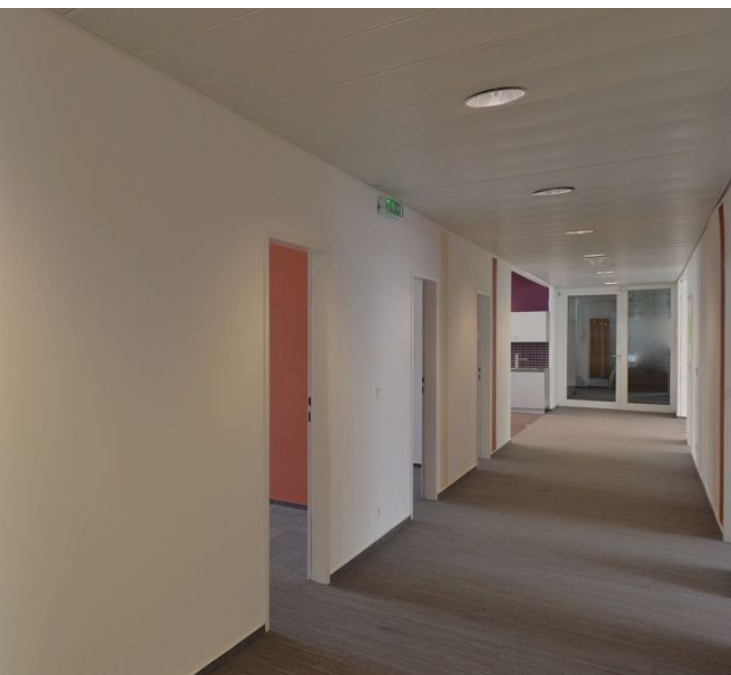



Office space

Rented

Prague 6, Dejvice, Evropská

Service price	160 CZK monthly per m ²
Available area	1 033 m ²
Cellar	-
Terrace	466 m ²
Parking	EUR 90 / ps / month
PENB	G
Reference number	37670

Office space for lease on the 3rd floor in an administrative complex. The building is located near a major summer house and offers a range of services, such as a restaurant, cafe and fitness. The space also has a private terrace (212 sq. m).

Location:

The complex is located on Evropská Street in Prague 6 and is very easy accessible by car and public transport – the Dejvická metro station (line A) is only two tram stops away. There is a tram stop directly outside the building. Easy access to Vaclav Havel Airport Prague and to the city center.

Features and services:

- Air conditioning
- Openable windows
- Raised floors/floor boxes
- Suspended ceilings
- Kitchenette and toilets
- Main reception lobby with a coffee shop
- 24-hour security/CCTV
- Full-time on-site property management team
- Restaurant
- Common garden terrace adjacent to food services
- Full-service fitness center (sauna, personal training, group exercise classes, corporate challenge programs)
- Underground parking and parking for visitors

Available from 1st May, 2025.

Rental and service charges listed without VAT. Lessee pays no commission.

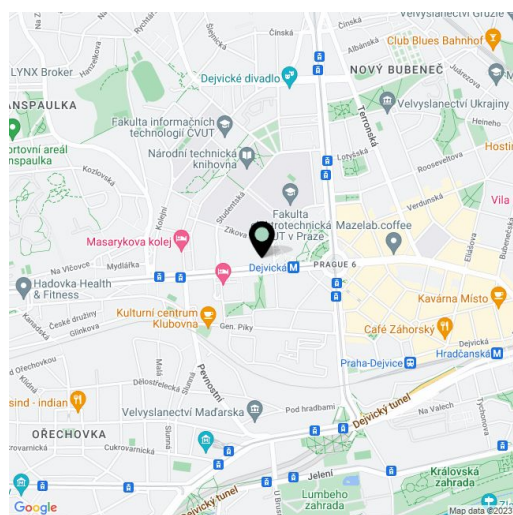



Office space

Prague 6, Dejvice, Evropská

Rented

