

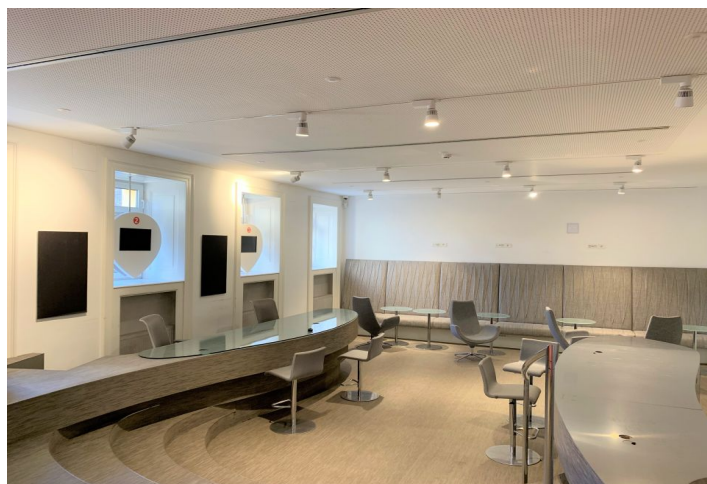

Office space

Praha 4, Nusle, Závěšova

€ 9.86 - 11.44 / m² | CZK 250 - 290 / m²



**Office space**

Praha 4, Nusle, Závašova

€ 9.86 - 11.44 / m² | CZK 250 - 290 / m²

Service price	183 CZK monthly per m ²
Available area	526 m ²
Cellar	-
Parking	CZK 1352 / pp / month
PENB	G
Reference number	38679

Office space for lease on the 1st floor in the complex of office buildings. It consists of 3 interconnected buildings and one detached. Offices can be used as open space or individual offices. Outdoor parking is also available.

Location:

The building is located a few minutes from the tram stop Divadlo Na Fidlovačce and 10 minutes walk from the metro station Vyšehrad (line C), which takes you to the city center within 4 minutes.

Features and Services:

- Cooling
- Computer/Network cabling
- Power cabling
- Smoke detectors
- Fibre optics
- Openable windows
- Heating
- Mechanical ventilation

Rental and service charges listed without VAT. Lessee pays no commission.

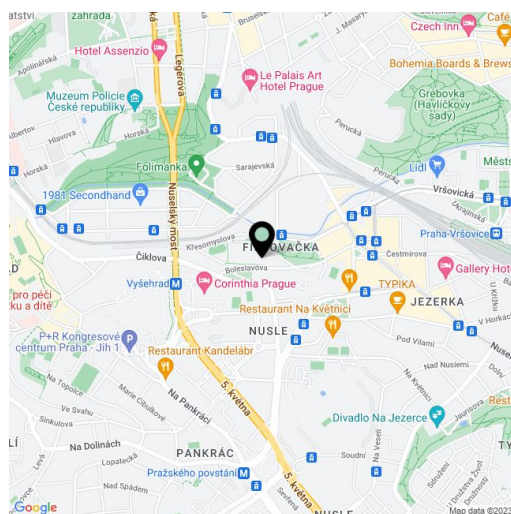

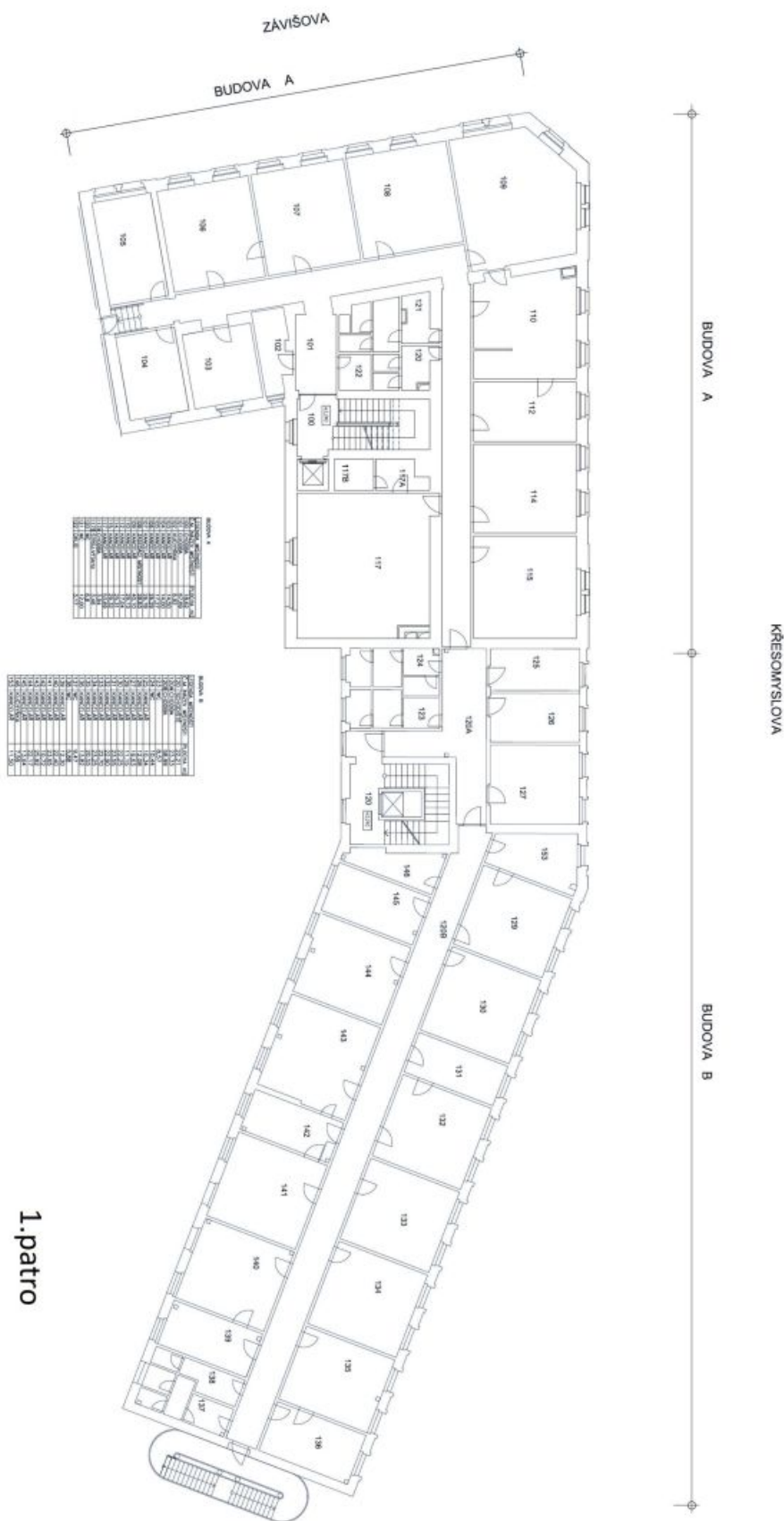

1. patro