



Warehouse space

7 139 m², Benešov, Ostředek, Ostředek

Ask for price





Warehouse space

7 139 m², Benešov, Ostředek, Ostředek

Ask for price

Total area	7 139 m ²
Min. area	3 470 m ²
Ceiling height	10 m
Floor loading capacity	5 t/m ²
Column grid structure	—
Structure	Reinforced concrete structure
PENB	B
Reference number	40460

7,139 sg.m. of warehouse and office space for rent. The premises are suitable for distribution, logistics or light manufacturing.

Location:

The park is located at exit 34, near the towns of Sázava and Ostředek and is well visible and accessible for both heavy vehicles and visitors. It also benefits from the local labor market in the area southeast of Prague.

Industrial/Warehouse space:

- Column grid structure: 12 x 24 m
- Clear height 10 m
- Floor loading capacity 5 T/sq.m
- Space for loading 1/800 m²
- Sprinklers
- Roof illumination: 2%
- Heating: min. 12 ° C

Office:

- Office space according to the client's requirements

Available from September, 2022.

Lessee pays no commission.

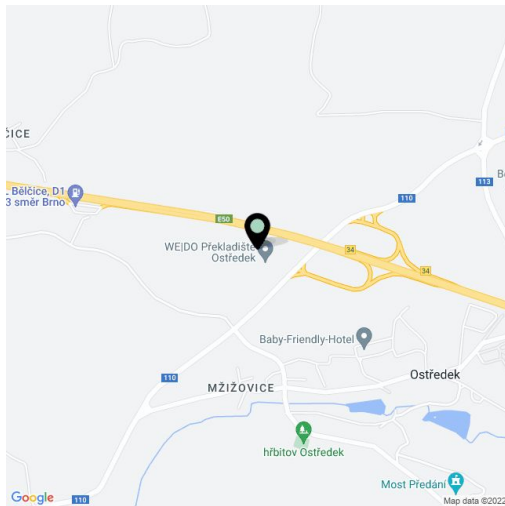



Warehouse space

7 139 m², Benešov, Ostředek, Ostředek

Ask for price





Warehouse space

Ask for price

7 139 m², Benešov, Ostředek, Ostředek

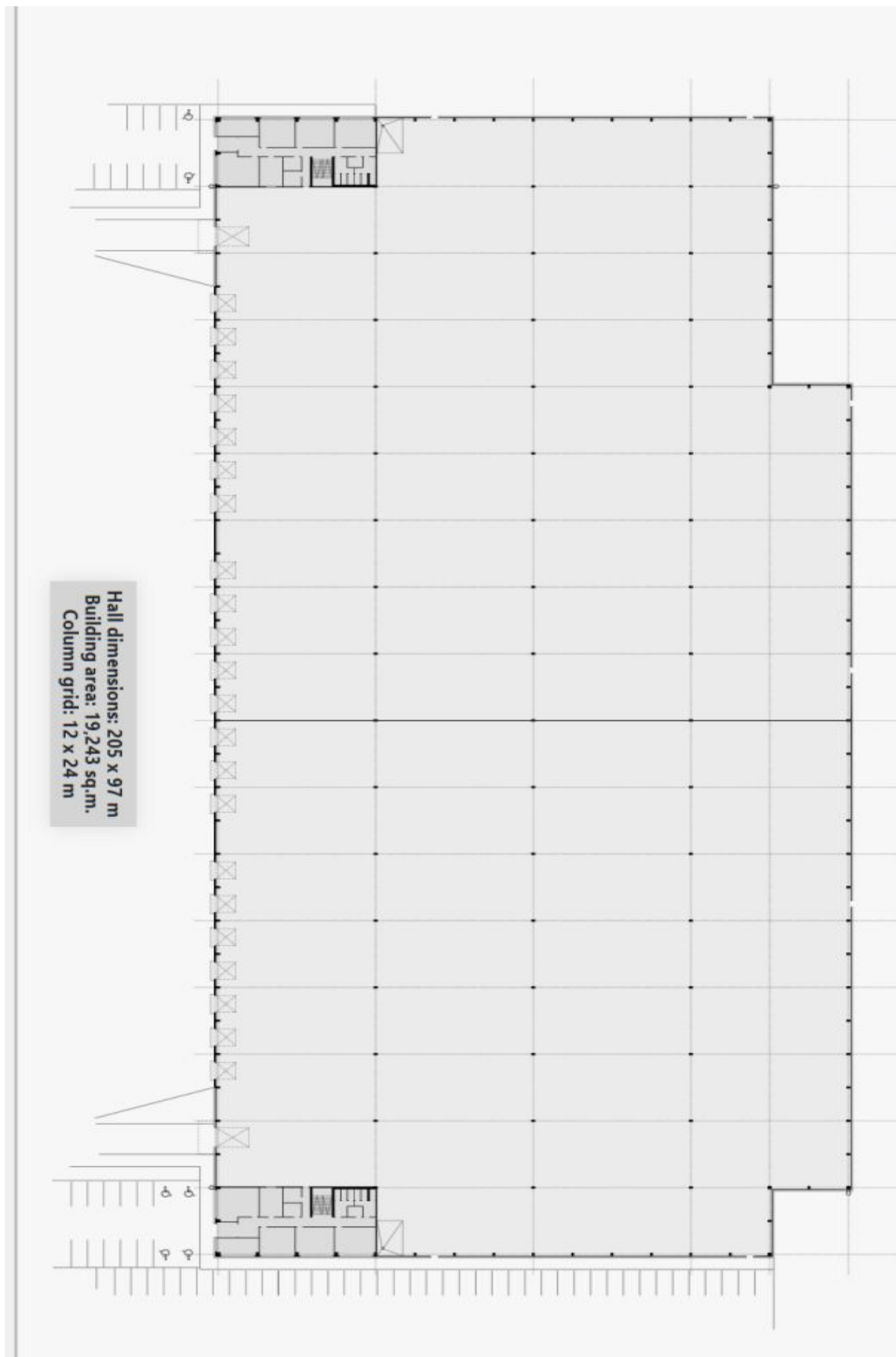



Warehouse space

7 139 m², Benešov, Ostředek, Ostředek

Ask for price

