



Apartment Two-bedroom (3+kk)

€ 327 408 | CZK 7 807 040

84 m², Ostrava, Moravská Ostrava, Masarykovo náměstí





Apartment Two-bedroom (3+kk)

€ 327 408 | CZK 7 807 040

84 m², Ostrava, Moravská Ostrava, Masarykovo náměstí

Total area	94 m ²
Floor area	84 m ²
Loggia	10 m ²
Parking	Parking space at extra cost
Cellar	Yes
PENB	B
Reference number	41826

This bright apartment with a loggia and the possibility of purchasing a garage parking space is part of the unique **Nové Lauby** residential complex. This new project is being created right in the center of Ostrava near Masaryk Square with a fountain, within walking distance of a full range of services and a park. The estimated completion date is Q4 2023.

The layout consists of a living room with a preparation for a kitchen, two bedrooms, a bathroom with a toilet, a separate guest toilet, and an entrance hall. The apartment has a loggia.

The project was designed by the renowned **Znamení čtyř - architekti studio**. The new five-story building will be covered with **greenery**, and a **landscaped atrium** will be created in the complex's center. The interior is illuminated by large-format windows with aluminum or wooden frames and the standard of equipment is offered in two options. There is a possibility to buy a **parking space**.

The apartment complex will become a natural part of the historic center of Ostrava. In the area around Masaryk Square, you can enjoy cafes, restaurants, a shopping center, a museum, a cinema, or a library. Schools and the Antonín Dvořák Theater are a few minutes' walk away. Part of the city monument zone is the **large park** on **Černá Louka** and the Ostravice River is lined with **bike paths**.

Floor area 84.11 m², loggia 10.10 m², cellar 2.53 m². The visualizations are of an illustrative nature only.

For more information about the project, visit the website

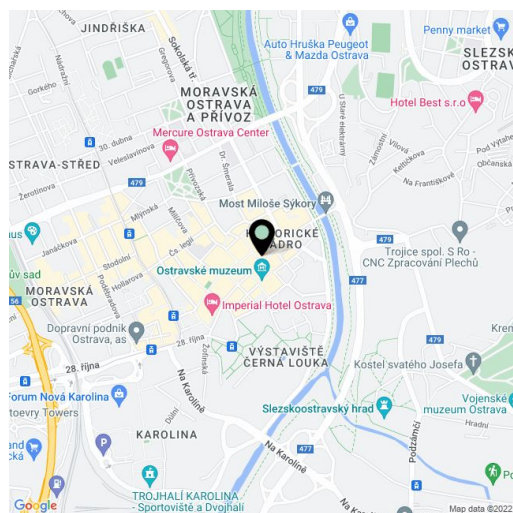



Apartment Two-bedroom (3+kk)

€ 327 408 | CZK 7 807 040

84 m², Ostrava, Moravská Ostrava, Masarykovo náměstí

Nové Lauby

Byt 3.E.01

Dispozice	3+kk	
Podlaží	3.Np	
Vstup z ulice	Dlouhá	
1	Hala	15,17 m ²
2	Pokoj	11,39 m ²
3	Pokoj	13,43 m ²
4	Koupelna s WC	5,10 m ²
5	WC	1,93 m ²
6	Obýv.pokoj s kuch.koutkem	31,09 m ²
Užitná plocha		78,11 m ²
Podlahová plocha		84,11 m ²
Lodžie		10,10 m ²

Exkluzivní zastoupení
svoboda&williams | CHRISTIE'S
INTERNATIONAL REAL ESTATE



Projekt Nové Lauby je výhradně podrobo no změny. Všechny rozklady a reference jsou pouze orientační. Součástí projektu není
něbýlek. Celková plocha bytu je včetně předst. a vnitřních rozptylů ulice de vodorovně měřena 84,11 m² (2013) 84,11 m².

0 1m 2m 5m

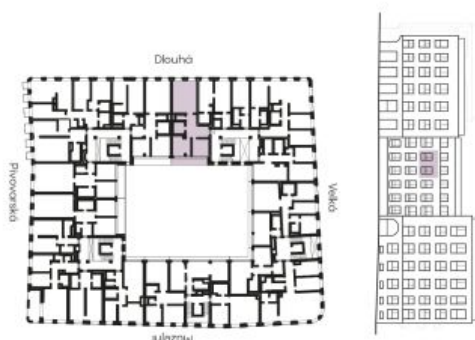

www.novelaubu.cz

info@novelauby.cz
+420 724 551 238