



Industrial space

2 189 m², Plzeň-sever, Vejprnice, Tyršova

Ask for price





Industrial space

2 189 m², Plzeň-sever, Vejprnice, Tyršova

Ask for price

Total area	2 189 m ²
Ceiling height	10 m
Floor loading capacity	6 t/m ²
Column grid structure	—
Structure	Reinforced concrete structure
PENB	C
Reference number	41917

2,063 sq.m. of industrial and **126 sq.m.** of office premises for lease in the industrial park situated in the west of Plzen city. Premises are suitable for light production.

Location:

The project is situated 9 km from Plzen City Centre, 4 km from Borska pole shopping and industrial zone, and 3 km from the D5 highway, 90 km from Prague. Location is accessible by car and by public transport (bus, train).

Features and Services:

- Flexible units from 500 sq.m (Storage / Office / Light Production / Showroom)
- On-site property management
- 24/7 manned security and CCTV
- Park maintenance

Warehouse/Industrial premises:

- 2 loading docks per 549 sq.m
- ESRF sprinkler systém
- Column grid 22 x 12m
- 2 x direct drive
- 8 x loading docks for trucks
- Floor loading capacity 6 T/sq.m
- Loading dock size 3.5 x 4.2 m (w x h)
- Clear hight 10 m
- Lighting 200 Lux

Office:

- Tailor made office ready to move in
- Clear hight 3m
- Aluminium windows
- Standard includes ventilation, electro-installation and sanitary rooms
- Lighting 500 Lux
- Floor surface – carpet or PVC
- Possibility to built 2 storey offices

Available from March, 2023.

Rental and service charges listed without VAT. Lessee pays no commission.

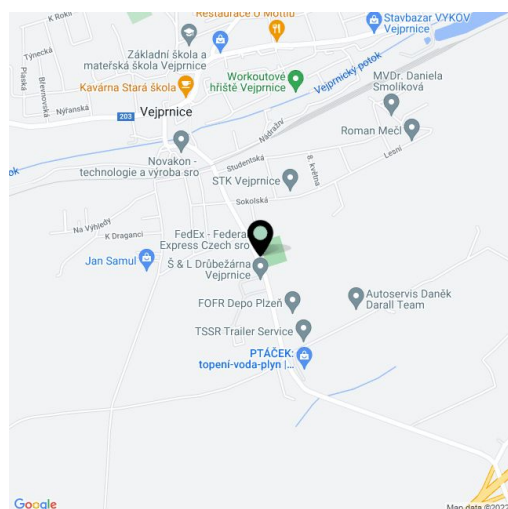



Industrial space

Ask for price

2 189 m², Plzeň-sever, Vejprnice, Tyršova

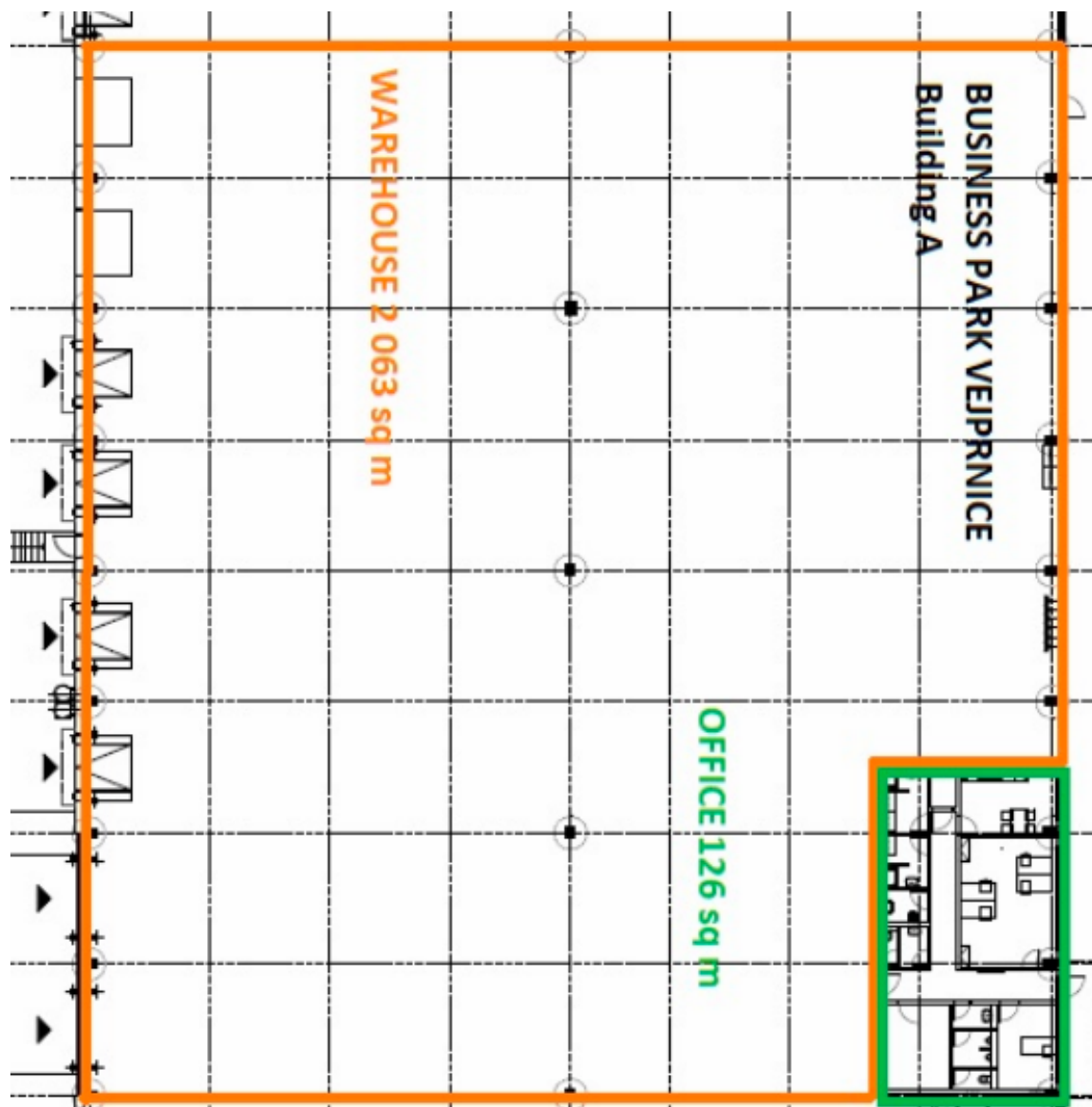



Industrial space

2 189 m², Plzeň-sever, Vejprnice, Tyršova

Ask for price



16 000 m²
16 000 sq.m.



7 000 m²
7 000 sq.m.

SITUAČNÍ MAPA