

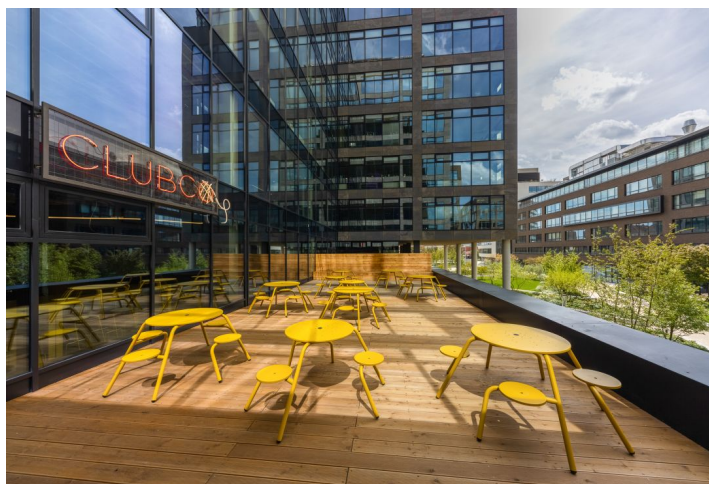

## Retail space

Brno-město, Brno - střed, Přízova

Rented

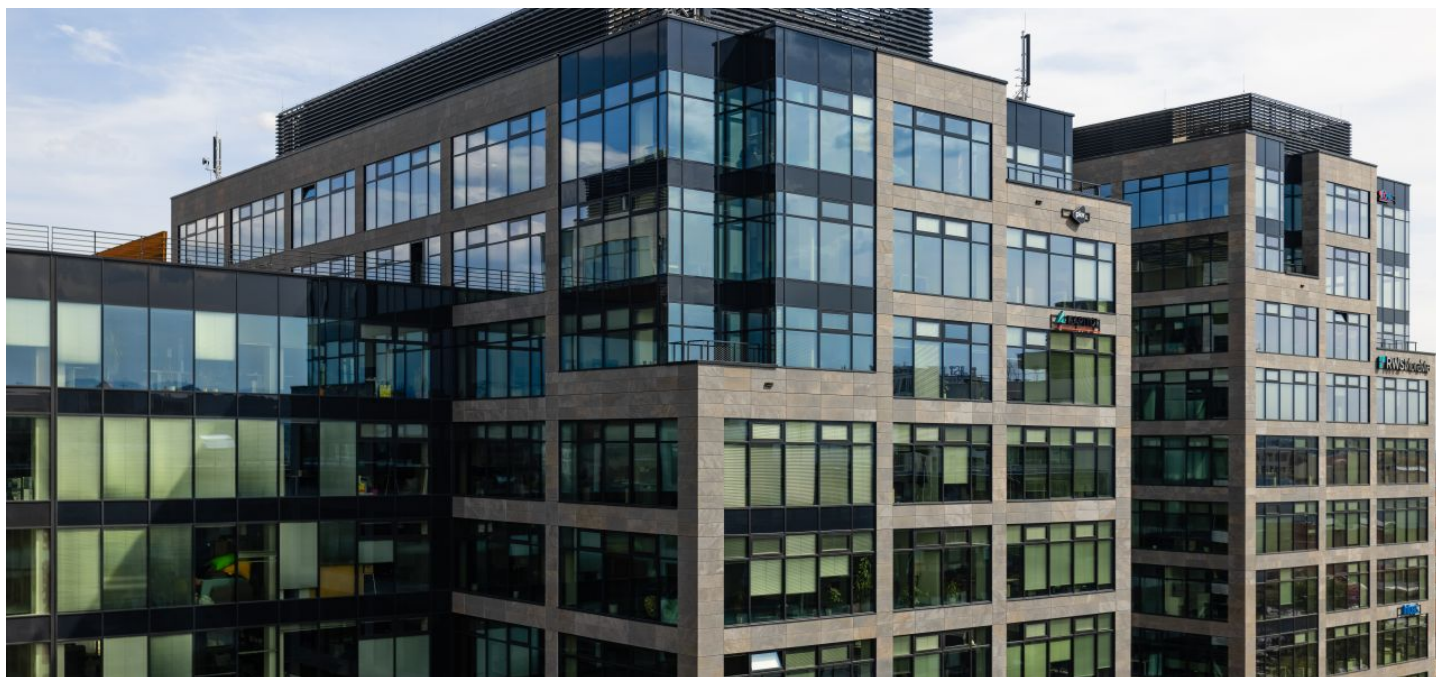

**Retail space****Rented**

Brno-město, Brno - střed, Přízova

|                         |                                  |
|-------------------------|----------------------------------|
| <b>Service price</b>    | 4 EUR monthly per m <sup>2</sup> |
| <b>Available area</b>   | 510 m <sup>2</sup>               |
| <b>Parking</b>          | Yes                              |
| <b>PENB</b>             | A                                |
| <b>Reference number</b> | 43341                            |

Retail space for lease on the ground floor in an administrative complex which is consisting of 9 office buildings built by BREEAM standards provides residents besides modern offices also relaxing park with a lake. Shell & Core.

**Location:**

The great advantage of the project is the perfect public transport connection, the main bus and train station within walking distance and easy connection to the Brno ring road and the motorway network. The city center of Brno and the Vaňkovka shopping gallery, which are close by, guarantee the tenants all the civic amenities and services.

Rental and service charges listed without VAT. Lessee pays no commission.

